



MONOSLOPE ROOF SUNROOM SYSTEM

MASTER PLAN

NON-IMPACT, NON-HABITABLE SPACE

COPIES NOT VALID FOR PERMIT

COPIES NOT VALID FOR PERMIT

PE SEAL
REQUIRED

03/12/2021

CERTIFYING ENGINEER AND CERT
OF AUTH AS LISTED ON STAMP

VALID FOR 1 PERMIT ONLY UNO

DIGITAL SEAL NOTICE:
IF THIS DOCUMENT IS DIGITALLY
SIGNED, THIS SHEET IS PART OF A
DIGITALLY SIGNED FILE. IT SHALL
REMAIN IN DIGITAL FORMAT, SHALL
BE VERIFIED BY ELECTRONIC MEANS,
& PRINTED COPIES OF THIS
DOCUMENT ARE NOT CONSIDERED
SIGNED AND SEALED.

PRINTED DOCUMENT NOTICE:
IF THIS DOCUMENT IS PRINTED &
DOES NOT CONTAIN AN ENGINEER'S
ORIGINAL SIGNATURE & SEAL, THIS
DOCUMENT IS VOID & NOT VALID FOR
USE. PHOTOCOPIES ARE NOT
PERMITTED FOR USE.

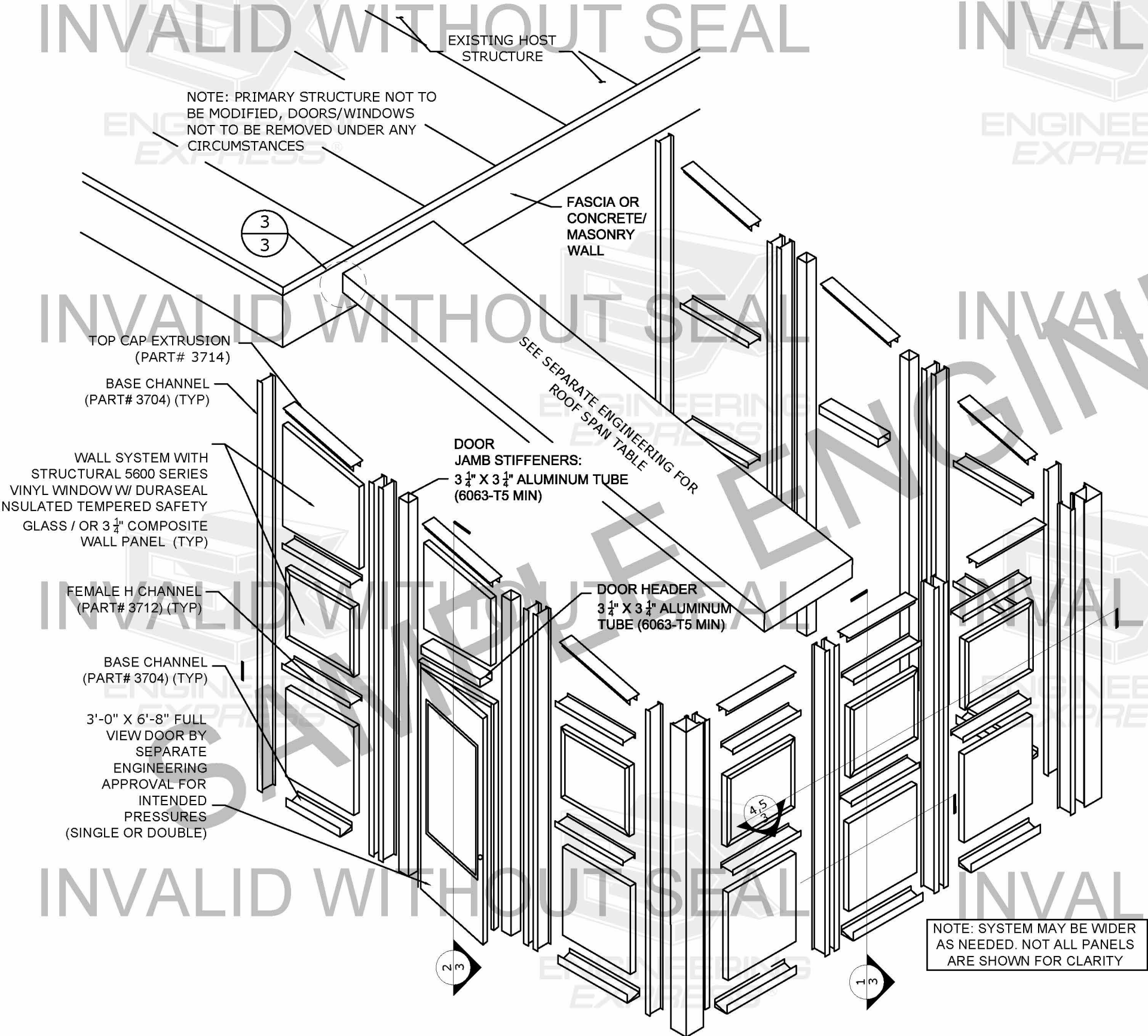

DESIGN NOTES:

POSITIVE AND NEGATIVE DESIGN PRESSURES CALCULATED FOR USE WITH THIS SYSTEM SHALL BE DETERMINED BY OTHERS ON A JOB-SPECIFIC BASIS IN ACCORDANCE WITH ASCE 7-16 & CHAPTER 16 OF THE 2020 FLORIDA BUILDING CODE (7TH EDITION), 2017 FLORIDA BUILDING CODE (6TH EDITION) & THE 2012/2015/2018 IBC/IRC, AS WELL AS CURRENT VERSIONS OF THE MN, NC, NJ, NY, OH, SC, & VA BUILDING CODES AS APPLICABLE. CODE ENFORCED COMPLIES WITH STATE OF SEAL AND IF MULTIPLE VERSIONS LISTED THEN MOST STRINGENT APPLIES.

DESIGN SHALL UTILIZE ASD DESIGN METHOD USING ASCE 7-16 OR ASCE 7-10 BASED ON APPLICABLE CODE..

*THIS DOCUMENT DOES **NOT** CERTIFY PRODUCT FOR USE AS A HABITABLE STRUCTURE. AAMA 2100 SUNROOM CLASSIFICATION II, III, OR IV ONLY.

GENERAL NOTES:

- 1) THE EXISTING STRUCTURE MUST BE CAPABLE OF SUPPORTING THE LOADED SUNROOM AS DETERMINED BY OTHERS. NO WARRANTY IS CONTAINED HEREIN.
- 1) WALL MEMBERS SHALL BE CONSTRUCTED USING MINIMUM TYPE 3005-H25 ALUMINUM FACINGS, (1) OR (2) PCF ASTM C-578 CARPENTER BRAND EPS. ADHERE TO ALUMINUM FACINGS WITH ASHLAND CHEMICAL 2020D ISO GRIP. FABRICATION TO BE BY ELITE PANEL PRODUCTS ONLY IN ACCORDANCE WITH APPROVED FABRICATION METHODS.
- 2) ALL EXTRUSIONS SHALL BE ALUMINUM ALLOY TYPE 6063-T6 OR BETTER.
- ALL FASTENERS TO BE ASTM F593, CW 316 STAINLESS STEEL, SAE GRADE 2 STEEL MIN, OR CADMIUM PLATED OR OTHER CORROSION RESISTANT MATERIAL AND SHALL COMPLY WITH THE 2015 ALUMINUM DESIGN MANUAL, THE ALUMINUM ASSOCIATION, INC., & APPLICABLE FEDERAL, STATE, AND LOCAL CODES.

MATERIALS

- 3) FASTENERS SHALL HAVE A HEAD AND/OR BE PROVIDED WITH 1/2" DIAMETER WASHER MINIMUM UNLESS NOTED OTHERWISE. FOR ALUMINUM MEMBERS ALL ANCHORS SHALL BE SPACED WITH 2xDIAMETER END DISTANCE AND 2.5xDIAMETER MIN. SPACING TO ADJACENT ANCHORS, UNLESS NOTED OTHERWISE. PROVIDE (5) PITCHES MIN PAST THE THREAD PLANE FOR ALL SCREW CONNECTIONS.
- 4) ANY FASTENER STRIPPED OR NOT ADEQUATELY HOLDING SHALL BE REPLACED.
- 5) THE CONTRACTOR IS RESPONSIBLE TO INSULATE ALUMINUM MEMBERS FROM DISSIMILAR METALS TO PREVENT ELECTROLYSIS.
- 6) ALL CONCRETE ANCHORS MUST BE CARBON STEEL ULTRACONS BY 'ELCO' OR EQUIVALENT W/ 1 1/4" EMBED, 2 1/2" MIN. EDGE DISTANCE, FASTENED TO MINIMUM 3192PSI MIN., UN-CRACKED CONCRETE.
- 7) IF REQUIRED BY CODE, THE EPS CORE SHALL BE SEPARATED FROM THE BUILDING INTERIOR BY A 15 MINUTE THERMAL BARRIER OF APPROVED 5/8 INCH GYPSUM WALLBOARD OR EQUAL. SUPERIOR MASON CAN PROVIDE UL1715 (INTERIOR) OR CLASS A(EXTIOR) PANEL TO SATISFY CODE PROVIDED ALUM. & EPS MEET SPECS ABOVE.
- WINDOWS AND DOORS SHALL BE BY OTHERS IN ACCORDANCE WITH REQUIRED WIND PRESSURES STATED IN TABLES & SHALL MEET ALL PRODUCT APPROVAL REQUIREMENTS. THIS ENCLOSURE IS **NOT IMPACT RESISTANT**. SHUTTERS SHALL NOT BE INSTALLED TO THIS ENCLOSURE. WHEN REQUIRED BY CODE, AN APPROVED IMPACT PROTECTION SYSTEM SHALL BE INSTALLED AT THE HOST STRUCTURE. HOST STRUCTURE DOORS AND WINDOWS ARE NOT TO BE REMOVED EXITING TO THIS ENCLOSURE. THIS ENCLOSURE IS NON-HABITABLE SPACE.

OTHER

- 8) ALUMINUM MEMBERS IN CONTACT WITH CONCRETE & WOOD SHALL BE PROTECTED BY 'KOPPERS BITUMINOUS PAINT' OR MFR. EQUAL IN ACCORDANCE WITH APPLICABLE CODE REQUIREMENTS.
- 9) ELECTRICAL GROUND AND ALL RELATED WIRING AND CONSIDERATIONS TO BE DESIGNED BY OTHERS AS REQUIRED.
- 10) EXISTING WOOD HOST STRUCTURE SHALL BE #2 SYP MIN. EXISTING METAL HOST STRUCTURE SHALL BE A36 STEEL OR 6063-T6 MIN ALUMINUM 1/4" THICK MIN. EXISTING CONCRETE HOST STRUCTURE SHALL BE 3000 PSI MIN. STRUCTURAL ADHESIVE SHALL HAVE 1500 PSI MIN BOND STRENGTH, CONTINUOUS BEAD, PROVIDED AT ALL SURFACES & JOINTS TO INTERLOCK THE SYSTEM.
- 11) THE SYSTEM DETAILED HEREIN IS GENERIC AND DOES NOT PROVIDE INFORMATION FOR A SPECIFIC SITE. FOR SITE CONDITIONS DIFFERENT FROM THE CONDITIONS DETAILED HEREIN, A LICENSED ENGINEER OR REGISTERED ARCHITECT SHALL PREPARE SITE SPECIFIC DOCUMENTS FOR USE IN CONJUNCTION WITH THIS DOCUMENT.
- 12) ENGINEER SEAL AFFIXED HERETO VALIDATES STRUCTURAL DESIGN AS SHOWN ONLY. NO MEP WORK IS IMPLIED OR CERTIFIED & SHALL BE BY OTHERS. USE OF THIS SPECIFICATION BY CONTRACTOR, et al. INDEMNIFIES AND SAVES HARMLESS THIS ENGINEER FOR ALL COSTS AND DAMAGES INCLUDING LEGAL FEES AND APPELLATE FEES RESULTING FROM MATERIAL FABRICATION, SYSTEM ERECTION, AND CONSTRUCTION PRACTICES BEYOND THAT WHICH IS CALLED FOR BY LOCAL, STATE, AND FEDERAL CODES AND FROM DEVIATIONS OF THIS PLAN.
- 13) EXCEPT AS EXPRESSLY PROVIDED IN THIS SPECIFICATION, NO ADDITIONAL CERTIFICATIONS OR AFFIRMATIONS ARE INTENDED.

ENGINEERING
EXPRESS®

CORPORATE OFFICE:
160 SW 12th AVE, SUITE 106
DEERFIELD BEACH, FL 33442
(954) 354-0660 | (866) 396-9999
TEAM@ENGINEERINGEXPRESS.COM
ENGINEERINGEXPRESS.COM

SUPERIOR MASON PRODUCTS

451 INDUSTRIAL LANE
BIRMINGHAM, AL
(631) 563-4000

MONOSLOPE ROOF
SUNROOF SYSTEM
MASTER PLAN

REMARKS	DRWN	CHKD	DATE
INIT ISSUE	TT	FLB	9/26/20
2020 FBC	FLB	COB	3/12/21

THIS DOCUMENT IS THE PROPERTY OF ENGINEERING EXPRESS, AND SHALL NOT BE REPRODUCED IN WHOLE OR PART WITHOUT WRITTEN CONSENT OF ENGINEERING EXPRESS. ALTERATIONS, ADDITIONS OR OTHER MARKINGS TO THIS DOCUMENT ARE NOT PERMITTED AND INVALIDATE OUR CERTIFICATION.

COPYRIGHT ENGINEERING EXPRESS®

20-30640

SCALE: NTS UNLESS NOTED

1 OF 4

VISIT [ECALC.IO/30640](https://ecalculator.com/30640)

FOR ENGINEER CERTIFIED ORIGINALS
& MORE INFORMATION ABOUT THIS DOCUMENT
OR SCAN THIS QR CODE

VISIT [ENGINEERINGEXPRESS.COM/STORE](https://engineeringexpress.com/store)
FOR ADDITIONAL PLANS, REPORTS & RESOURCES



EXTRUSIONS:

6063-T6 OR BETTER

COPIES NOT VALID FOR PERMIT

COPIES NOT VALID FOR PERMIT

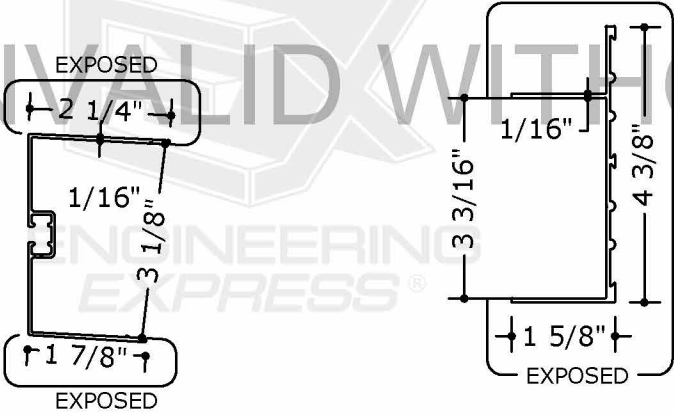

PART# 381
WALL HANGER

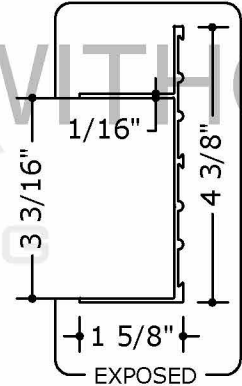

PART# 259
DECORATIVE FASCIA

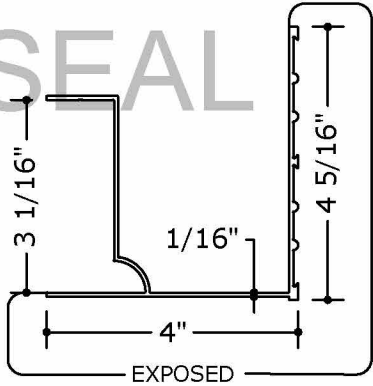

PART# 257
DECORATIVE GUTTER FASCIA

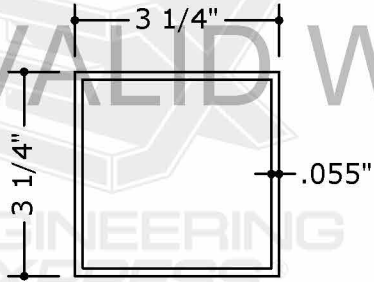

DOOR JAMB / HEADER:
3 1/4" X 3 1/4" X .055"
ALUMINUM TUBE (6063-T5 MIN)

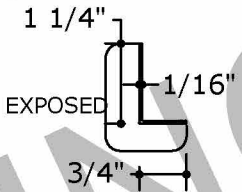

PART# 1205
ANGLE MEMBER

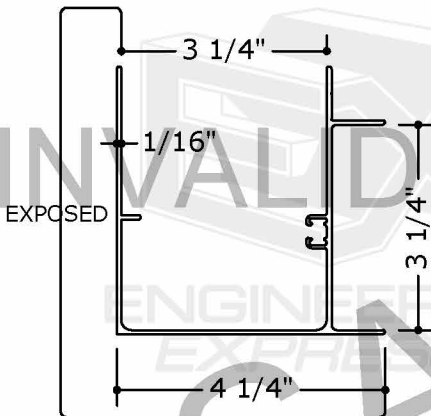

PART# 3702
CORNER POST

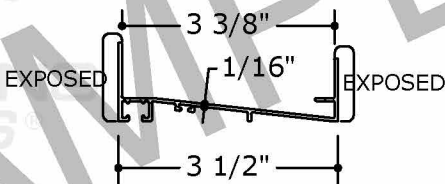

PART# 3704
BASE CHANNEL

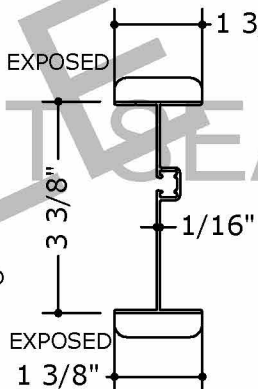

PART# 3712
FEMALE H CHANNEL

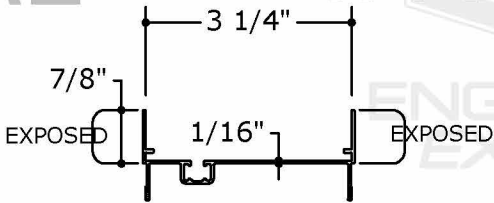

PART# 3713
MALE H CHANNEL

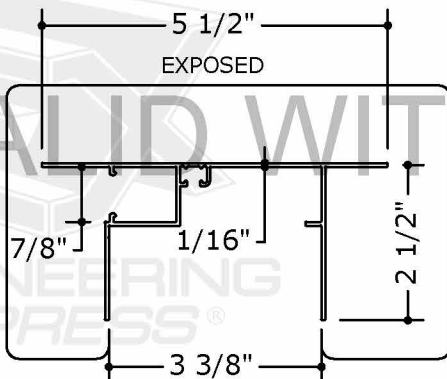

PART# 3714
TOP CAP

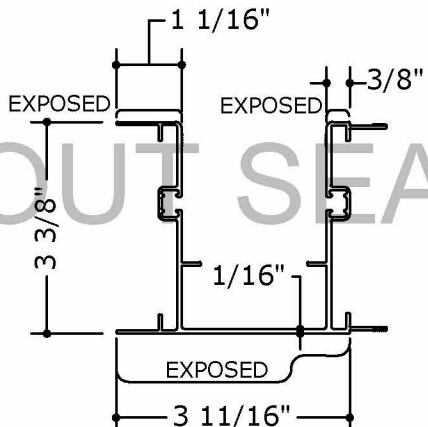

PART# 3719
ELECTRICAL BOX CAVITY

PE SEAL
REQUIRED
03/12/2021
CERTIFYING ENGINEER AND CERT
OF AUTH AS LISTED ON STAMP
VALID FOR 1 PERMIT ONLY U.N.O.

DIGITAL SEAL NOTICE:
IF THIS DOCUMENT IS DIGITALLY
SIGNED, THIS SHEET IS PART OF A
DIGITALLY SIGNED FILE. IT SHALL
REMAIN IN DIGITAL FORMAT, SHALL
BE VERIFIED BY ELECTRONIC MEANS,
& PRINTED COPIES OF THIS
DOCUMENT ARE NOT CONSIDERED
SIGNED AND SEALED.
PRINTED DOCUMENT NOTICE:
IF THIS DOCUMENT IS PRINTED &
DOES NOT CONTAIN AN ENGINEER'S
ORIGINAL SIGNATURE & SEAL, THIS
DOCUMENT IS VOID & NOT VALID FOR
USE. PHOTOCOPIES ARE NOT
PERMITTED FOR USE.

**ENGINEERING
EXPRESS®**
CORPORATE OFFICE:
160 SW 12th AVE, SUITE 106
DEERFIELD BEACH, FL 33442
(954) 354-0660 | (866) 396-9999
TEAM@ENGINEERINGEXPRESS.COM
ENGINEERINGEXPRESS.COM

SUPERIOR MASON PRODUCTS
451 INDUSTRIAL LANE
BIRMINGHAM, AL
(631) 563-4000
MONOSLOPE ROOF
SUNROOF SYSTEM
MASTER PLAN

REMARKS	DRWN	CHKD	DATE
INIT ISSUE	TT	FLB	9/26/20
2020 FBC	FLB	COB	3/12/21

THIS DOCUMENT IS THE PROPERTY OF ENGINEERING EXPRESS
AND SHALL NOT BE REPRODUCED IN WHOLE OR PART WITHOUT
WRITTEN CONSENT OF ENGINEERING EXPRESS. ALTERATIONS,
ADDITIONS, OR OTHER MARKINGS TO THIS DOCUMENT ARE NOT
PERMITTED AND INVALIDATE OUR CERTIFICATION.

CONNECTIONS:

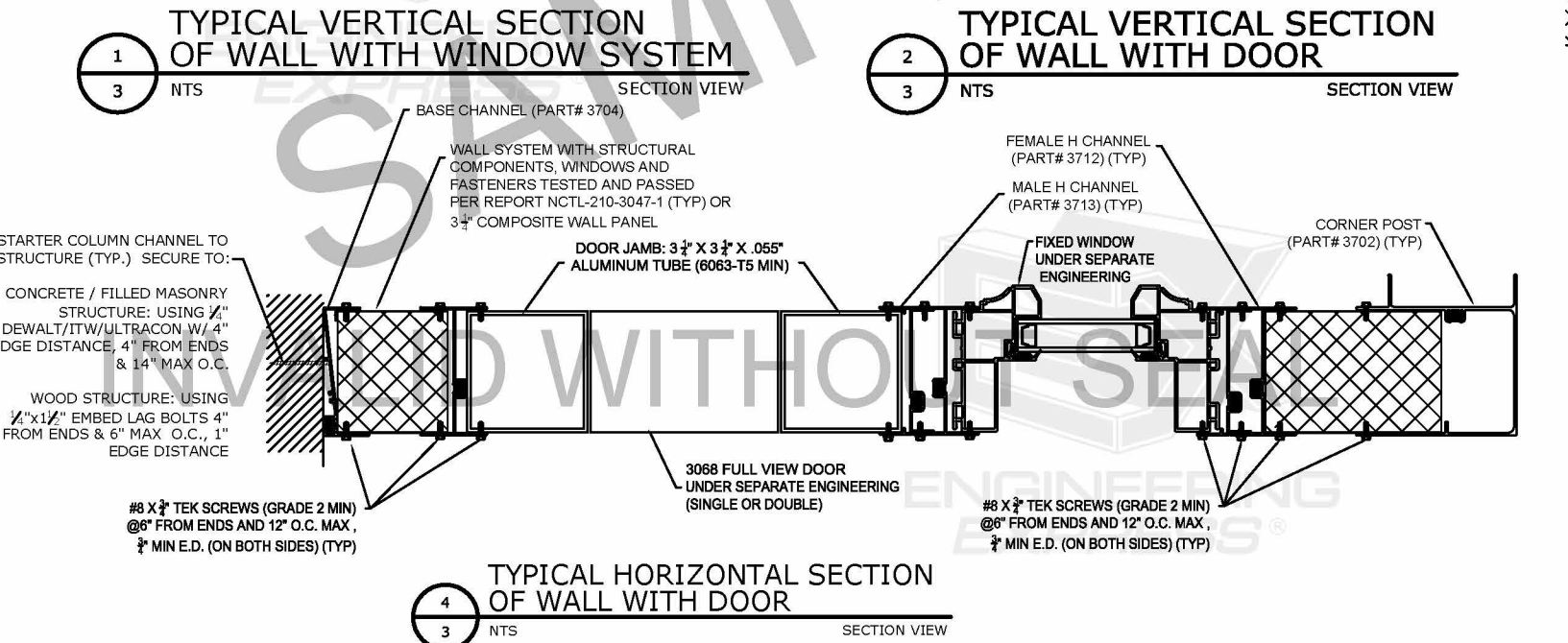
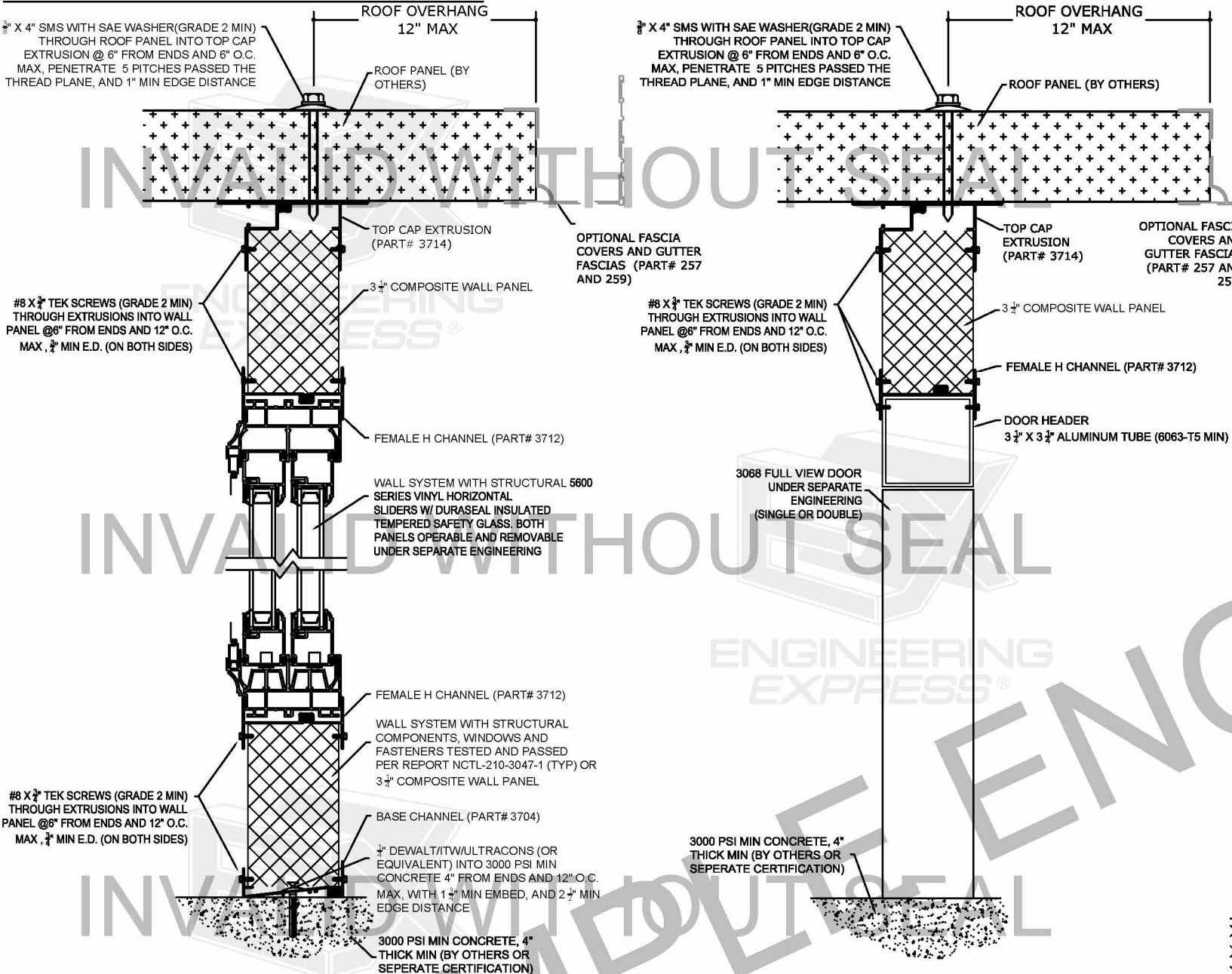

(2) 1/4"Øx3" LAG BOLT @ 7" O.C. & 4" FROM ENDS TO 2" SOUND FASCIA. ENSURE FASCIA IS SECURELY FASTENED TO EACH RAFTER WITH (4) 1/4"Øx3" LAGS MIN.. CENTER LAGS TO RAFTERS. ENSURE 1 1/2" MIN. PENETRATION PRE-DRILL HOLE TO AVOID SPLITTING

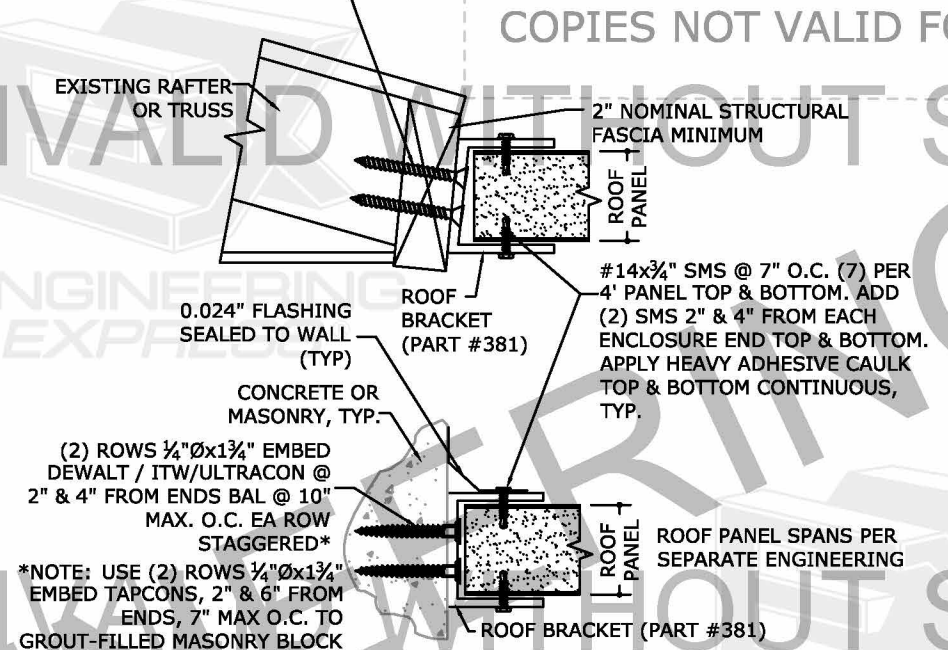

ROOF PANEL CONNECTION TO HOST STRUCTURE

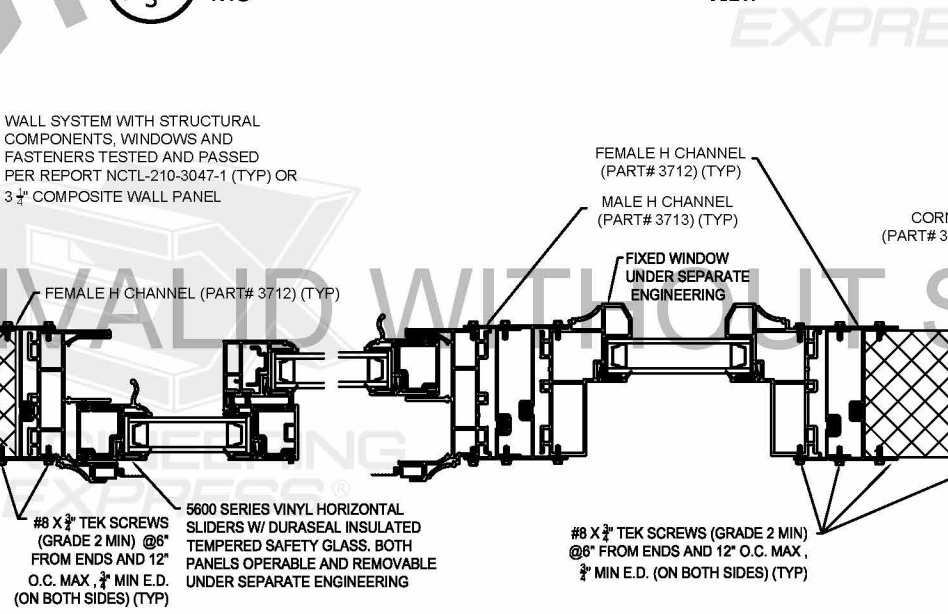

TYPICAL HORIZONTAL SECTION OF WALL WITH WINDOW SYSTEM

COPIES NOT VALID FOR PERMIT

03/12/2021

CERTIFYING ENGINEER AND CERT OF AUTH AS LISTED ON STAMP

VALID FOR 1 PERMIT ONLY UNO

DIGITAL SEAL NOTICE: IF THIS DOCUMENT IS DIGITALLY SIGNED, THIS SHEET IS PART OF A DIGITALLY SIGNED FILE. IT SHALL REMAIN IN DIGITAL FORMAT, SHALL BE VERIFIED BY ELECTRONIC MEANS, & PRINTED COPIES OF THIS DOCUMENT ARE NOT CONSIDERED SIGNED AND SEALED.

PRINTED DOCUMENT NOTICE: IF THIS DOCUMENT IS PRINTED & DOES NOT CONTAIN AN ENGINEER'S ORIGINAL SIGNATURE & SEAL, THIS DOCUMENT IS VOID & NOT VALID FOR USE. PHOTOCOPIES ARE NOT PERMITTED FOR USE.

ENGINEERING EXPRESS®

CORPORATE OFFICE: 106 DEERFIELD BEACH, FL 33442 (954) 354-0660 | (866) 396-9999 TEAM@ENGINEERINGEXPRESS.COM ENGINEERINGEXPRESS.COM

SUPERIOR MASON PRODUCTS

451 INDUSTRIAL LANE BIRMINGHAM, AL (631) 563-4000

MONOSLOPE ROOF SUNROOF SYSTEM MASTER PLAN

REMARKS	DRWN	CHKD	DATE
INIT ISSUE	TT	FLB	9/26/20
2020 FBC	FLB	COB	3/12/21

THIS DOCUMENT IS THE PROPERTY OF ENGINEERING EXPRESS, AND SHALL NOT BE REPRODUCED IN WHOLE OR PART WITHOUT WRITTEN CONSENT OF ENGINEERING EXPRESS. ALTERATIONS, ADDITIONS, OR OTHER MARKINGS TO THIS DOCUMENT ARE NOT PERMITTED AND INVALIDATE OUR CERTIFICATION.

COPYRIGHT ENGINEERING EXPRESS®

20-30640

SCALE: NTS UNLESS NOTED

3 OF 4

COLUMN ALLOWABLE HEIGHT TABLE:

TABLE 1:

COLUMN TYPE	MAX ROOF SPAN S(FT)	LIVE LOAD GRAVITY (PSF)	WIND LOAD (PSF)	AVG COLUMN SPACING W(FT)				
				2	3	4	5	6
H-MULL (PART NO. 3712)	10	20	20	10'-0"	9'-5"	8'-0"	7'-5"	7'-5"
			30	10'-0"	8'-7"	7'-6"	6'-9"	6'-5"
			40	9'-3"	7'-7"	6'-8"	6'-0"	5'-8"
			50	8'-5"	7'-0"	6'-1"	5'-5"	5'-2"
	20	50	20	10'-0"	8'-7"	5'-10"	-	-
			30	10'-0"	7'-1"	4'-10"	-	-
			40	9'-1"	6'-3"	4'-3"	-	-
			50	8'-3"	5'-8"	-	-	-

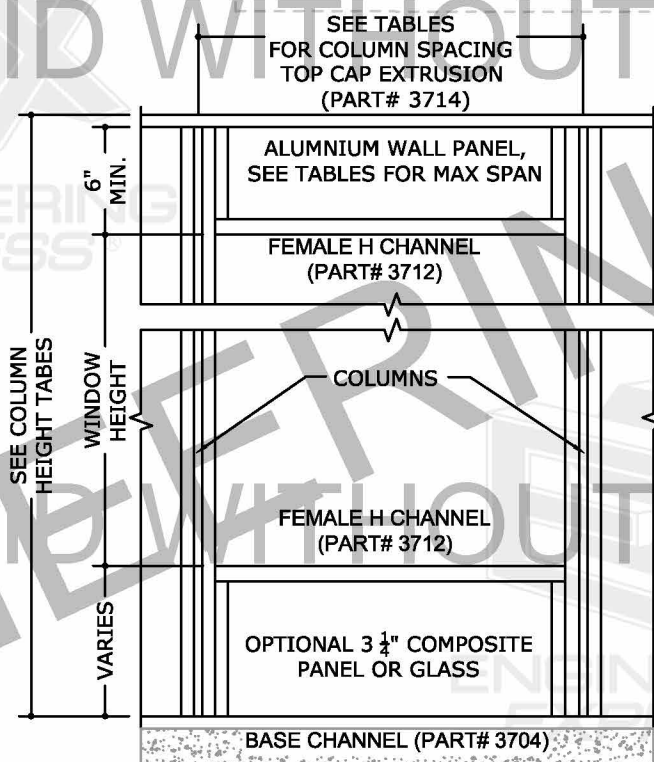

1 4 TYPICAL ELEVATION NTS ELEVATION

TABLE 1 NOTES:

- 1) 2015 ALUMINUM DESIGN MANUAL, ALLOWABLE STRESS DESIGN METHOD USED IN ALL TABLES.
- 2) VERIFY ALL LOADING REQUIREMENTS WITH BUILDING DEPARTMENT.
- 3) DEFLECTION LIMIT = L/180 AT GLASS POINTS.
- 4) CUSTOM WINDOWS STRUCTURAL 5600 SERIES VINYL HORIZONTAL SLIDERS W/ DURASEAL JAMBS USED FOR CALCULATIONS, ANY SUPERIOR MASON ALUMINUM WINDOWS CAN BE SUBSTITUTED, OR OTHER MANUFACTURER EQUIVALENT WINDOW AS VERIFIED BY OTHERS.
- 5) COLUMN SPACING IS HALF THE DISTANCE TO THE LEFT ADDED TO HALF THE DISTANCE TO THE RIGHT OF THE BEAM (AVERAGE COLUMN SPACING, SEE FIGURE).
- 6) VALUES BELOW ALLOWABLE CEILING HEIGHT INTENDED TO BE BUILT ON KNEEWALLS OR OTHER SUPPORTING STRUCTURES (SUPPORTING STRUCTURES BY OTHERS).
- 7) *LIVE LOADS SPECIFIED HEREIN LIST THE ALLOWABLE ROOF LIVE LOAD AND MAY BE SUBSTITUTED WITH THE REQUIRED SNOW LOAD (NOT CONCURRENTLY WITH THE ROOF LIVE LOAD, BUT CONCURRENT WITH WIND) PROVIDED THE PROJECT SITE IS CERTIFIED BY A PROFESSIONAL ENGINEER BASED ON PROJECT CONDITIONS.

COLUMN SPACING DEFINED:

- COLUMN 1 SPACING= (1/2 * SPAN 1)
- COLUMN 2 SPACING= 1/2(SPAN 1+SPAN 2)

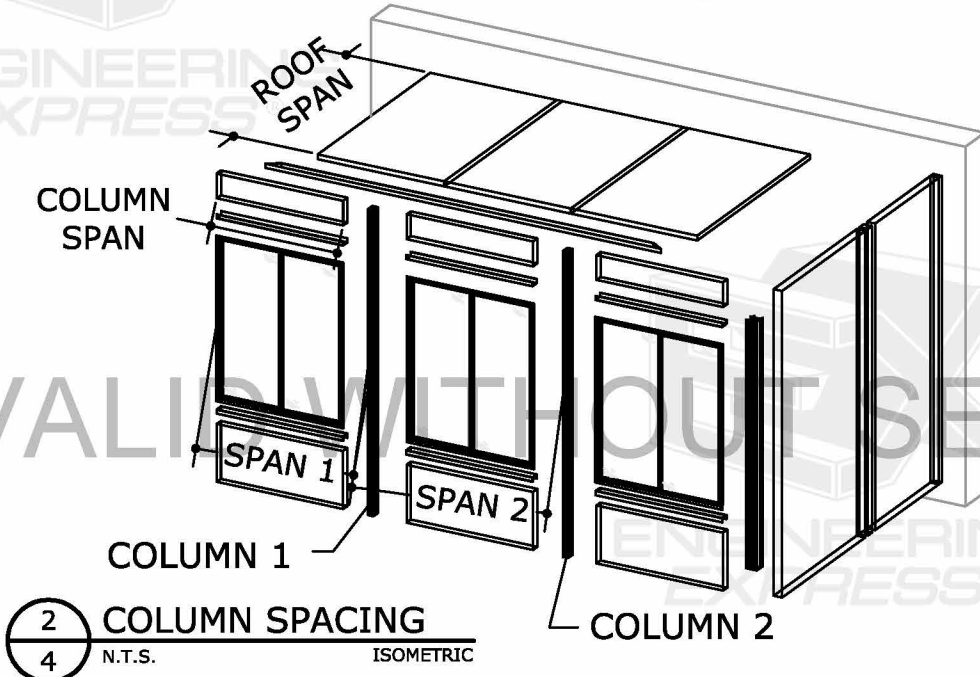

2 4 COLUMN SPACING N.T.S. ISOMETRIC

COPIES NOT VALID FOR PERMIT

COPIES NOT VALID FOR PERMIT

03/12/2021

CERTIFYING ENGINEER AND CERT OF AUTH AS LISTED ON STAMP

VALID FOR 1 PERMIT ONLY U.N.O.

DIGITAL SEAL NOTICE:
IF THIS DOCUMENT IS DIGITALLY SIGNED, THIS SHEET IS PART OF A DIGITALLY SIGNED FILE. IT SHALL REMAIN IN DIGITAL FORMAT, SHALL BE VERIFIED BY ELECTRONIC MEANS, & PRINTED COPIES OF THIS DOCUMENT ARE NOT CONSIDERED SIGNED AND SEALED.

PRINTED DOCUMENT NOTICE:
IF THIS DOCUMENT IS PRINTED & DOES NOT CONTAIN AN ENGINEER'S ORIGINAL SIGNATURE & SEAL, THIS DOCUMENT IS VOID & NOT VALID FOR USE. PHOTOCOPIES ARE NOT PERMITTED FOR USE.

ENGINEERING EXPRESS®

CORPORATE OFFICE:
160 SW 12TH AVE, SUITE 106
DEERFIELD BEACH, FL 33442
(954) 354-0660 | (866) 396-9999
TEAM@ENGINEERINGEXPRESS.COM
ENGINEERINGEXPRESS.COM

SUPERIOR MASON PRODUCTS

451 INDUSTRIAL LANE
BIRMINGHAM, AL
(631) 563-4000

MONOSLOPE ROOF
SUNROOF SYSTEM
MASTER PLAN

DRWN	CHKD	DATE
TT	FLB	9/26/20
FLB	COB	3/12/21

REMARKS
INIT ISSUE
2020 FBC

THIS DOCUMENT IS THE PROPERTY OF ENGINEERING EXPRESS, AND SHALL NOT BE REPRODUCED IN WHOLE OR PART WITHOUT WRITTEN CONSENT OF ENGINEERING EXPRESS. ALTERATIONS, ADDITIONS, OR OTHER MARKINGS TO THIS DOCUMENT ARE NOT PERMITTED AND INVALIDATE OUR CERTIFICATION.

COPYRIGHT ENGINEERING EXPRESS®

20-30640

SCALE: NTS UNLESS NOTED

4 OF 4

C:\Users\oolby\Engineering\Express\Production - Documents\Projects\20-30640 Monoslope Roof Sunroom System\WVP Drawings & CAD\20-30640c Monoslope Roof Sunroom System.dwg
03/12/2021 - 12:19pm
oolby