

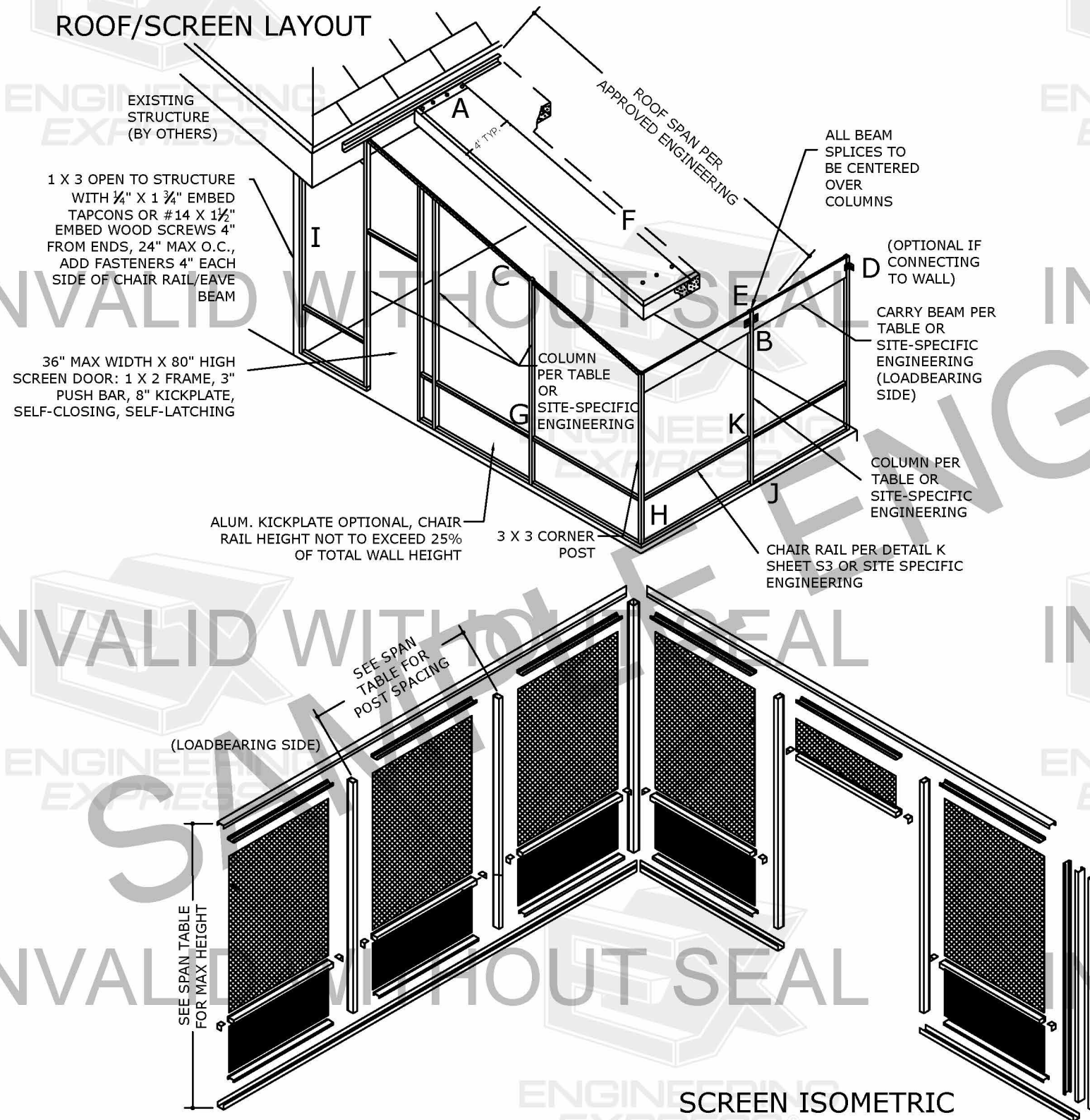

SCREEN ROOM AND EPS PANEL ROOF

MASTER PLAN SHEET

ROOF/SCREEN LAYOUT



DESIGN NOTES:

1. POSITIVE AND NEGATIVE DESIGN PRESSURES CALCULATED FOR USE WITH THIS SYSTEM SHALL BE DETERMINED BY OTHERS ON A JOB-SPECIFIC BASIS IN ACCORDANCE WITH CHAPTER 16 OF THE 2020 FLORIDA BUILDING CODE (7TH EDITION), THE 2012/2015/2018 IBC/IRC, AS WELL AS CURRENT VERSIONS OF THE MN, NC, NJ, NY, OH, SC, & VA BUILDING CODES AS APPLICABLE. CODE ENFORCED COMPLIES WITH STATE OF SEAL AND IF MULTIPLE VERSIONS LISTED THEN MOST STRINGENT APPLIES.
2. DESIGN SHALL UTILIZE ASD DESIGN METHOD USING ASCE 7-16 OR ASCE 7-10 BASED ON APPLICABLE CODE.
3. *THIS DOCUMENT DOES **NOT** CERTIFY PRODUCT FOR USE AS A HABITABLE STRUCTURE. SCREEN ROOM APPLICATION ONLY.
4. THE EXISTING STRUCTURE MUST BE CAPABLE OF SUPPORTING THE LOADED SUNROOM AS DETERMINED BY OTHERS. NO WARRANTY IS CONTAINED HEREIN.
5. ALL EXTRUSIONS SHALL BE ALUMINUM ALLOY TYPE 6005-T5 OR BETTER.
6. ALL FASTENERS TO BE ASTM F593, CW 316 STAINLESS STEEL, SAE GRADE 2 STEEL MIN, OR CADMIUM PLATED OR OTHER CORROSION RESISTANT MATERIAL AND SHALL COMPLY WITH THE 2015 ALUMINUM DESIGN MANUAL, THE ALUMINUM ASSOCIATION, INC., & APPLICABLE FEDERAL, STATE, AND LOCAL CODES.

GENERAL NOTES:

MATERIALS

- 1) FASTENERS SHALL HAVE A HEAD AND/OR BE PROVIDED WITH 1/2" DIAMETER WASHER MINIMUM UNLESS NOTED OTHERWISE. FOR ALUMINUM MEMBERS ALL ANCHORS SHALL BE SPACED WITH 2xDIAMETER END DISTANCE AND 2.5xDIAMETER MIN. SPACING TO ADJACENT ANCHORS, UNLESS NOTED OTHERWISE. PROVIDE (5) PITCHES MIN PAST THE THREAD PLANE FOR ALL SCREW CONNECTIONS.
- 2) ANY FASTENER STRIPPED OR NOT ADEQUATELY HOLDING SHALL BE REPLACED.
- 3) ALL CONCRETE ANCHORS MUST BE CARBON STEEL ITW, DEWALT, OR EQUIVALENT WITH 1 3/4" EMBEDMENT PAST FINISHES, 2 1/2" MIN. EDGE DISTANCE, FASTENED TO MINIMUM 3KSI UN-CRACKED CONCRETE.
- 4) IF REQUIRED BY CODE, THE EPS CORE SHALL BE SEPARATED FROM THE BUILDING INTERIOR BY A 15 MINUTE THERMAL BARRIER OF APPROVED 5/8 INCH GYPSUM WALLBOARD OR EQUAL. SUPERIOR MASON CAN PROVIDE UL1715 (INTERIOR) OR CLASS A(EXTERIOR) PANEL TO SATISFY CODE PROVIDED ALUM. & EPS MEET SPECS ABOVE.

OTHER

- 5) ALUMINUM MEMBERS IN CONTACT WITH CONCRETE & WOOD SHALL BE PROTECTED BY 'KOPPERS BITUMINOUS PAINT' OR MFR. EQUAL IN ACCORDANCE WITH APPLICABLE CODE REQUIREMENTS.
- 6) ELECTRICAL GROUND AND ALL RELATED WIRING AND CONSIDERATIONS TO BE DESIGNED BY OTHERS AS REQUIRED.
- 7) EXISTING WOOD HOST STRUCTURE SHALL BE #2 SYP MIN. EXISTING METAL HOST STRUCTURE SHALL BE A36 STEEL OR 6063-T6 MIN ALUMINUM 1/4" THICK MIN. EXISTING CONCRETE HOST STRUCTURE SHALL BE 3000 PSI MIN. STRUCTURAL ADHESIVE SHALL HAVE 1500 PSI MIN BOND STRENGTH, CONTINUOUS BEAD, PROVIDED AT ALL SURFACES & JOINTS TO INTERLOCK THE SYSTEM.
- 8) THE SYSTEM DETAILED HEREIN IS GENERIC AND DOES NOT PROVIDE INFORMATION FOR A SPECIFIC SITE. FOR SITE CONDITIONS DIFFERENT FROM THE CONDITIONS DETAILED HEREIN, A LICENSED ENGINEER OR REGISTERED ARCHITECT SHALL PREPARE SITE SPECIFIC DOCUMENTS FOR USE IN CONJUNCTION WITH THIS DOCUMENT.
- 9) ENGINEER SEAL AFFIXED HERETO VALIDATES STRUCTURAL DESIGN AS SHOWN ONLY. NO MEP WORK IS IMPLIED OR CERTIFIED & SHALL BE BY OTHERS. USE OF THIS SPECIFICATION BY CONTRACTOR, et al. INDEMNIFIES AND SAVES HARMLESS THIS ENGINEER FOR ALL COSTS AND DAMAGES INCLUDING LEGAL FEES AND APPELLATE FEES RESULTING FROM MATERIAL FABRICATION, SYSTEM ERECTION, AND CONSTRUCTION PRACTICES BEYOND THAT WHICH IS CALLED FOR BY LOCAL, STATE, AND FEDERAL CODES AND FROM DEVIATIONS OF THIS PLAN.
- 10) EXCEPT AS EXPRESSLY PROVIDED IN THIS SPECIFICATION, NO ADDITIONAL CERTIFICATIONS OR AFFIRMATIONS ARE INTENDED.

VISIT [ECALC.IO/30634](https://ecalculator.com/30634)

FOR ENGINEER CERTIFIED ORIGINALS
& MORE INFORMATION ABOUT THIS DOCUMENT
OR SCAN THIS QR CODE

VISIT [ENGINEERINGEXPRESS.COM/STORE](https://engineeringexpress.com/store)
FOR ADDITIONAL PLANS, REPORTS & RESOURCES



PE SEAL
REQUIRED
03/12/2021
CERTIFYING ENGINEER AND CERT
OF AUTH AS LISTED ON STAMP
VALID FOR 1 PERMIT ONLY UNO

DIGITAL SEAL NOTICE:
IF THIS DOCUMENT IS DIGITALLY
SIGNED, THIS SHEET IS PART OF A
DIGITALLY SIGNED FILE. IT SHALL
REMAIN IN DIGITAL FORMAT, SHALL
BE VERIFIED BY ELECTRONIC MEANS,
& PRINTED COPIES OF THIS
DOCUMENT ARE NOT CONSIDERED
SIGNED AND SEALED.
PRINTED DOCUMENT NOTICE:
IF THIS DOCUMENT IS PRINTED &
DOES NOT CONTAIN AN ENGINEER'S
ORIGINAL SIGNATURE & SEAL, THIS
DOCUMENT IS VOID & NOT VALID FOR
USE. PHOTOCOPIES ARE NOT
PERMITTED FOR USE.

**ENGINEERING
EXPRESS**
CORPORATE OFFICE:
160 SW 12th AVE, SUITE 106
DEERFIELD BEACH, FL 33442
(954) 354-0660 | (866) 396-9999
TEAM@ENGINEERINGEXPRESS.COM
ENGINEERINGEXPRESS.COM

SUPERIOR MASON PRODUCTS
451 INDUSTRIAL LANE
BIRMINGHAM, AL
(631) 563-4000
SCREEN ROOM AND EPS PANEL ROOF
MASTER PLAN SHEET

REMARKS	DRWN	CHKD	DATE
INIT ISSUE	TT	FLB	1/10/20
2020 FEB	FLB	COB	3/12/21

THIS DOCUMENT IS THE PROPERTY OF ENGINEERING EXPRESS
AND SHALL NOT BE REPRODUCED IN WHOLE OR PART WITHOUT
WRITTEN CONSENT OF ENGINEERING EXPRESS. ALTERATIONS,
ADDITIONS, OR OTHER MARKINGS TO THIS DOCUMENT ARE NOT
PERMITTED AND INVALIDATE OUR CERTIFICATION.

COPYRIGHT ENGINEERING EXPRESS®

20-30634

SCALE: NTS UNLESS NOTED

1

EXTRUSIONS

ALUINUM EXTRUSIONS TO
BE 6005-T5 OR BETTER

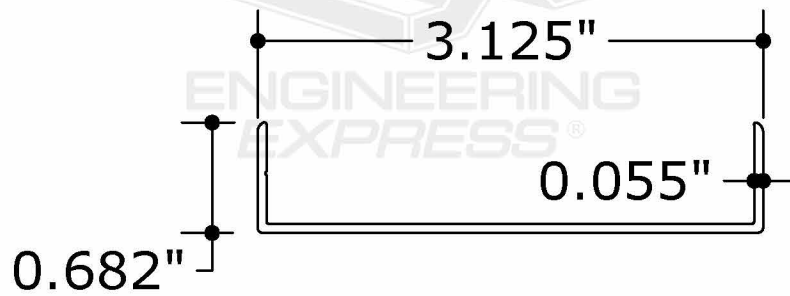

STARTER CHANNEL
(TO LEVEL AS NEEDED)

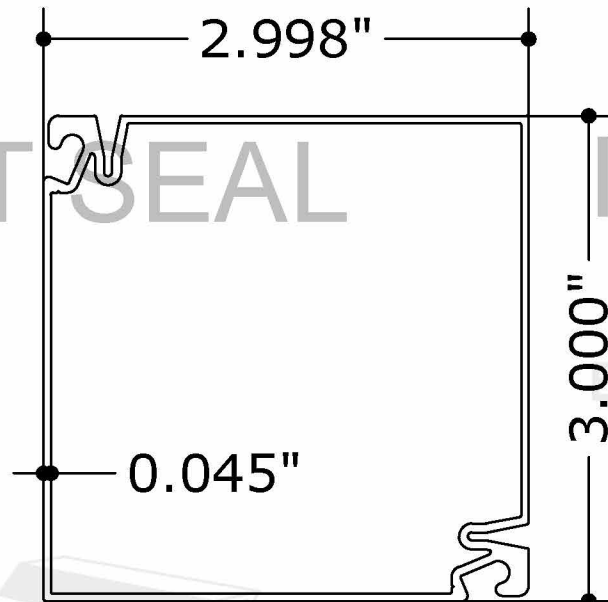

3 X 3 X 0.055" CORNER POST

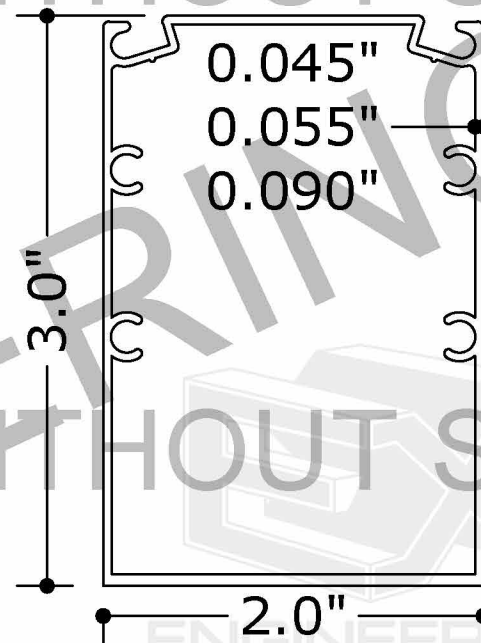

2 X 3 TUBES

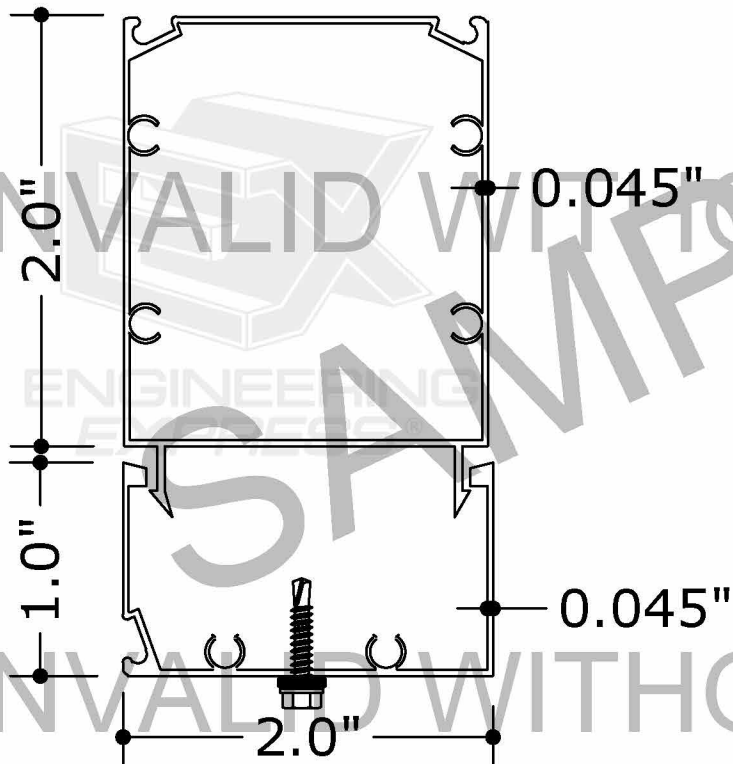

2 X 2 + 1 X 2 OPEN *

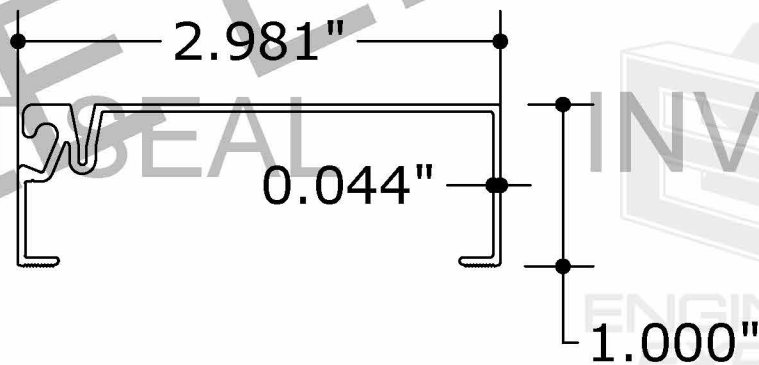

1 X 3 X 0.045" OPEN

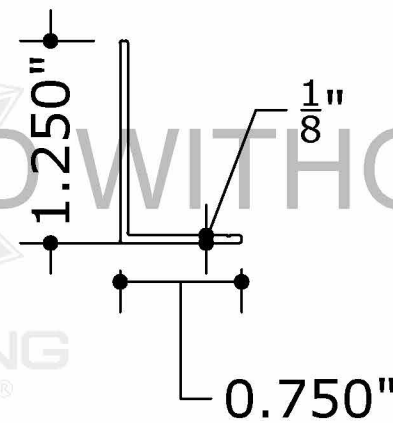

ATTACHMENT ANGLE

*FOR NON-SNAP USE #14 X 2½" SMS @ 16" O.C.
(THIS IS USED FOR NON-PRIMARY WALL HEADER &
2" X 3" X 0.045" CARRY BEAM APPLICATIONS)

COPIES NOT VALID FOR PERMIT

COPIES NOT VALID FOR PERMIT

PE SEAL
REQUIRED
03/12/2021
CERTIFYING ENGINEER AND CERT
OF AUTH AS LISTED ON STAMP
VALID FOR 1 PERMIT ONLY U.N.O.
DIGITAL SEAL NOTICE:
IF THIS DOCUMENT IS DIGITALLY
SIGNED, THIS SHEET IS PART OF A
DIGITALLY SIGNED FILE. IT SHALL
REMAIN IN DIGITAL FORMAT, SHALL
BE VERIFIED BY ELECTRONIC MEANS,
& PRINTED COPIES OF THIS
DOCUMENT ARE NOT CONSIDERED
SIGNED AND SEALED.
PRINTED DOCUMENT NOTICE:
IF THIS DOCUMENT IS PRINTED &
DOES NOT CONTAIN AN ENGINEER'S
ORIGINAL SIGNATURE & SEAL, THIS
DOCUMENT IS VOID & NOT VALID FOR
USE. PHOTOCOPIES ARE NOT
PERMITTED FOR USE.

ENGINEERING
EXPRESS®
CORPORATE OFFICE:
160 SW 12th AVE, SUITE 106
DEERFIELD BEACH, FL 33442
(954) 354-0660 | (866) 396-9999
TEAM@ENGINEERINGEXPRESS.COM
ENGINEERINGEXPRESS.COM

SUPERIOR MASON PRODUCTS
451 INDUSTRIAL LANE
BIRMINGHAM, AL
(631) 563-4000
SCREEN ROOM AND EPS PANEL ROOF
MASTER PLAN SHEET

REMARKS	DRWN	CHKD	DATE
INIT ISSUE	TT	FLB	1/10/20
2020 FEB	FLB	COB	3/12/21

THIS DOCUMENT IS THE PROPERTY OF ENGINEERING EXPRESS
AND SHALL NOT BE REPRODUCED IN WHOLE OR PART WITHOUT
WRITTEN CONSENT OF ENGINEERING EXPRESS. ALTERATIONS,
ADDITIONS OR OTHER MARKINGS TO THIS DOCUMENT ARE NOT
PERMITTED AND INVALIDATE OUR CERTIFICATION.

COPYRIGHT ENGINEERING EXPRESS®
20-30634
SCALE: NTS UNLESS NOTED
2 OF 5

CONNECTIONS:

A CONNECTION TO STRUCTURE:
WOOD OR CONCRETE

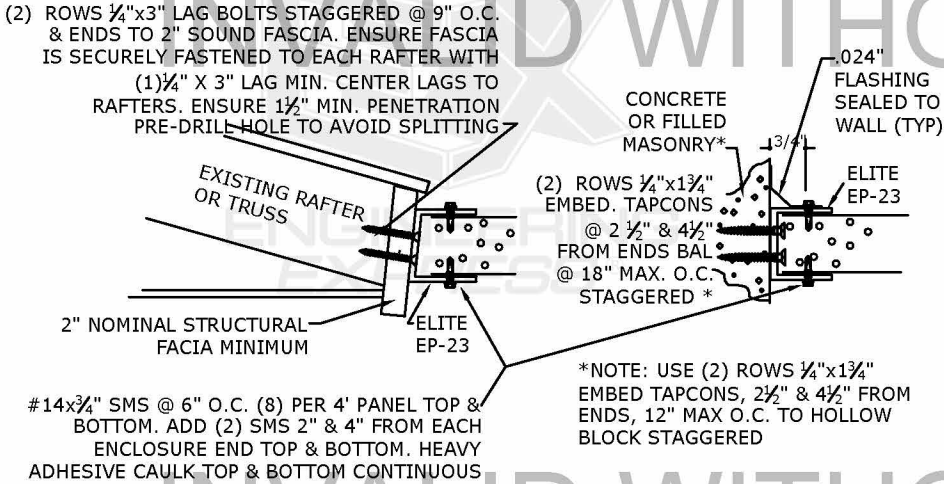

B SECTION AT BEARING COLUMN

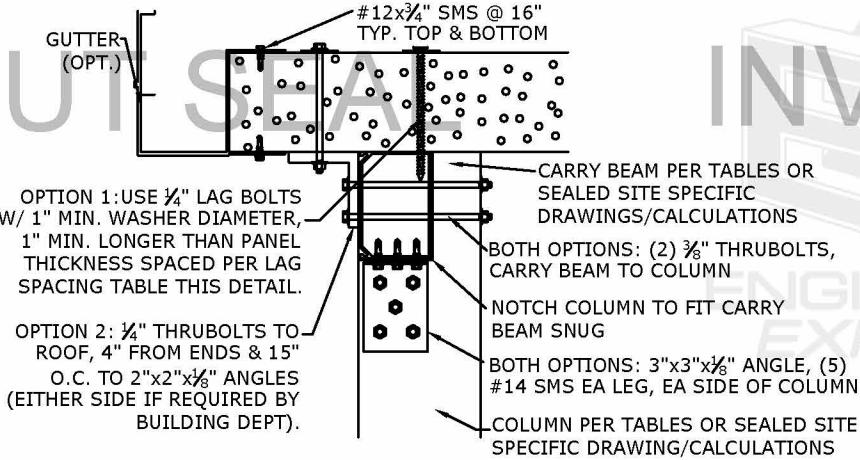

C SECTION AT SIDE OF ROOF PANEL

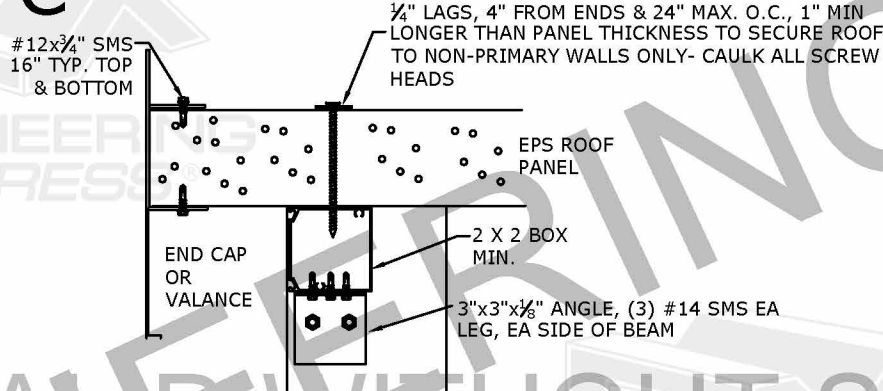

D EAVE BEAM CONNECTION @ WALL

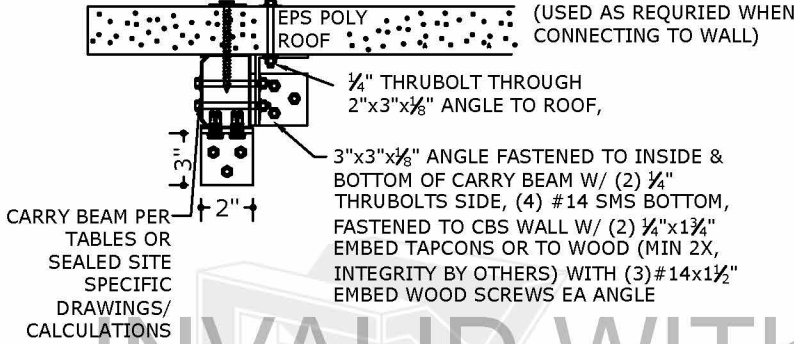

E BEAM SPLICE OVER COLUMN

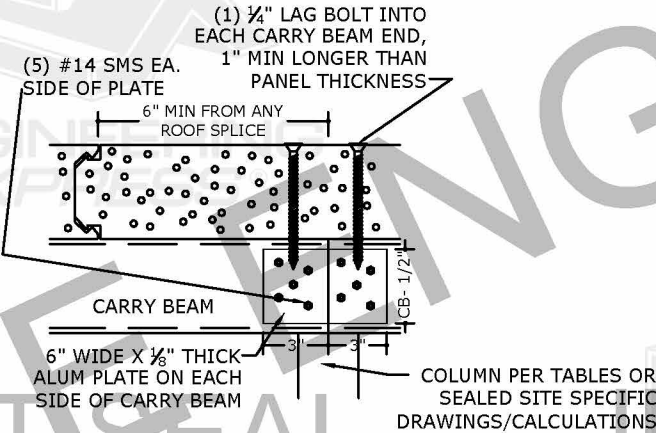

F ROOF PANEL CONNECTION FRONT ELEVATION

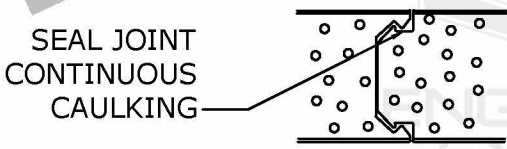

J ENCLOSURE TO CONCRETE DECK ANCHORING DETAIL

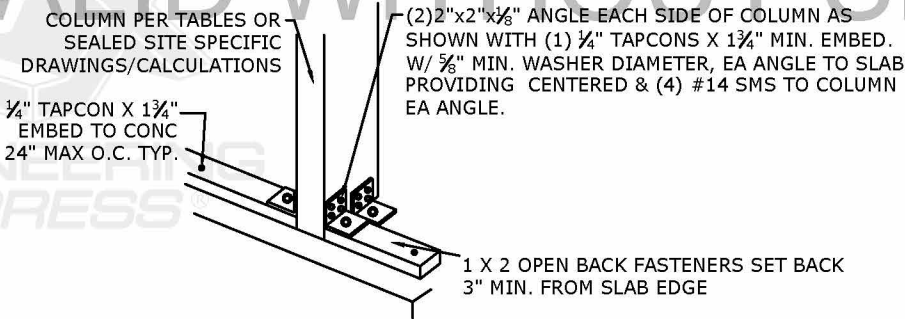

H CORNER HOST ATTACHMENT (CONCRETE OR WOOD HOST STRUCTURE)

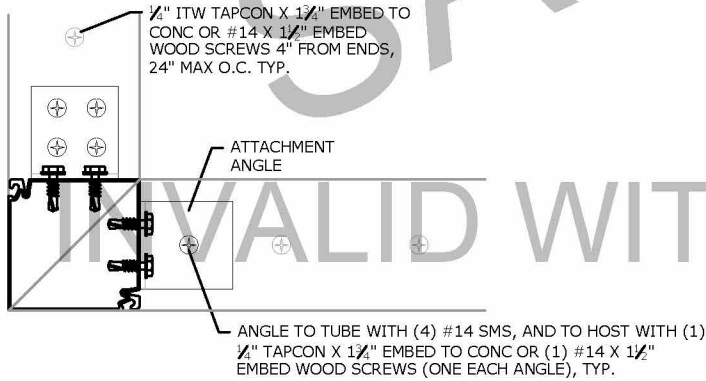

I 1x3 TO HOST STRUCTURE

APPLICABLE AT ALL HOST STRUCTURE CONNECTIONS (TOP, BOTTOM, OR SIDES)

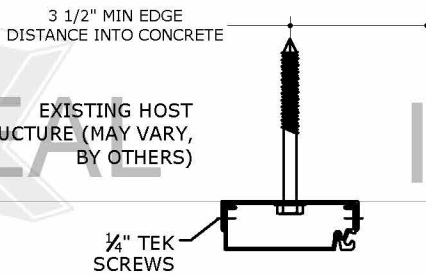

K TYP. BEAM TO CHAIR RAIL

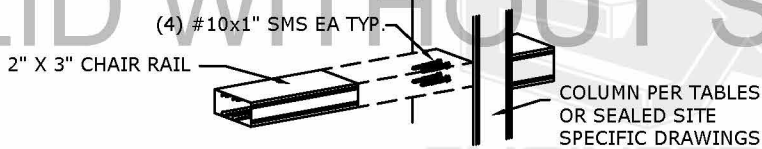

COPIES NOT VALID FOR PERMIT

COPIES NOT VALID FOR PERMIT

PE SEAL
REQUIRED
03/12/2021

CERTIFYING ENGINEER AND CERT OF AUTH AS LISTED ON STAMP

VALID FOR 1 PERMIT ONLY U.N.O.
DIGITAL SEAL NOTICE:
IF THIS DOCUMENT IS DIGITALLY SIGNED, THIS SHEET IS PART OF A DIGITALLY SIGNED FILE. IT SHALL REMAIN IN DIGITAL FORMAT, SHALL BE VERIFIED BY ELECTRONIC MEANS, & PRINTED COPIES OF THIS DOCUMENT ARE NOT CONSIDERED SIGNED AND SEALED.
PRINTED DOCUMENT NOTICE:
IF THIS DOCUMENT IS PRINTED & DOES NOT CONTAIN AN ENGINEER'S ORIGINAL SIGNATURE & SEAL, THIS DOCUMENT IS VOID & NOT VALID FOR USE. PHOTOCOPIES ARE NOT PERMITTED FOR USE.

ENGINEERING EXPRESS
CORPORATE OFFICE:
160 SW 12th AVE, SUITE 106
DEERFIELD BEACH, FL 33442
(954) 354-0660 | (866) 396-9999
TEAM@ENGINEERINGEXPRESS.COM
ENGINEERINGEXPRESS.COM

SUPERIOR MASON PRODUCTS
451 INDUSTRIAL LANE
BIRMINGHAM, AL
(631) 563-4000
SCREEN ROOM AND EPS PANEL ROOF
MASTER PLAN SHEET

DATE	DRWN	CHKD	DATE	DRWN	CHKD
1/10/20	TT	FLB	3/12/21	TT	FLB
		COB			COB

REMARKS
INIT ISSUE
2020 FEB

THIS DOCUMENT IS THE PROPERTY OF ENGINEERING EXPRESS AND SHALL NOT BE REPRODUCED IN WHOLE OR PART WITHOUT WRITTEN CONSENT OF ENGINEERING EXPRESS. ALTERATIONS, ADDITIONS OR OTHER MARKINGS TO THIS DOCUMENT ARE NOT PERMITTED AND INVALIDATE OUR CERTIFICATION.

COPYRIGHT ENGINEERING EXPRESS®

20-30634

SCALE: NTS UNLESS NOTED

3 OF 5

COLUMN ALLOWABLE HEIGHT TABLE:

COPIES NOT VALID FOR PERMIT

Column Type	Max Roof Span S (ft)	Live Load Gravity (psf)	Wind Load (psf)	AVG Column Spacing W(ft)				
				3	4	5	6	8
2" x 3" x 0.045" Tube	10	20	20	7'-0"	6'-1"	5'-4"	5'-1"	4'-3"
			30	5'-8"	5'-0"	4'-4"	4'-2"	-
			40	5'-0"	4'-4"	-	-	-
			50	4'-5"	-	-	-	-
		30	20	6'-7"	5'-8"	4'-10"	4'-6"	-
			30	5'-5"	4'-8"	-	-	-
			40	4'-8"	4'-0"	-	-	-
			50	4'-2"	-	-	-	-
		40	20	6'-3"	5'-3"	4'-5"	-	-
			30	5'-1"	4'-4"	-	-	-
			40	4'-5"	-	-	-	-
			50	-	-	-	-	-
	20	20	20	6'-0"	4'-10"	-	-	-
			30	4'-10"	-	-	-	-
			40	4'-2"	-	-	-	-
			50	-	-	-	-	-
		30	20	6'-5"	5'-5"	4'-7"	4'-2"	-
			30	5'-3"	4'-5"	-	-	-
			40	4'-6"	-	-	-	-
			50	4'-0"	-	-	-	-
		40	20	5'-9"	4'-8"	-	-	-
			30	4'-8"	-	-	-	-
			40	4'-1"	-	-	-	-
			50	-	-	-	-	-

Column Type	Max Roof Span S (ft)	Live Load Gravity (psf)	Wind Load (psf)	AVG Column Spacing W(ft)				
				3	4	5	6	8
3" x 3" x 0.055" Tube	10	20	20	9'-0"	7'-10"	6'-9"	6'-4"	5'-2"
			30	7'-4"	6'-4"	5'-6"	5'-2"	4'-3"
			40	6'-4"	5'-6"	4'-9"	4'-6"	-
			50	5'-8"	5'-0"	4'-3"	4'-0"	-
		30	20	8'-5"	7'-1"	6'-0"	5'-5"	4'-1"
			30	6'-10"	5'-10"	4'-10"	4'-5"	-
			40	6'-0"	5'-0"	4'-2"	-	-
			50	5'-4"	4'-6"	-	-	-
		40	20	7'-10"	6'-5"	5'-2"	4'-6"	-
			30	6'-5"	5'-3"	4'-3"	-	-
			40	5'-6"	4'-6"	-	-	-
			50	5'-0"	4'-1"	-	-	-
	20	20	20	7'-3"	5'-9"	4'-5"	-	-
			30	6'-0"	4'-8"	-	-	-
			40	5'-1"	4'-1"	-	-	-
			50	4'-7"	-	-	-	-
		30	20	8'-0"	6'-8"	5'-5"	4'-10"	-
			30	6'-6"	5'-5"	4'-5"	-	-
			40	5'-8"	4'-8"	-	-	-
			50	5'-1"	4'-2"	-	-	-
		40	20	7'-0"	5'-4"	-	-	-
			30	5'-8"	4'-5"	-	-	-
			40	5'-0"	-	-	-	-
			50	4'-5"	-	-	-	-

Column Type	Max Roof Span S (ft)	Live Load Gravity (psf)	Wind Load (psf)	AVG Column Spacing W(ft)				
				3	4	5	6	8
3" x 3" x 0.090" Tube	10	20	20	10'-0"	9'-5"	8'-1"	7'-8"	6'-3"
			30	8'-9"	7'-8"	6'-7"	6'-3"	5'-2"
			40	7'-7"	6'-8"	5'-9"	5'-5"	4'-5"
			50	6'-10"	6'-0"	5'-2"	4'-10"	-
		30	20	10'-0"	8'-7"	7'-2"	6'-7"	5'-0"
			30	8'-3"	7'-0"	5'-11"	5'-5"	4'-1"
			40	7'-2"	6'-1"	5'-1"	4'-8"	-
			50	6'-5"	5'-5"	4'-7"	4'-2"	-
		40	20	9'-5"	7'-9"	6'-3"	5'-6"	-
			30	7'-8"	6'-4"	5'-2"	4'-6"	-
			40	6'-8"	5'-6"	4'-5"	-	-
			50	6'-0"	5'-0"	-	-	-
	20	20	20	8'-9"	7'-0"	5'-5"	4'-5"	-
			30	7'-2"	5'-8"	4'-5"	-	-
			40	6'-2"	5'-0"	-	-	-
			50	5'-7"	4'-5"	-	-	-
		30	20	9'-8"	8'-0"	6'-7"	5'-10"	4'-1"
			30	7'-11"	6'-7"	5'-5"	4'-10"	-
			40	6'-10"	5'-8"	4'-8"	4'-2"	-
			50	6'-1"	5'-1"	4'-2"	-	-
		40	20	8'-5"	6'-7"	5'-0"	-	-
			30	6'-11"	5'-4"	4'-0"	-	-
			40	6'-0"	4'-8"	-	-	-
			50	5'-4"	4'-2"	-	-	-

NOTES FOR ALL TABLES

- 1) ROOF SPAN IS TOTAL CLEAR ROOF SPAN ACTING ON EAVE BEAM AS NOTED ON ISOMETRIC DETAIL, SHEET S1.
- 2) LIMITING VALUES MAY BE HIGHER THAN COLUMN SPACING DUE TO AVERAGING OF ADJACENT BAYS.
- 3) 2015 ALUMINUM DESIGN MANUAL, ALLOWABLE STRESS DESIGN METHOD USED IN ALL TABLES.
- 4) USE APPROPRIATE VALUES REQUIRED BY THE GOVERNING BUILDING CODES. VERIFY REQUIREMENTS WITH BUILDING DEPARTMENT BEFORE USE.
- 5) 6005-T5 ALUMINUM ALLOY OR BETTER USED IN TABLES.
- 6) DEFLECTION LIMIT = L/60 USED IN TABLES.
- 7) COLUMN SPACING IS HALF THE DISTANCE TO THE LEFT ADDED TO HALF THE DISTANCE TO THE RIGHT OF THE COLUMN (AVERAGE COLUMN SPACING, SEE ILLUSTRATION).
- 8) VALUES BELOW ALLOWABLE CEILING HEIGHT INTENDED TO BE BUILT ON KNEEWALLS OR OTHER SUPPORTING STRUCTURES (SUPPORTING STRUCTURES CERTIFIED BY OTHERS).
- 9) LOAD TABLES TO BE SELECTED BY A SITE SPECIFIC DESIGN PROFESSIONAL.

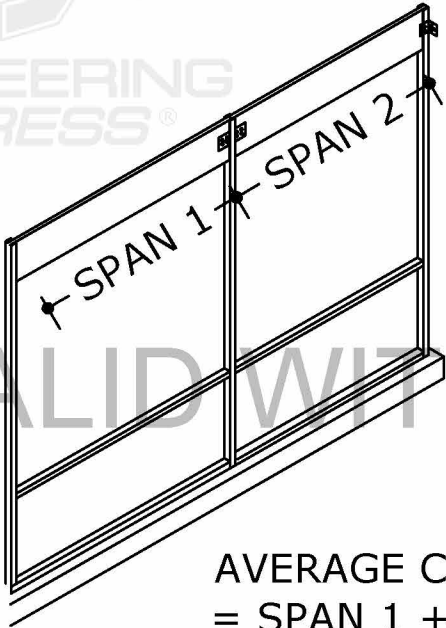

AVERAGE COLUMN SPACING
= SPAN 1 + SPAN 2 / 2

PE SEAL
REQUIRED
03/12/2021

CERTIFYING ENGINEER AND CERT OF AUTH AS LISTED ON STAMP
VALID FOR 1 PERMIT ONLY U.N.O.
DIGITAL SEAL NOTICE:
IF THIS DOCUMENT IS DIGITALLY SIGNED, THIS SHEET IS PART OF A DIGITALLY SIGNED FILE. IT SHALL REMAIN IN DIGITAL FORMAT, SHALL BE VERIFIED BY ELECTRONIC MEANS, & PRINTED COPIES OF THIS DOCUMENT ARE NOT CONSIDERED SIGNED AND SEALED.
PRINTED DOCUMENT NOTICE:
IF THIS DOCUMENT IS PRINTED & DOES NOT CONTAIN AN ENGINEER'S ORIGINAL SIGNATURE & SEAL, THIS DOCUMENT IS VOID & NOT VALID FOR USE. PHOTOCOPIES ARE NOT PERMITTED FOR USE.

ENGINEERINGEXPRESS®
CORPORATE OFFICE:
160 SW 12TH AVE, SUITE 106
DEERFIELD BEACH, FL 33442
(954) 354-0660 | (866) 396-9999
TEAM@ENGINEERINGEXPRESS.COM
ENGINEERINGEXPRESS.COM

SUPERIOR MASON PRODUCTS
451 INDUSTRIAL LANE
BIRMINGHAM, AL
(631) 563-4000
SCREEN ROOM AND EPS PANEL ROOF
MASTER PLAN SHEET

REMARKS	DRWN	CHKD	DATE
INIT ISSUE	TT	FLB	1/10/20
2020 FEB	FLB	COB	3/12/21

THIS DOCUMENT IS THE PROPERTY OF ENGINEERING EXPRESS, AND SHALL NOT BE REPRODUCED IN WHOLE OR PART WITHOUT WRITTEN CONSENT OF ENGINEERING EXPRESS. ALTERATIONS, ADDITIONS, OR OTHER MARKINGS TO THIS DOCUMENT ARE NOT PERMITTED AND INVALIDATE OUR CERTIFICATION.

20-30634
SCALE: NTS UNLESS NOTED
4 OF 5

CARRY BEAM ALLOWABLE SPAN TABLE:

BEAM TYPE	ROOF LOAD (PSF)	MAX BEAM SPAN				
		3	4	5	6	8
2" x 3" x 0.045" Tube	20	9'-4"	8'-6"	7'-11"	7'-5"	6'-7"
	30	7'-7"	7'-0"	6'-5"	6'-0"	5'-5"
	40	6'-7"	6'-0"	5'-7"	5'-3"	4'-8"
	50	5'-11"	5'-5"	5'-0"	4'-8"	4'-2"

BEAM TYPE	ROOF LOAD (PSF)	MAX BEAM SPAN				
		3	4	5	6	8
3" x 3" x 0.055" Tube	20	11'-1"	10'-1"	9'-4"	8'-9"	7'-10"
	30	9'-0"	8'-3"	7'-8"	7'-2"	6'-5"
	40	7'-10"	7'-2"	6'-7"	6'-2"	5'-6"
	50	7'-0"	6'-5"	6'-0"	5'-6"	5'-0"

BEAM TYPE	ROOF LOAD (PSF)	MAX BEAM SPAN				
		3	4	5	6	8
3" x 3" x 0.090" Tube	20	13'-3"	12'-1"	11'-2"	10'-6"	9'-4"
	30	10'-10"	9'-11"	9'-2"	8'-7"	7'-8"
	40	9'-4"	8'-7"	8'-0"	7'-5"	6'-8"
	50	8'-5"	7'-8"	7'-1"	6'-8"	6'-0"

WIND SPEED TO PRESSUE CONVERSION GUIDE

WIND SPEED (MPH)	ASCE EXPOSURE CATEGORY	WALL PRESSURE ZONES			
		ZONE 4		ZONE 5	
		UP (+)	DOWN (-)	UP (+)	DOWN (-)
120	B	8.9	-13.8	8.9	-17.1
	C	13.1	-20.4	13.1	-25.2
	D	15.9	-24.8	15.9	-30.6
130	B	10.4	-16.2	10.4	-20.0
	C	15.4	-24.0	15.4	-29.6
	D	18.6	-29.1	18.6	-35.9
140	B	12.1	-18.8	12.1	-23.2
	C	17.8	-27.8	17.8	-34.3
	D	21.6	-33.7	21.6	-41.7
150	B	13.8	-21.6	13.8	-26.7
	C	20.4	-31.9	20.4	-39.4
	D	24.8	-38.7	24.8	-47.8
160	B	15.8	-24.6	15.8	-30.4
	C	8.2	-12.8	8.2	-15.8
	D	28.2	-44.1	28.2	-54.4
170	B	17.8	-27.8	17.8	-34.3
	C	26.3	-41.0	26.3	-50.6
	D	31.9	-49.8	31.9	-61.4

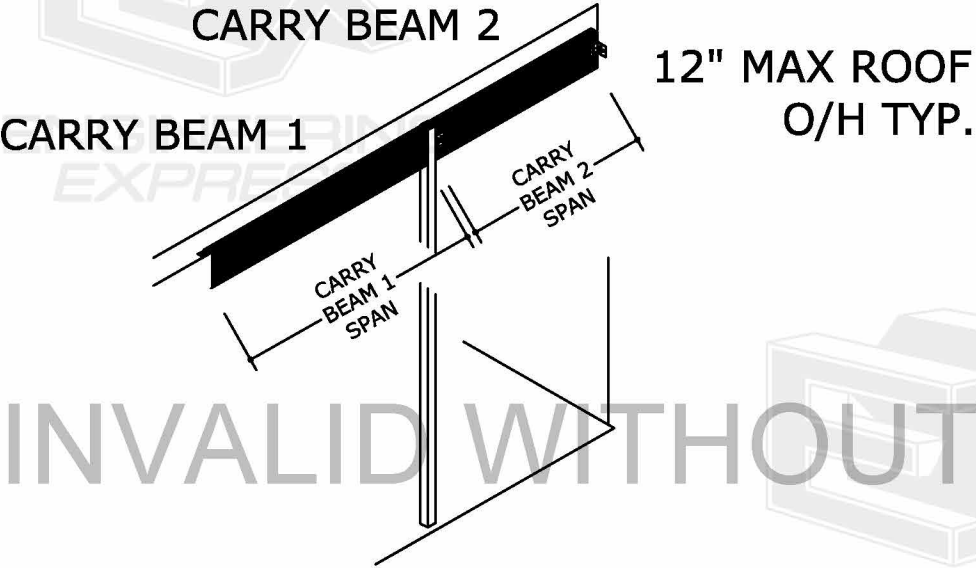

CARRY BEAM SPAN DEFINED:
EACH CARRY BEAM SHALL BE DESIGNED SEPARATELY

COPIES NOT VALID FOR PERMIT

03/12/2021

CERTIFYING ENGINEER AND CERT OF AUTH AS LISTED ON STAMP

VALID FOR 1 PERMIT ONLY U.N.O

DIGITAL SEAL NOTICE:
IF THIS DOCUMENT IS DIGITALLY SIGNED, THIS SHEET IS PART OF A DIGITALLY SIGNED FILE. IT SHALL REMAIN IN DIGITAL FORMAT, SHALL BE VERIFIED BY ELECTRONIC MEANS, & PRINTED COPIES OF THIS DOCUMENT ARE NOT CONSIDERED SIGNED AND SEALED.

PRINTED DOCUMENT NOTICE:
IF THIS DOCUMENT IS PRINTED & DOES NOT CONTAIN AN ENGINEER'S ORIGINAL SIGNATURE & SEAL, THIS DOCUMENT IS VOID & NOT VALID FOR USE. PHOTOCOPIES ARE NOT PERMITTED FOR USE.

ENGINEERING EXPRESS®

CORPORATE OFFICE:
160 SW 12th AVE, SUITE 106
DEERFIELD BEACH, FL 33442
(954) 354-0660 | (866) 396-9999
TEAM@ENGINEERINGEXPRESS.COM
ENGINEERINGEXPRESS.COM

SUPERIOR MASON PRODUCTS

451 INDUSTRIAL LANE
BIRMINGHAM, AL
(631) 563-4000

SCREEN ROOM AND EPS PANEL ROOF
MASTER PLAN SHEET

DRWN	CHKD	DATE
TT	FLB	1/10/20
FLB	COB	3/12/21

REMARKS
2020 FEB

THIS DOCUMENT IS THE PROPERTY OF ENGINEERING EXPRESS, AND SHALL NOT BE REPRODUCED IN WHOLE OR PART WITHOUT WRITTEN CONSENT OF ENGINEERING EXPRESS. ALTERATIONS, ADDITIONS, OR OTHER MARKINGS TO THIS DOCUMENT ARE NOT PERMITTED AND INVALIDATE OUR CERTIFICATION.

COPYRIGHT ENGINEERING EXPRESS®

20-30634

SCALE: NTS UNLESS NOTED

5