

KE DURASOL GENNIUS PERGOLA SYSTEMS

GENNIUS PERGOLA SYSTEM MASTER PLAN

A2C MODEL

NOTES:

KE DURASOL GENNIUS PERGOLA SYSTEM WITH RETRACTABLE FABRIC SHALL BE INSTALLED PER MANUFACTURER'S SPECIFICATION.

- PERGOLA FABRIC SHALL BE RETRACTED PRIOR TO HIGH WIND EVENTS (WIND 40MPH+) AS OUTLINED HEREIN.
- FABRIC TO BE RETRATED DURING ALL TIMES OF SNOW, ICE, AND FREEZING RAIN
- PERGOLA FABRIC AND MECHANICAL CERTIFICATION IS BEYOND THE SCOPE OF THIS CERTIFICATION.
- THE AWNING OWNER SHALL BE NOTIFIED OF THESE CONDITIONS BY THE PERMIT HOLDER. USE OF THIS PLAN BY THE CONTRACTOR CONSENTS TO WRITTEN NOTIFICATION TO THE END USER THE TERMS LISTED HEREIN.
- REFER TO AFOREMENTIONED MANUFACTURER ISSUED ASSEMBLY MANUAL FOR ALL CONNECTION DETAILS THAT ARE NOT ILLUSTRATED HEREIN.

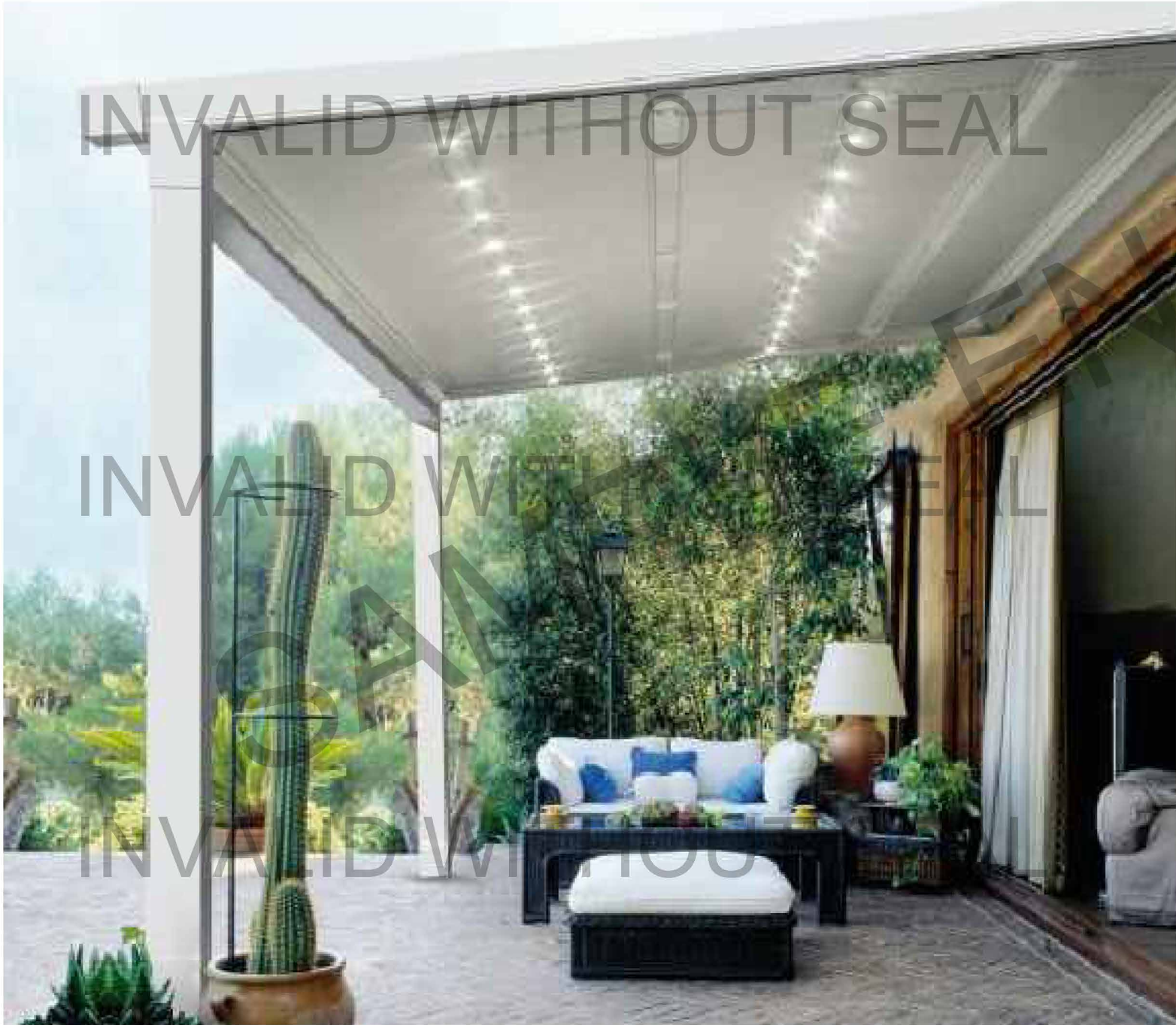

DESIGN NOTES:

ALLOWABLE DESIGN PRESSURES FOR CANOPY ARE TO BE BE AS LISTED IN DESIGN SCHEDULES HEREIN. FOR ALL INSTALLATION CONDITIONS, FABRIC ROOF IS TO BE RETRACTED WHEN WIND SPEEDS REACH 40+ MPH. PER THIS DOCUMENT, SITE SPECIFIC CONDITIONS ARE NOT TO EXCEED 130 MPH WIND SPEEDS, EXPOSURE C (WITHIN 1000 FT OF COASTLINE), OR RISK CATEGORY 1. IF THESE CONDITIONS ARE EXCEEDED, ADDITIONAL ENGINEERING MAY BE REQUIRED

THE CONTRACTOR SHALL CONTACT THE AUTHORITY HAVING JURISDICTION TO ENSURE APPROPRIATE CRITERIA TO BE USED BEFORE CONSTRUCTION BEGINS.  
DESIGN DEAD LOAD = 2 PSF  
DESIGN LIVE LOAD = 0 PSF (WIND LOADING ONLY CONSIDERED - SEE DESIGN SCHEDULES)

GENERAL NOTES:

- THIS SYSTEM HAS BEEN DESIGNED AND SHALL BE FABRICATED IN ACCORDANCE WITH THE REQUIREMENTS OF THE FLORIDA BUILDING CODE 7TH EDITION (2020). ALSO APPLICABLE FOR THE FBC 6TH EDITION (2017), IBC/IRC (2015 & 2018), AS WELL AS CURRENT VERSIONS OF THE MN, NC, NJ, NY, OH, SC, & VA BUILDING CODES AS APPLICABLE. CODE ENFORCED COMPLIES WITH STATE OF SEAL AND IF MULTIPLE VERSIONS ARE LISTED THEN MOST STRINGENT APPLIES. DESIGN SHALL UTILIZE ASD DESIGN METHOD USING ASCE 7-16 OR ASCE 7-10 CODES FOR SITE SPECIFIC APPLICATIONS AS APPLICABLE. DESIGN CRITERIA OR SPANS BEYOND STATED HEREIN MAY REQUIRE ADDITIONAL SITE SPECIFIC SEALED ENGINEERING.
- PRODUCT APPROVED FOR USE IN SEISMIC DESIGN CATEGORY A PER REQUIREMENTS OF ASCE 7-16 AND CALIFORNIA BUILDING CODE 2019. FOR SEISMIC DESIGN CATEGORY B-F AND ANY CONCRETE CONNECTIONS, ADDITIONAL REVIEW BY THIRD-PARTY ENGINEERS IS REQUIRED FOR THE VALIDITY OF THE DESIGN.
- NO 33-1/3% INCREASE IN ALLOWABLE STRESS HAS BEEN USED IN THE DESIGN OF THIS SYSTEM. WIND LOAD DURATION FACTOR  $C_d=1.6$  HAS BEEN USED FOR WOOD ANCHOR DESIGN.
- THE ARCHITECT/ENGINEER OF RECORD FOR THE PROJECT SUPERSTRUCTURE WITH WHICH THIS DESIGN IS USED SHALL BE RESPONSIBLE FOR THE INTEGRITY OF ALL SUPPORTING SURFACES TO THIS DESIGN WHICH SHALL BE COORDINATED BY THE PERMITTING CONTRACTOR.
- THE SYSTEM DETAILED HEREIN IS GENERIC AND DOES NOT PROVIDE INFORMATION FOR A SPECIFIC SITE. FOR SITE CONDITIONS DIFFERENT FROM THE CONDITIONS DETAILED HEREIN, A LICENSED ENGINEER OR REGISTERED ARCHITECT SHALL PREPARE SITE SPECIFIC DOCUMENTS FOR USE IN CONJUNCTION WITH THIS DOCUMENT.
- THE CONTRACTOR SHALL CAREFULLY CONSIDER POSSIBLE IMPOSING LOADS ON ROOF, INCLUDING BUT NOT LIMITED TO ANY CONCENTRATED LOADS WHICH MAY JUSTIFY GREATER DESIGN CRITERIA. THIS ADDITIONAL ROOF LOAD CRITERIA SHALL BE PROPERLY ANALYZED BY A LICENSED ENGINEER OR REGISTERED ARCHITECT.
- FABRIC AND FABRIC ATTACHMENT/SLIDING SYSTEM AND OPERABILITY ARE OUTSIDE THE SCOPE OF THIS CERTIFICATION.
- ALL FASTENERS TO BE #14 OR GREATER SAE GRADE 5 UNLESS NOTED OTHERWISE. FASTENERS SHALL BE CADMIUM-PLATED OR OTHERWISE CORROSION-RESISTANT MATERIAL AND SHALL COMPLY WITH "SPECIFICATIONS FOR ALUMINUM STRUCTURES" SECTION 5.2.1 BY THE ALUMINUM ASSOCIATION, INC., & ANY APPLICABLE FEDERAL, STATE, AND/OR LOCAL CODES.
- FOR ALUMINUM MEMBERS ALL ANCHORS SHALL BE SPACED WITH 2xDIAMETER END DISTANCE AND 2.5xDIAMETER MIN. SPACING TO ADJACENT ANCHORS, UNLESS NOTED OTHERWISE.
- ANCHORS SHALL BE INSTALLED IN ACCORDANCE WITH MANUFACTURERS' RECOMMENDATIONS. MINIMUM EMBEDMENT SHALL BE AS NOTED HEREIN. MINIMUM EMBEDMENT AND EDGE DISTANCE EXCLUDES STUCCO, FOAM, BRICK, AND OTHER WALL FINISHES.
- ALL CONCRETE ANCHORS SHALL BE INSTALLED TO NON-CRACKED CONCRETE ONLY.
- WOOD HOST STRUCTURE & ALL WOOD MEMBERS SHALL BE "SOUTHERN YELLOW PINE"  $G=0.55$  OR GREATER DENSITY.
- THE CONTRACTOR IS RESPONSIBLE TO INSULATE ALL MEMBERS FROM DISSIMILAR MATERIALS TO PREVENT ELECTROLYSIS, I.E. ALUMINUM PER THE CODES AND STANDARDS STATED HEREIN
- ALL ALUMINUM SHALL BE 6061-T6 ALLOY AND TEMPER UNLESS NOTED OTHERWISE.
- ALL CONCRETE AND EPOXY TO REACH A MINIMUM COMPRESSIVE STRENGTH OF 3000 PSI IN 7 DAYS.
- THIS SYSTEM IS ONLY APPROVED FOR FROST PROTECTION WHEN THE TOTAL AREA OF THE STRUCTURE DES NOT EXCEED 600 SQUARE FEET WITH AN EAVE HEIGHT OF 10 FEET OR LESS, PER IBC 403. FOR USE WITH ANY OTHER CONFIGURATION REQUIRING FROST CERTIFICATION, THIS ENGINEER SHALL BE CONTACTED FOR FURTHER DESIGN CRITERIA. THIS SYSTEM HAS NOT BEEN DESIGNED FOR USE WITH FROZEN SOILS OR FILL. ANY FILL PLACED FOR FOUNDATION SUPPORT WITH THIS DESIGN SHALL BE PROTECTED AGAINST FREEZING TEMPERATURES BY OTHERS. PROPER PRECAUTIONS SHALL ALSO BE TAKEN TO PREVENT FROST PENETRATION BENEATH THE FOUNDATIONS FOLLOWING CONSTRUCTION WHICH IS OUTSIDE THE SCOPE OF THIS DOCUMENT CERTIFICATION.
- ENGINEER SEAL AFFIXED HERETO VALIDATES STRUCTURAL DESIGN AS SHOWN ONLY. USE OF THIS SPECIFICATION BY CONTRACTOR, et. al. INDEMNIFIES & SAVES HARMLESS THIS ENGINEER FOR ALL COST & DAMAGES INCLUDING LEGAL FEES & APPELLATE FEES RESULTING FROM MATERIAL FABRICATION, SYSTEM ERECTION, & CONSTRUCTION PRACTICES BEYOND THAT WHICH IS CALLED FOR BY LOCAL, STATE, & FEDERAL CODES & FROM DEVIATIONS OF THIS PLAN.
- EXCEPT AS EXPRESSLY PROVIDED HEREIN, NO ADDITIONAL CERTIFICATIONS OR AFFIRMATIONS ARE INTENDED.
- ALTERATIONS, ADDITIONS, HIGHLIGHTING, OR OTHER MARKINGS TO THIS DOCUMENT ARE NOT PERMITTED AND INVALIDATE THIS CERTIFICATION.

VISIT [ECALC.IO/35090](https://ecalculator.com/35090)

FOR ENGINEER CERTIFIED ORIGINALS  
& MORE INFORMATION ABOUT THIS DOCUMENT  
OR SCAN THIS QR CODE

VISIT [ENGINEERINGEXPRESS.COM/STORE](https://engineeringexpress.com/store)  
FOR ADDITIONAL PLANS, REPORTS & RESOURCES



COPIES NOT VALID FOR PERMIT

COPIES NOT VALID FOR PERMIT

CERTIFYING ENGINEER AND CERT  
OF AUTH AS LISTED ON STAMP

VALID FOR 1 PERMIT ONLY U.N.O.

**DIGITAL SEAL NOTICE:**  
IF THIS DOCUMENT IS DIGITALLY  
SIGNED, THIS SHEET IS PART OF A  
DIGITALLY SIGNED FILE. IT SHALL  
REMAIN IN DIGITAL FORMAT, SHALL  
BE VERIFIED BY ELECTRONIC MEANS,  
& PRINTED COPIES OF THIS  
DOCUMENT ARE NOT CONSIDERED  
SIGNED AND SEALED.

**PRINTED DOCUMENT NOTICE:**  
IF THIS DOCUMENT IS PRINTED &  
DOES NOT CONTAIN AN ENGINEER'S  
ORIGINAL SIGNATURE & SEAL, THIS  
DOCUMENT IS VOID & NOT VALID FOR  
USE. PHOTOCOPIES ARE NOT  
PERMITTED FOR USE.



CORPORATE OFFICE:  
160 SW 12th AVE, SUITE 106  
DEERFIELD BEACH, FL 33442  
(954) 354-0660 | (866) 396-9999  
TEAM@ENGINEERINGEXPRESS.COM  
ENGINEERINGEXPRESS.COM

KE USA INC

38 POND LN, STE B

MIDDLEBURY, VT

(802) 388-7309

KE DURASOL

GENIUS PERGOLA SYSTEMS

A2C MODEL MASTER PLAN

REMARKS

DATE

4/27/16

4/08/21

4/08/21

4/08/21

4/08/21

COPYRIGHT ENGINEERING EXPRESS®

20-35090

SCALE: NTS UNLESS NOTED

1

OF 1



C:\Users\oolby\Engineering\Express\Production - Documents\Projects\20-35090 KE Durasol Genius Pergola System\WP\Drawings & CAD\20-35090 - A2C - Durasol Genius Pergola.dwg 04/28/2021 - 9:23am oolby

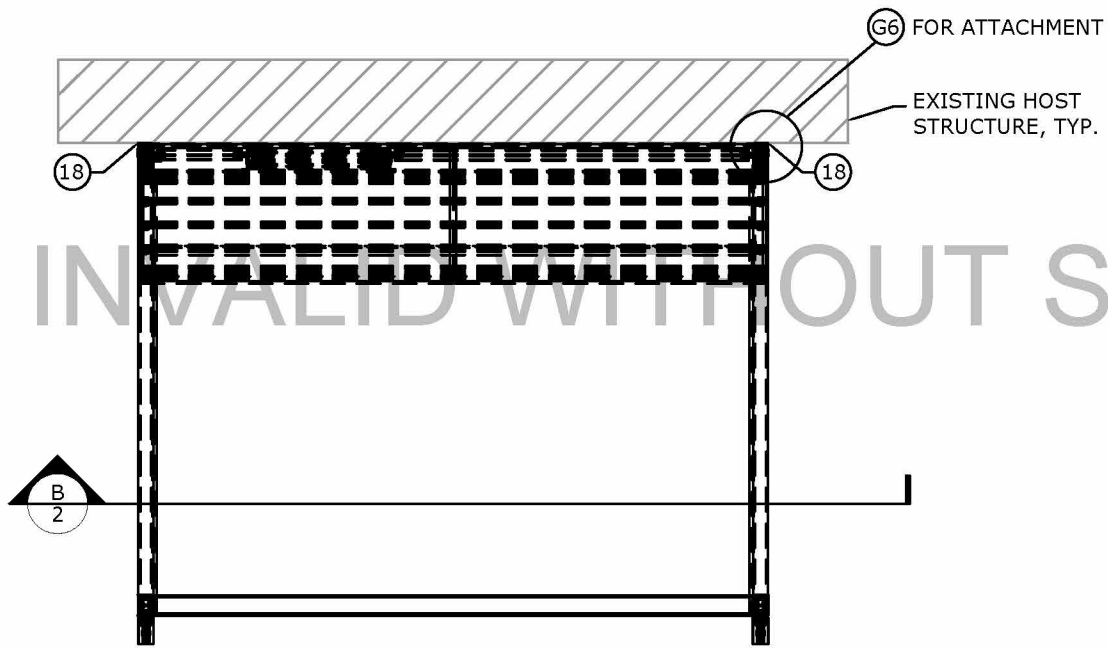

**A**  
2  
HOST MOUNTED PERGOLA PLAN  
1/4" = 1'-0"  
PLAN VIEW

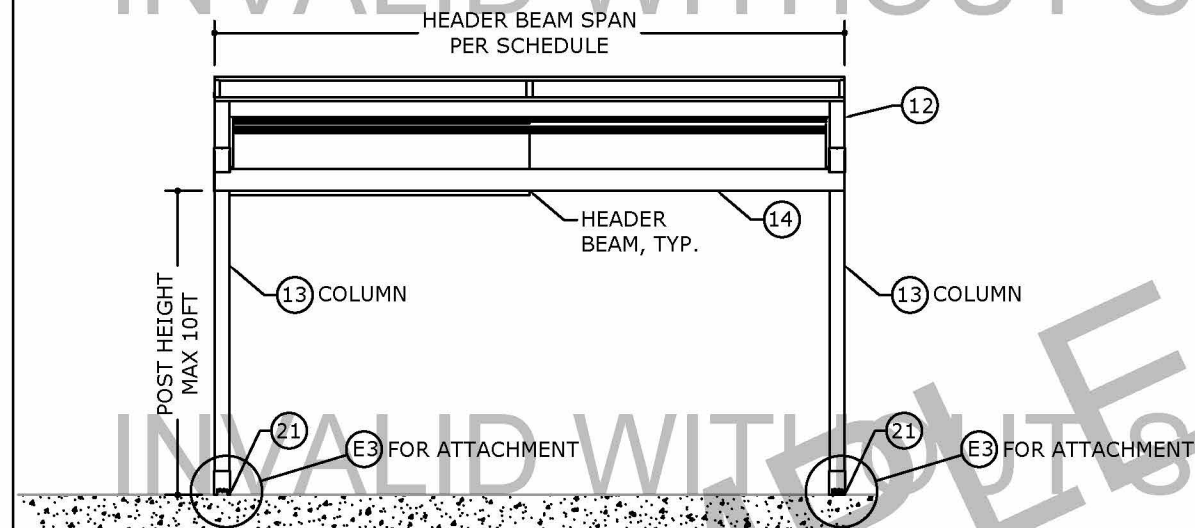

**B**  
2  
PERGOLA FRONT ELEVATION  
1/4" = 1'-0"  
ELEVATION

**ANCHOR SCHEDULE:**

LOCATION	HOST STRUCTURE	DESIGNATION	DESCRIPTION	QUANTITY
WALL BRACKET TO HOST	3000 PSI CONCRETE	ANCHOR TYPE #1	DEWALT SCREW BOLT 3/8" DIAMETER CARBON STEEL W/ 2.5" EMBEDMENT INTO HOST, 3.3" SPACING, 6" EDGE DISTANCE	2
WALL BRACKET TO HOST	3000 PSI CONCRETE	ANCHOR TYPE #2	HILTI KWIK-BOLT 3 ANCHOR, 3/8" DIAMETER CARBON STEEL W/ 2" EMBEDMENT INTO HOST, 3.3" SPACING, 6" EDGE DISTANCE	2
WALL BRACKET TO HOST	WOOD #2 SYP (G=0.55)	ANCHOR TYPE #3	STAINLESS STEEL 3/8" DIAMETER WOOD LAG SCREW W/ 2.8" THREAD PENETRATION, 2" EDGE DISTANCE	3
BASE BRACKET TO FOUNDATION	3000 PSI CONCRETE	ANCHOR TYPE #1	DEWALT SCREW BOLT 3/8" DIAMETER CARBON STEEL W/ 2.5" EMBEDMENT INTO HOST, 2.75" SPACING, 6" EDGE DISTANCE	4
BASE BRACKET TO FOUNDATION	3000 PSI CONCRETE	ANCHOR TYPE #2	HILTI KWIK-BOLT 3 ANCHOR, 3/8" DIAMETER CARBON STEEL W/ 2" EMBEDMENT INTO HOST, 2.75" SPACING, 6" EDGE DISTANCE	4
BASE BRACKET TO WOOD FRAMING	WOOD #2 SYP (G=0.55)	ANCHOR TYPE #4	STAINLESS STEEL 3/8" DIAMETER WOOD LAG SCREW W/ 3.8" THREAD PENETRATION, 2" EDGE DISTANCE	4

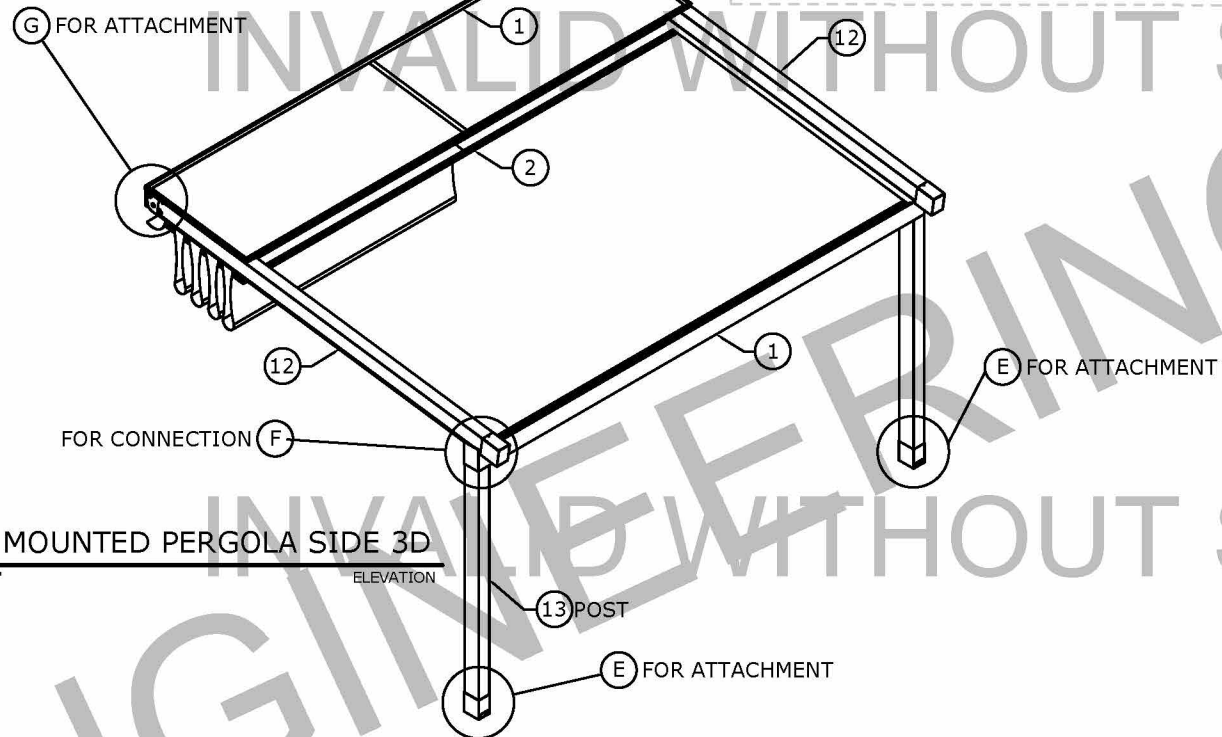

**D**  
2  
HOST MOUNTED PERGOLA SIDE 3D  
1/4" = 1'-0"  
ELEVATION

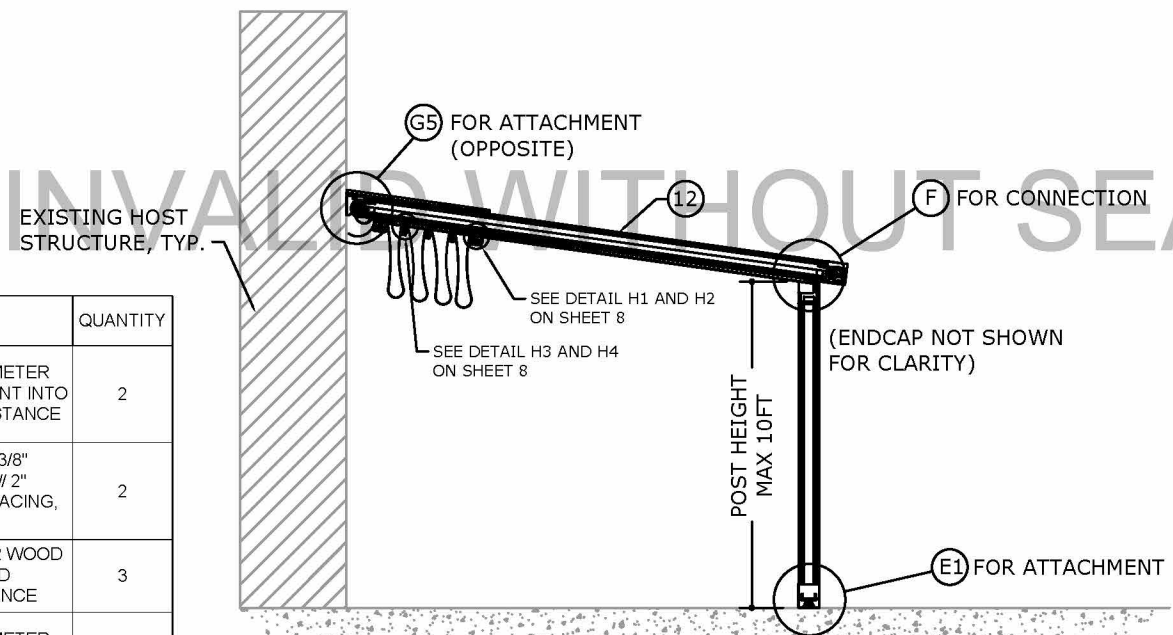

**C**  
2  
HOST MOUNTED PERGOLA  
SIDE ELEVATION  
1/4" = 1'-0"  
ELEVATION

COPIES NOT VALID FOR PERMIT

COPIES NOT VALID FOR PERMIT

CERTIFYING ENGINEER AND CERT OF AUTH AS LISTED ON STAMP  
VALID FOR 1 PERMIT ONLY U.N.O.

**DIGITAL SEAL NOTICE:**  
IF THIS DOCUMENT IS DIGITALLY SIGNED, THIS SHEET IS PART OF A DIGITALLY SIGNED FILE. IT SHALL REMAIN IN DIGITAL FORMAT, SHALL BE VERIFIED BY ELECTRONIC MEANS, & PRINTED COPIES OF THIS DOCUMENT ARE NOT CONSIDERED SIGNED AND SEALED.  
**PRINTED DOCUMENT NOTICE:**  
IF THIS DOCUMENT IS PRINTED & DOES NOT CONTAIN AN ENGINEER'S ORIGINAL SIGNATURE & SEAL, THIS DOCUMENT IS VOID & NOT VALID FOR USE. PHOTOCOPIES ARE NOT PERMITTED FOR USE.

**ENGINEERING EXPRESS®**  
CORPORATE OFFICE:  
160 SW 12th AVE, SUITE 106  
DEERFIELD BEACH, FL 33442  
(954) 354-0660 | (866) 396-9999  
TEAM@ENGINEERINGEXPRESS.COM  
ENGINEERINGEXPRESS.COM

**KE USA INC**  
38 POND LN, STE B  
MIDDLEBURY, VT  
(802) 388-7309  
KE DURASOL  
GENIUS PERGOLA SYSTEMS  
A2C MODEL MASTER PLAN

REMARKS	DRWN	CHKD	DATE
INIT ISSUE	MCC	JCF	4/27/16
2020 FEB	CCB	FLB	4/08/21

THIS DOCUMENT IS THE PROPERTY OF ENGINEERING EXPRESS AND SHALL NOT BE REPRODUCED IN WHOLE OR PART WITHOUT WRITTEN CONSENT OF ENGINEERING EXPRESS. ALTERATIONS, ADDITIONS, OR OTHER MARKINGS TO THIS DOCUMENT ARE NOT PERMITTED AND INVALIDATE OUR CERTIFICATION.

COPYRIGHT ENGINEERING EXPRESS®

20-35090

SCALE: NTS UNLESS NOTED

2



HOST MOUNTED CANOPY - ALLOWABLE WIND PRESSURE SCHEDULES

SCHEDULE 2: 2 GUIDES (1 BAY)

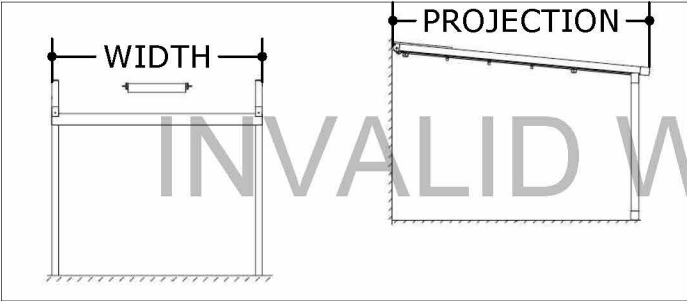

SCHEDULE 2: 2 GUIDES (1 BAY)						
ALLOWABLE WIND PRESSURE (ASD) - PSF						
PROJECTION	TOTAL WIDTH					
	8'2"	9'10"	11'6"	13'1"	14'9"	16'5"
8'2"	± 30 PSF	± 20 PSF	± 14 PSF	± 11 PSF	± 8 PSF	± 6 PSF
9'10"	± 30 PSF	± 20 PSF	± 14 PSF	± 11 PSF	± 8 PSF	± 6 PSF
11'6"	± 30 PSF	± 20 PSF	± 14 PSF	± 11 PSF	± 8 PSF	± 6 PSF
13'1"	± 30 PSF	± 20 PSF	± 14 PSF	± 11 PSF	± 8 PSF	± 6 PSF
14'9"	± 30 PSF	± 20 PSF	± 14 PSF	± 11 PSF	± 8 PSF	± 6 PSF
16'5"	± 30 PSF	± 20 PSF	± 14 PSF	± 11 PSF	± 8 PSF	± 6 PSF
18'1"	± 30 PSF	± 20 PSF	± 14 PSF	± 11 PSF	± 8 PSF	± 6 PSF
19'8"	± 30 PSF	± 20 PSF	± 14 PSF	± 11 PSF	± 8 PSF	± 6 PSF
21'4"	± 30 PSF	± 20 PSF	± 14 PSF	± 11 PSF	± 8 PSF	± 6 PSF
23'0"	± 30 PSF	± 20 PSF	± 14 PSF	± 11 PSF	± 8 PSF	± 6 PSF
23'10"	± 30 PSF	± 20 PSF	± 14 PSF	± 11 PSF	± 8 PSF	± 6 PSF
24'7"	± 30 PSF	± 20 PSF	± 14 PSF	± 11 PSF	± 8 PSF	± 6 PSF
26'3"	± 30 PSF	± 20 PSF	± 14 PSF	± 11 PSF	± 8 PSF	± 6 PSF

SCHEDULE 3: 3 GUIDES (2 BAYS)

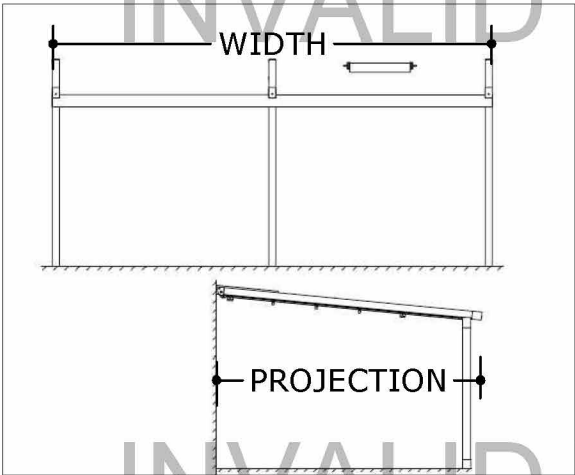

SCHEDULE 3: 3 GUIDES (2 BAYS)									
ALLOWABLE WIND PRESSURE (ASD) - PSF									
PROJECTION	TOTAL WIDTH								
	16'5"	18'1"	19'8"	21'4"	23'0"	24'7"	26'3"	27'10"	29'6"
8'2"	± 30 PSF	± 24 PSF	± 20 PSF	± 17 PSF	± 14 PSF	± 12 PSF	± 11 PSF	± 9 PSF	± 8 PSF
9'10"	± 30 PSF	± 24 PSF	± 20 PSF	± 17 PSF	± 14 PSF	± 12 PSF	± 11 PSF	± 9 PSF	± 8 PSF
11'6"	± 30 PSF	± 24 PSF	± 20 PSF	± 17 PSF	± 14 PSF	± 12 PSF	± 11 PSF	± 9 PSF	± 8 PSF
13'1"	± 30 PSF	± 24 PSF	± 20 PSF	± 17 PSF	± 14 PSF	± 12 PSF	± 11 PSF	± 9 PSF	± 8 PSF
14'9"	± 30 PSF	± 24 PSF	± 20 PSF	± 17 PSF	± 14 PSF	± 12 PSF	± 11 PSF	± 9 PSF	± 8 PSF
16'5"	± 30 PSF	± 24 PSF	± 20 PSF	± 17 PSF	± 14 PSF	± 12 PSF	± 11 PSF	± 9 PSF	± 8 PSF
18'1"	± 30 PSF	± 24 PSF	± 20 PSF	± 17 PSF	± 14 PSF	± 12 PSF	± 11 PSF	± 9 PSF	± 8 PSF
19'8"	± 30 PSF	± 24 PSF	± 20 PSF	± 17 PSF	± 14 PSF	± 12 PSF	± 11 PSF	± 9 PSF	± 8 PSF
21'4"	± 30 PSF	± 24 PSF	± 20 PSF	± 17 PSF	± 14 PSF	± 12 PSF	± 11 PSF	± 9 PSF	± 8 PSF
23'0"	± 30 PSF	± 24 PSF	± 20 PSF	± 17 PSF	± 14 PSF	± 12 PSF	± 11 PSF	± 9 PSF	± 8 PSF
24'7"	± 30 PSF	± 24 PSF	± 20 PSF	± 17 PSF	± 14 PSF	± 12 PSF	± 11 PSF	± 9 PSF	± 8 PSF
26'3"	± 30 PSF	± 24 PSF	± 20 PSF	± 17 PSF	± 14 PSF	± 12 PSF	± 11 PSF	± 9 PSF	± 8 PSF

SCHEDULE 4: 4 GUIDES (3 BAYS)

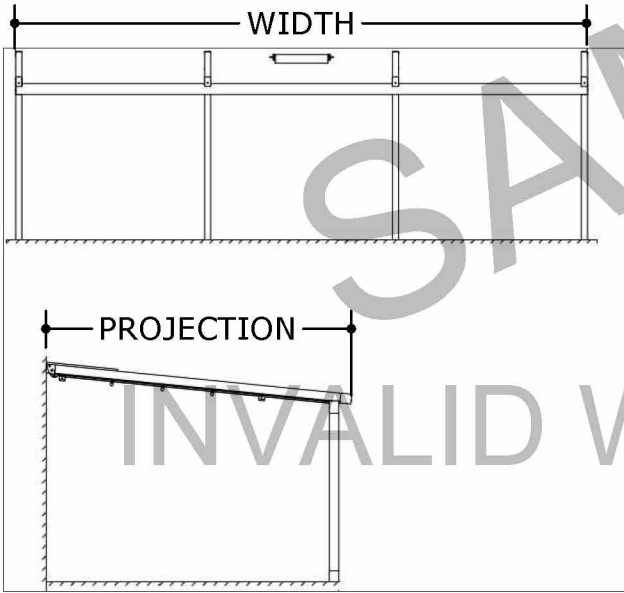

SCHEDULE 4: 4 GUIDES (3 BAYS)								
ALLOWABLE WIND PRESSURE (ASD) - PSF								
PROJECTION	TOTAL WIDTH							
	31'2"	32'9"	34'5"	36'1"	37'8"	39'4"	41'0"	42'8"
8'2"	± 18 PSF	± 16 PSF	± 14 PSF	± 13 PSF	± 12 PSF	± 11 PSF	± 10 PSF	± 9 PSF
9'10"	± 18 PSF	± 16 PSF	± 14 PSF	± 13 PSF	± 12 PSF	± 11 PSF	± 10 PSF	± 9 PSF
11'6"	± 18 PSF	± 16 PSF	± 14 PSF	± 13 PSF	± 12 PSF	± 11 PSF	± 10 PSF	± 9 PSF
13'1"	± 18 PSF	± 16 PSF	± 14 PSF	± 13 PSF	± 12 PSF	± 11 PSF	± 10 PSF	± 9 PSF
14'9"	± 18 PSF	± 16 PSF	± 14 PSF	± 13 PSF	± 12 PSF	± 11 PSF	± 10 PSF	± 9 PSF
16'5"	± 18 PSF	± 16 PSF	± 14 PSF	± 13 PSF	± 12 PSF	± 11 PSF	± 10 PSF	± 9 PSF
18'1"	± 18 PSF	± 16 PSF	± 14 PSF	± 13 PSF	± 12 PSF	± 11 PSF	± 10 PSF	± 9 PSF
19'8"	± 18 PSF	± 16 PSF	± 14 PSF	± 13 PSF	± 12 PSF	± 11 PSF	± 10 PSF	± 9 PSF
21'4"	± 18 PSF	± 16 PSF	± 14 PSF	± 13 PSF	± 12 PSF	± 11 PSF	± 10 PSF	± 9 PSF
23'0"	± 18 PSF	± 16 PSF	± 14 PSF	± 13 PSF	± 12 PSF	± 11 PSF	± 10 PSF	± 9 PSF
24'7"	± 18 PSF	± 16 PSF	± 14 PSF	± 13 PSF	± 12 PSF	± 11 PSF	± 10 PSF	± 9 PSF
26'3"	± 18 PSF	± 16 PSF	± 14 PSF	± 13 PSF	± 12 PSF	± 11 PSF	± 10 PSF	± 9 PSF

SCHEDULE 5: WIND SPEED TO DESIGN PRESSURE FOR HOST ATTACHED CANOPY (ASCE 7-16 CH 30.11)

ULT WIND SPEED	ASCE EXPOSURE CATEGORY	CANOPY ATTACHED 1FT OR MORE BELOW EAVE		CANOPY ATTACHED 1FT OR LESS BELOW EAVE	
		ASD LOAD COMBINATION PRESSURE (+ / -)			
40 MPH	B	6.7 psf	-1.0 psf	6.7 psf	-1.0 psf
	C	6.7 psf	-1.0 psf	6.7 psf	-1.2 psf
50 MPH	B	7.1 psf	-1.0 psf	7.1 psf	-1.8 psf
	C	7.1 psf	-1.0 psf	7.1 psf	-1.8 psf
60 MPH	B	7.6 psf	-1.2 psf	7.6 psf	-3.0 psf
	C	7.6 psf	-1.2 psf	7.6 psf	-3.0 psf
70 MPH	B	8.0 psf	-1.8 psf	8.0 psf	-4.2 psf
	C	8.5 psf	-2.4 psf	8.5 psf	-4.8 psf
80 MPH	B	8.9 psf	-3.0 psf	8.9 psf	-5.4 psf
	C	8.9 psf	-3.0 psf	8.9 psf	-6.6 psf
90 MPH	B	9.4 psf	-3.6 psf	9.4 psf	-7.2 psf
	C	9.8 psf	-4.2 psf	9.8 psf	-8.4 psf
100 MPH	B	10.3 psf	-4.8 psf	10.3 psf	-9.0 psf
	C	10.7 psf	-5.4 psf	10.7 psf	-10.2 psf
110 MPH	B	11.2 psf	-6.0 psf	11.2 psf	-11.4 psf
	C	12.1 psf	-7.2 psf	12.1 psf	-12.6 psf
120 MPH	B	12.5 psf	-7.8 psf	12.5 psf	-13.8 psf
	C	13.0 psf	-8.4 psf	13.0 psf	-15.6 psf
130 MPH	B	13.4 psf	-9.0 psf	13.4 psf	-16.2 psf
	C	14.3 psf	-10.2 psf	14.3 psf	-18.0 psf

VISIT [ECALC.IO/WIND](https://ecalculator.io/wind) TO ORDER ENGINEER-CERTIFIED WIND SPEED TO WIND PRESSURE CALCULATIONS FOR PERMIT USE OUR ONLINE CALCULATORS WITH BETTER ANSWERS HELPFUL EXPLANATIONS & MORE WIND RESOURCES



OR SCAN THIS CODE

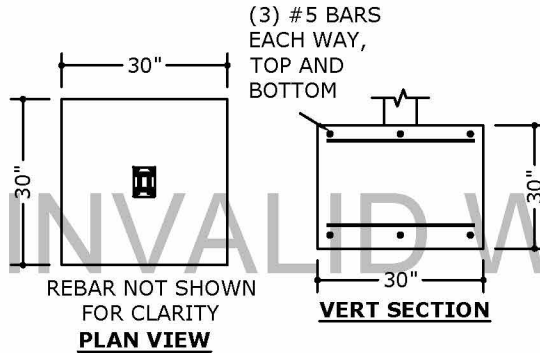

1 3 TYPICAL FOOTER N.T.S.

COPIES NOT VALID FOR PERMIT

COPIES NOT VALID FOR PERMIT

SCHEDULE 2-5 NOTES:

- LOADING VALUES SHOWN ARE ASD LOAD COMBINATIONS WHICH REPRESENT ABSOLUTE MINIMUM DESIGN REQUIRED FOR THIS STRUCTURE. NOTE THAT DURING ANY WIND, RAIN, OR WEATHER EVENT, PERGOLA FABRIC IS TO BE RETRACTED.
- LOAD COMBINATIONS CONSIDER ONLY A SELF IMPOSED DEAD LOAD OF +2 PSF & NO LIVE LOADING. NO 10PSF MINIMUM HAS BEEN ASSUMED HEREIN.
- WIND PRESSURES ARE TO BE DETERMINED ON A SITE SPECIFIC BASIS PER ASCE 7 ROOF OVER OPEN STRUCTURE WITH OBSTRUCTED WIND FLOW DESIGN CRITERIA PER THE CODES STATED HEREIN
- WIND LOADS SHOWN INCLUDE REDUCTION TO CONSIDER POROSITY OF STRUCTURE. NO FURTHER REDUCTIONS ARE TO BE TAKING FOR POROSITY CONSIDERATION.
- DESIGN PROFESSIONAL SHALL CONSIDER ALL FORCES, INCLUDING SNOW LOADS PER GOVERNING BUILDING CODES.
- DEFLECTION LIMIT FOR HOST-ATTACHED PERGOLA TAKEN AS L/60 FOR THESE CALCULATIONS.
- THE ASCE 7-16 MINIMUM WIND PRESSURE LOADING OF 10 PSF HAS NOT BEEN APPLIED HEREIN. FOR INSTALLATIONS RATED TO LESS THAN 5 PSF, FABRC IS TO REMAIN RETRACTED AT ALL TIMES WHEN NOT IN USE. VERIFY ANY LIMITATION ACCEPTANCE WITH LOCAL BUILDING OFFICIAL.
- IT SHALL BE THE USER'S RESPONSIBILITY TO FULLY RETRACT THE FABRIC IN THE EVENT OF A WIND STORM (FOR ALL INSTALLATION CONDNTIONS).
- SCHEDULE 5: WIND SPEED & EXPOSURE TO WIND PRESSURE MAY BE USED DIRECTLY WITH THE INCLUDED DESIGN SCHEDULES, BUT ASSUMES NO ADDITIONAL LOADING IS APPLIED (INCLUDING ADDITIONAL DEAD, LIVE, SNOW, RAIN, OR SEISMIC LOADS). ADDITIONAL SITE-SPECIFIC DESIGN PRESSURE CALCULAITONS MAY BE REQUIRED PER THE AUTHORITY HAVING JURISDICTION.
- FOR INSTALLATION CONDITIONS EXCEEDING THE ALLOWABLE PRESSURES LISTED HEREIN, ADDITIONAL ENGINEERING MAY BE REQUIRED.

FOOTER NOTES:

- PROVIDES THE REQUIRED FOOTER REINFORCEMENT FOR THE RESPECTIVE FOOTER SIZE.
- REQUIRED REINFORCEMENT IS BASED ON 30" DEEP FOOTERS.
- ALL REINFORCEMENT SHALL HAVE A MINIMUM CLEAR COVER OF 3".
- ALL REINFORCEMENT SHALL BE DEFORMED BARS OF INTERMEDIATE GRADE NEW BILLET STEEL CONFORMING TO CURRENT REQUIREMENTS OF ASTM A615, GRADE 60 (U.N.O.), FREE FROM OIL, LOOSE SCALE AND LOOSE RUST, AND BENT, LAPPED, PLACED, SUPPORTED AND FASTENED ACCORDING TO THE "ACI DETAILING MANUAL" AND ACI 318. ALL STEEL SHALL BE SECURELY HELD IN PLACE DURING POURING OF CONCRETE. IF REQUIRED, ADDITIONAL BARS SHALL BE PROVIDED BY THE GENERAL CONTRACTOR TO FURNISH SUPPORT FOR ALL BARS ADHERE TO ALL JURISDICTIONS THAT REQUIRE FOOTINGS PLACED BELOW THE FROSTLINE. IN CASES THAT APPLY, THE BOTTOM 6" OF THICKENED EDGE MUST BE BELOW THE FROSTLINE OR DESIGNED PER ASCE 7-32.
- 

CERTIFYING ENGINEER AND CERT OF AUTH AS LISTED ON STAMP

VALID FOR 1 PERMIT ONLY U.N.O.  
**DIGITAL SEAL NOTICE:** IF THIS DOCUMENT IS DIGITALLY SIGNED, THIS SHEET IS PART OF A DIGITALLY SIGNED FILE. IT SHALL REMAIN IN DIGITAL FORMAT, SHALL BE VERIFIED BY ELECTRONIC MEANS, & PRINTED COPIES OF THIS DOCUMENT ARE NOT CONSIDERED SIGNED AND SEALED.  
**PRINTED DOCUMENT NOTICE:** IF THIS DOCUMENT IS PRINTED & DOES NOT CONTAIN AN ENGINEER'S ORIGINAL SIGNATURE & SEAL, THIS DOCUMENT IS VOID & NOT VALID FOR USE. PHOTOCOPIES ARE NOT PERMITTED FOR USE.

**ENGINEERING EXPRESS**  
CORPORATE OFFICE:  
160 SW 12th AVE, SUITE 106  
DEERFIELD BEACH, FL 33442  
(954) 354-0660 | (866) 396-9999  
TEAM@ENGINEERINGEXPRESS.COM  
ENGINEERINGEXPRESS.COM

**KE USA INC**  
38 POND LN, STE B  
MIDDLEBURY, VT  
(802) 388-7309  
KE DURASOL  
GENIUS PERGOLA SYSTEMS  
A2C MODEL MASTER PLAN

DRWN	CHKD	DATE	INIT	ISSUE	MCC	JCF	COB	FLB	2020	FBC
		4/27/16								
		4/08/21								

REMARKS: THIS DOCUMENT IS THE PROPERTY OF ENGINEERING EXPRESS AND SHALL NOT BE REPRODUCED IN WHOLE OR PART WITHOUT WRITTEN CONSENT OF ENGINEERING EXPRESS. ALTERATIONS, ADDITIONS OR OTHER MARKINGS TO THIS DOCUMENT ARE NOT PERMITTED AND INVALIDATE OUR CERTIFICATION.

COPYRIGHT ENGINEERING EXPRESS®

20-35090  
SCALE: NTS UNLESS NOTED

3



A2C CANOPY - PARTS LIST

COPIES NOT VALID FOR PERMIT

COPIES NOT VALID FOR PERMIT

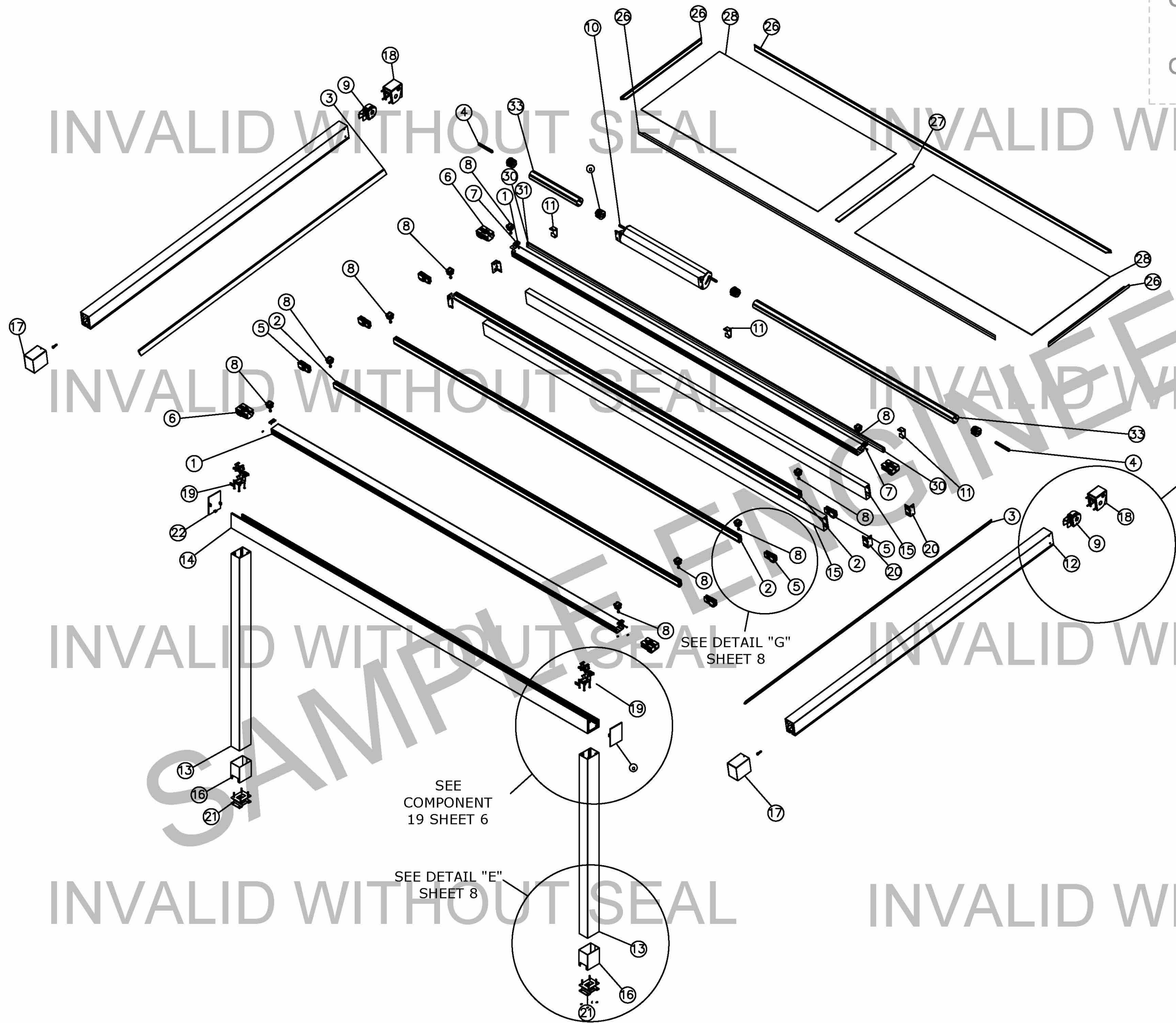

33	CIRCULAR TUBE	820.00.70.01	2
32P	NOT USED	762.00.00.00	-
31	SINGLE PROFILE	750.00.00.18	1
30	BEAM STOPPER	750.00.00.03	2
29	TRANSMISSION CAP	735.60.00.00	2
28	PANEL NATURALBOND	735.00.00.14.1	2
27	JOIN PROFILE	735.00.00.13	1
26	CORNER NATURALBOND	735.00.00.12	4
25	TENDON ASSEMBLY	732.75.00.00	2
24P	GUIDE CAP	732.60.00.00	2
23P	WALL ANCHOR BRACKET	732.50.00.00	2
22	END CAPS	732.45.00.00	1
21	BASE SUPPORT	732.40.00.00	2
20	MOTOR SUPPORT	732.35.00.00	2
19	TOP HINGE ASSEMBLY	732.30.00.00	2
18	WALL ANCHOR BRACKET	732.20.00.00	2
17	GUIDE COVER	732.00.00.08	2
16	BASE COVER	732.00.00.05	2
15	MOUNTING PROFILE	732.00.00.04	4
14	BEAM PROFILE	732.00.00.03	1
13	COLUMN	731.00.00.02	2
12	GUIDE PROFILE	731.00.00.01	2
11	CLOSING BRACKET	730.72.00.01	3
10	MOTOR KIT BOX	730.55.00.00	1
9	WHEEL COVER	730.45.00.00	2
8	ROLLER ASSEMBLY	730.33.00.00	10
7	ROLLER FIXED KIT	730.31.00.00	2
6	TERMINAL CAP ASSEMBLY	730.15.00.00	2
5	INTERMEDIATE CAP ASSEMBLY	730.10.00.00	3
4	SHORT TRANSMISSION AXLE	730.00.00.20	2
3	CO EXTRUDED SEAL	730.00.00.09	2
2	INTERMEDIATE PROFILE	730.00.00.03	3
1	TERMINAL PROFILE	730.00.00.02	2
ITEM	PART NAME	PART NUMBER	QTY.

PE SEAL  
REQUIRED

CERTIFYING ENGINEER AND CERT  
OF AUTH AS LISTED ON STAMP  
VALID FOR 1 PERMIT ONLY U.N.O.

**DIGITAL SEAL NOTICE:**  
IF THIS DOCUMENT IS DIGITALLY  
SIGNED, THIS SHEET IS PART OF A  
DIGITALLY SIGNED FILE. IT SHALL  
REMAIN IN DIGITAL FORMAT, SHALL  
BE VERIFIED BY ELECTRONIC MEANS,  
& PRINTED COPIES OF THIS  
DOCUMENT ARE NOT CONSIDERED  
SIGNED AND SEALED.

**PRINTED DOCUMENT NOTICE:**  
IF THIS DOCUMENT IS PRINTED &  
DOES NOT CONTAIN AN ENGINEER'S  
ORIGINAL SIGNATURE & SEAL, THIS  
DOCUMENT IS VOID & NOT VALID FOR  
USE. PHOTOCOPIES ARE NOT  
PERMITTED FOR USE.

**ENGINEERING  
EXPRESS®**  
CORPORATE OFFICE:  
160 SW 12th AVE, SUITE 106  
DEERFIELD BEACH, FL 33442  
(954) 354-0660 | (866) 396-9999  
TEAM@ENGINEERINGEXPRESS.COM  
ENGINEERINGEXPRESS.COM

**KE USA INC**  
38 POND LN, STE B  
MIDDLEBURY, VT  
(802) 388-7309

KE DURASOL  
GENIUS PERGOLA SYSTEMS  
A2C MODEL MASTER PLAN

REMARKS  
INITIALS  
DATE  
4/27/16  
4/08/21

DRWN CHKD  
MCC JCF  
CCB FLB

THIS DOCUMENT IS THE PROPERTY OF ENGINEERING EXPRESS  
AND SHALL NOT BE REPRODUCED IN WHOLE OR PART WITHOUT  
WRITTEN CONSENT OF ENGINEERING EXPRESS. ALTERATIONS,  
ADDITIONS, OR OTHER MARKINGS TO THIS DOCUMENT ARE NOT  
PERMITTED AND INVALIDATE OUR CERTIFICATION.

COPYRIGHT ENGINEERING EXPRESS®

20-35090

SCALE: NTS UNLESS NOTED

4



A2C CANOPY - NON-STRUCTURAL COMPONENTS

FOR REFERENCE ONLY - NON-STRUCTURAL COMPONENTS ARE NOT PART OF CERTIFICATION

COPIES NOT VALID FOR PERMIT

COPIES NOT VALID FOR PERMIT

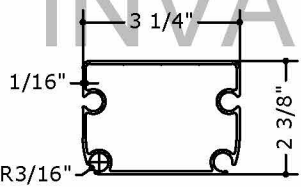

1 TERMINAL PROFILE  
PART NUMBER: 730.00.00.02

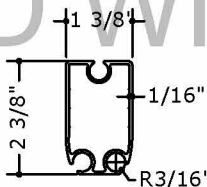

2 INTERMEDIATE PROFILE  
PART NUMBER: 730.00.00.03

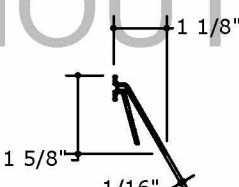

3 CO EXTRUDED SEAL  
PART NUMBER: 730.00.00.09



4 SHORT TRANSMISSION AXLE  
PART NUMBER: 730.00.00.20

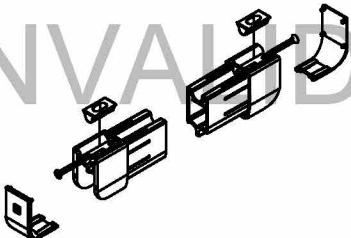

5 INTERMEDIATE CAP ASSEMBLY  
PART NUMBER: 730.10.00.00

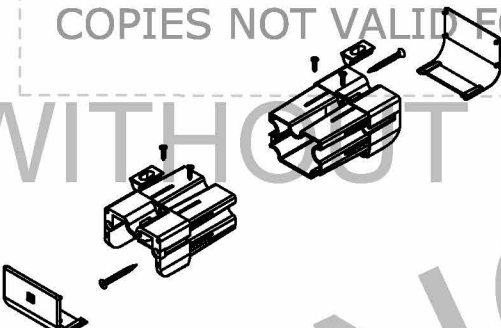

6 TERMINAL CAP ASSEMBLY  
PART NUMBER: 730.15.00.00

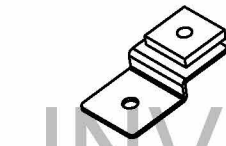

7 ROLLER FIXED KIT  
PART NUMBER: 730.31.00.00

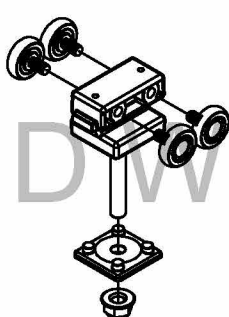

8 ROLLER ASSEMBLY  
PART NUMBER: 730.33.00.00

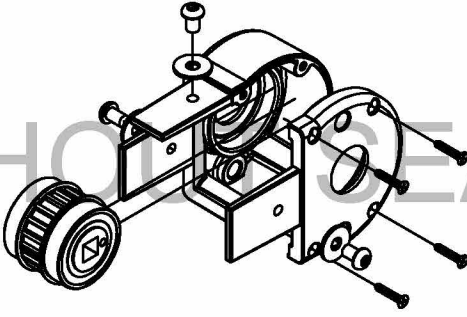

9 WHEEL COVER  
PART NUMBER: 730.45.00.00

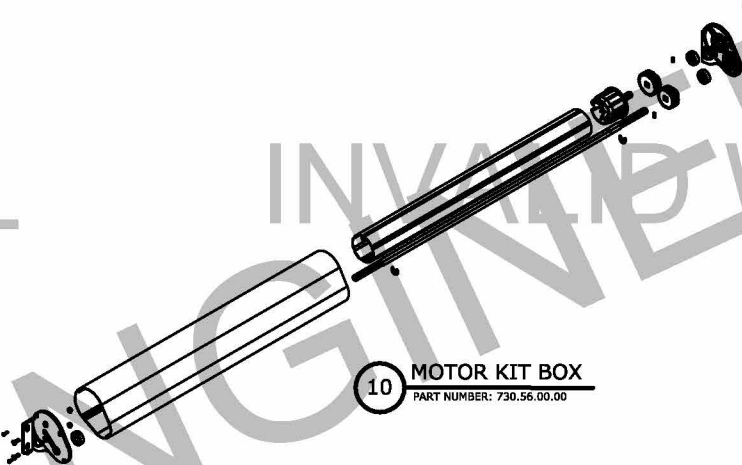

10 MOTOR KIT BOX  
PART NUMBER: 730.56.00.00



11 CLOSING BRACKET  
PART NUMBER: 730.72.00.01

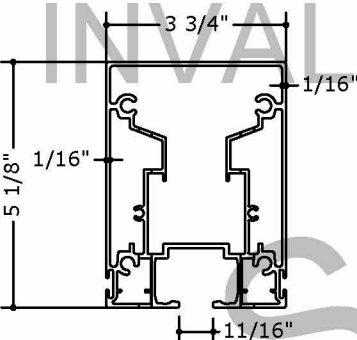

12 GUIDE PROFILE  
PART NUMBER: 731.00.00.01

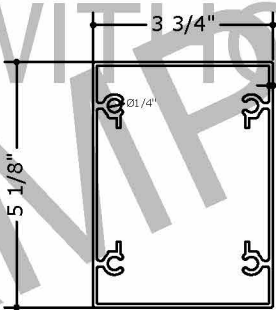

13 COLUMN  
PART NUMBER: 731.00.00.02

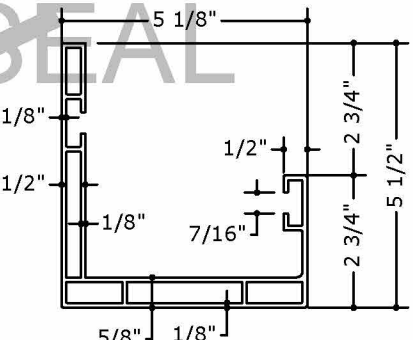

14 BEAM PROFILE  
PART NUMBER: 732.00.00.03.1

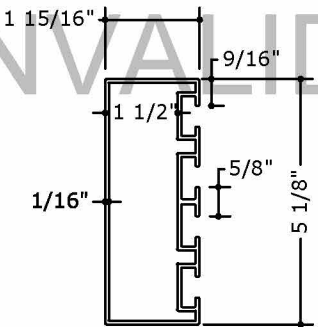

15 MOUNTING PROFILE  
PART NUMBER: 732.00.00.04

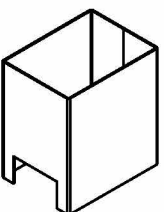

16 BASE COVER  
PART NUMBER: 732.00.00.05

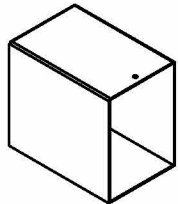

17 GUIDE COVER  
PART NUMBER: 732.00.00.06

CERTIFYING ENGINEER AND CERT OF AUTH AS LISTED ON STAMP

VALID FOR 1 PERMIT ONLY U.N.O.  
**DIGITAL SEAL NOTICE:**  
IF THIS DOCUMENT IS DIGITALLY SIGNED, THIS SHEET IS PART OF A DIGITALLY SIGNED FILE. IT SHALL REMAIN IN DIGITAL FORMAT, SHALL BE VERIFIED BY ELECTRONIC MEANS, & PRINTED COPIES OF THIS DOCUMENT ARE NOT CONSIDERED SIGNED AND SEALED.  
**PRINTED DOCUMENT NOTICE:**  
IF THIS DOCUMENT IS PRINTED & DOES NOT CONTAIN AN ENGINEER'S ORIGINAL SIGNATURE & SEAL, THIS DOCUMENT IS VOID & NOT VALID FOR USE. PHOTOCOPIES ARE NOT PERMITTED FOR USE.

**ENGINEERING EXPRESS**  
CORPORATE OFFICE:  
160 SW 12th AVE, SUITE 106  
DEERFIELD BEACH, FL 33442  
(954) 354-0660 | (866) 396-9999  
TEAM@ENGINEERINGEXPRESS.COM  
ENGINEERINGEXPRESS.COM

**KE USA INC**  
38 POND LN, STE B  
MIDDLEBURY, VT  
(802) 388-7309  
KE DURASOL  
GENIUS PERGOLA SYSTEMS  
A2C MODEL MASTER PLAN

REMARKS	DRWN	CHKD	DATE
INIT ISSUE	MCC	JCF	4/27/16
2020 FEB	CCB	FLB	4/08/21

THIS DOCUMENT IS THE PROPERTY OF ENGINEERING EXPRESS, AND SHALL NOT BE REPRODUCED IN WHOLE OR PART WITHOUT WRITTEN CONSENT OF ENGINEERING EXPRESS. ALTERATIONS, ADDITIONS OR OTHER MARKINGS TO THIS DOCUMENT ARE NOT PERMITTED AND INVALIDATE OUR CERTIFICATION.

COPYRIGHT ENGINEERING EXPRESS®

20-35090

SCALE: NTS UNLESS NOTED

5



FOR REFERENCE ONLY - NON-STRUCTURAL COMPONENTS ARE NOT PART OF CERTIFICATION

COPIES NOT VALID FOR PERMIT

**PRINTED DOCUMENT NOTICE:**  
THIS DOCUMENT IS PRINTED &  
DOES NOT CONTAIN AN ENGINEER'S  
ORIGINAL SIGNATURE & SEAL, THIS  
DOCUMENT IS VOID & NOT VALID FOR  
USE. PHOTOCOPIES ARE NOT  
PERMITTED FOR USE.

**KE USA INC**  
38 POND LN, STE B  
MIDDLEBURY, VT  
(802) 388-7309

---

**KE DURASOL**  
CENTIUS PERGOLA SYSTEMS  
A2C MODEL MASTER PLAN

6 OF 8

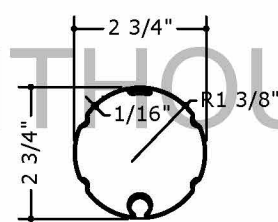

**33** CIRCULAR TUB  
PART NUMBER: 820.00.70.01



A2C CANOPY - CONNECTION DETAILS

REFERENCE SHEETS 5 & 6 FOR PART DESRIPTONS

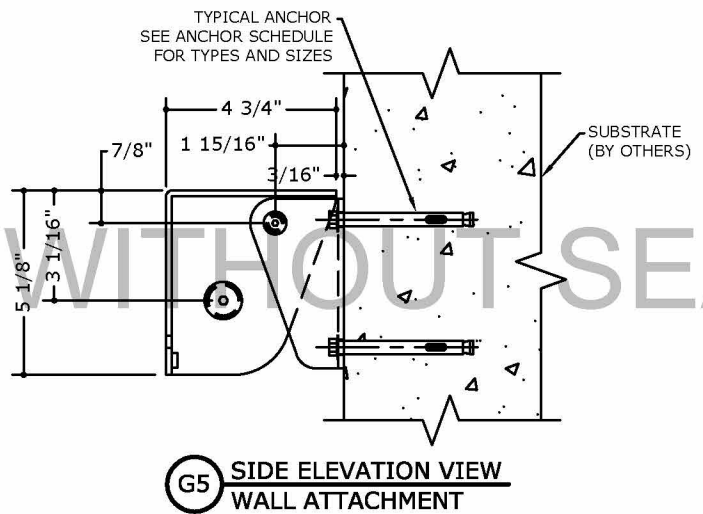
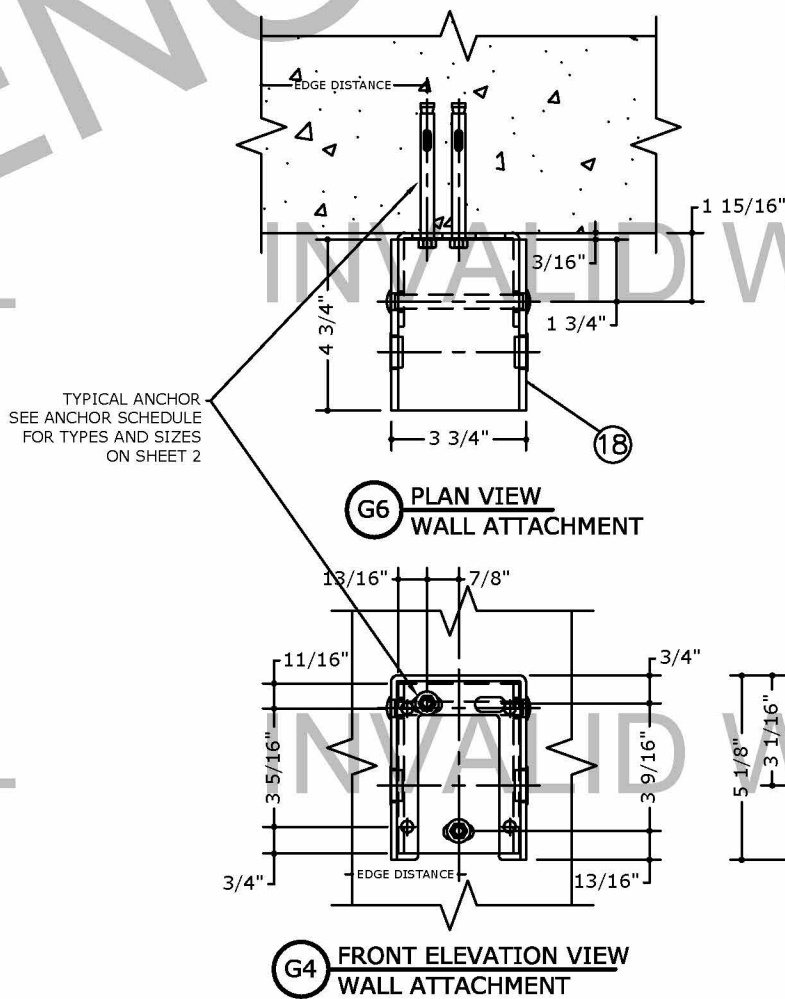
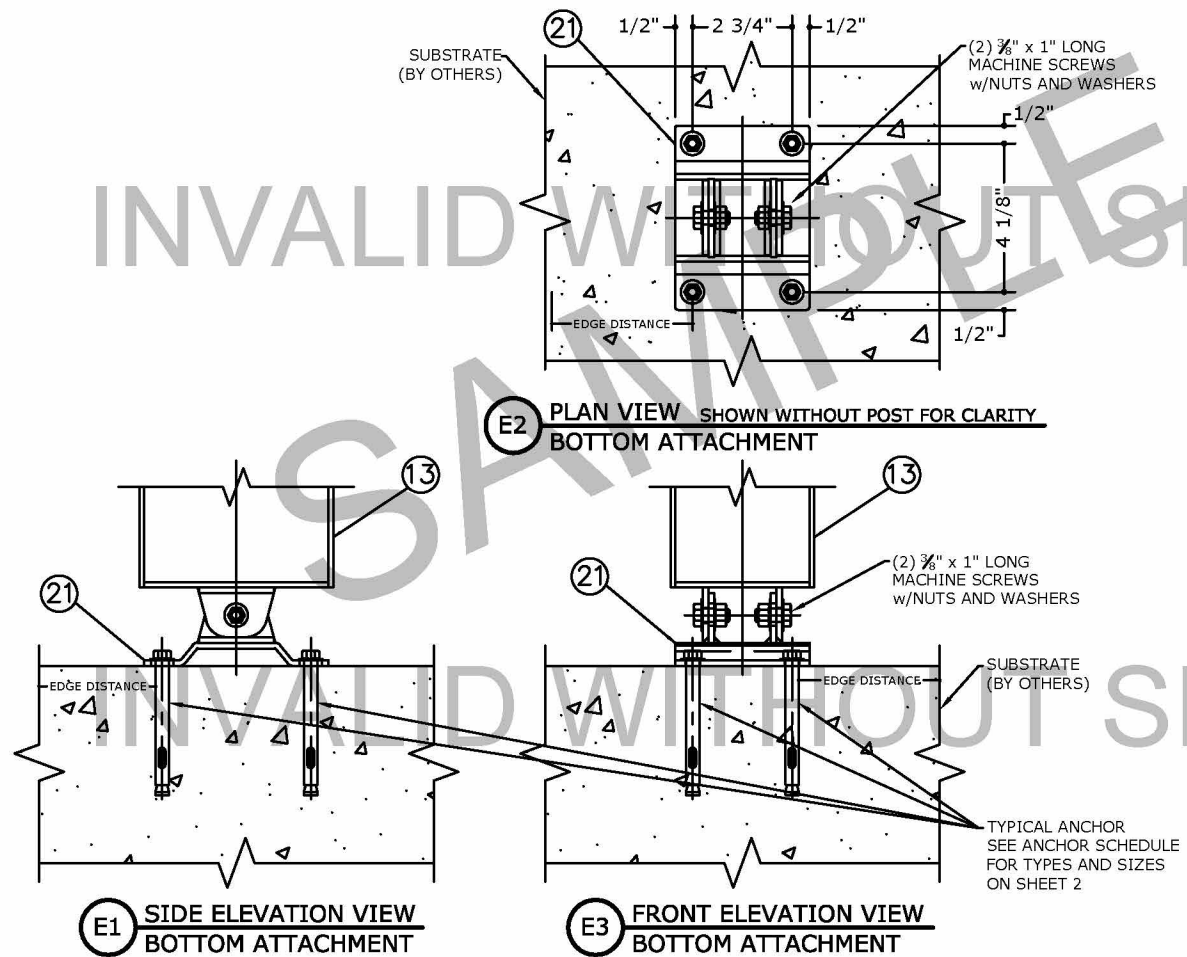
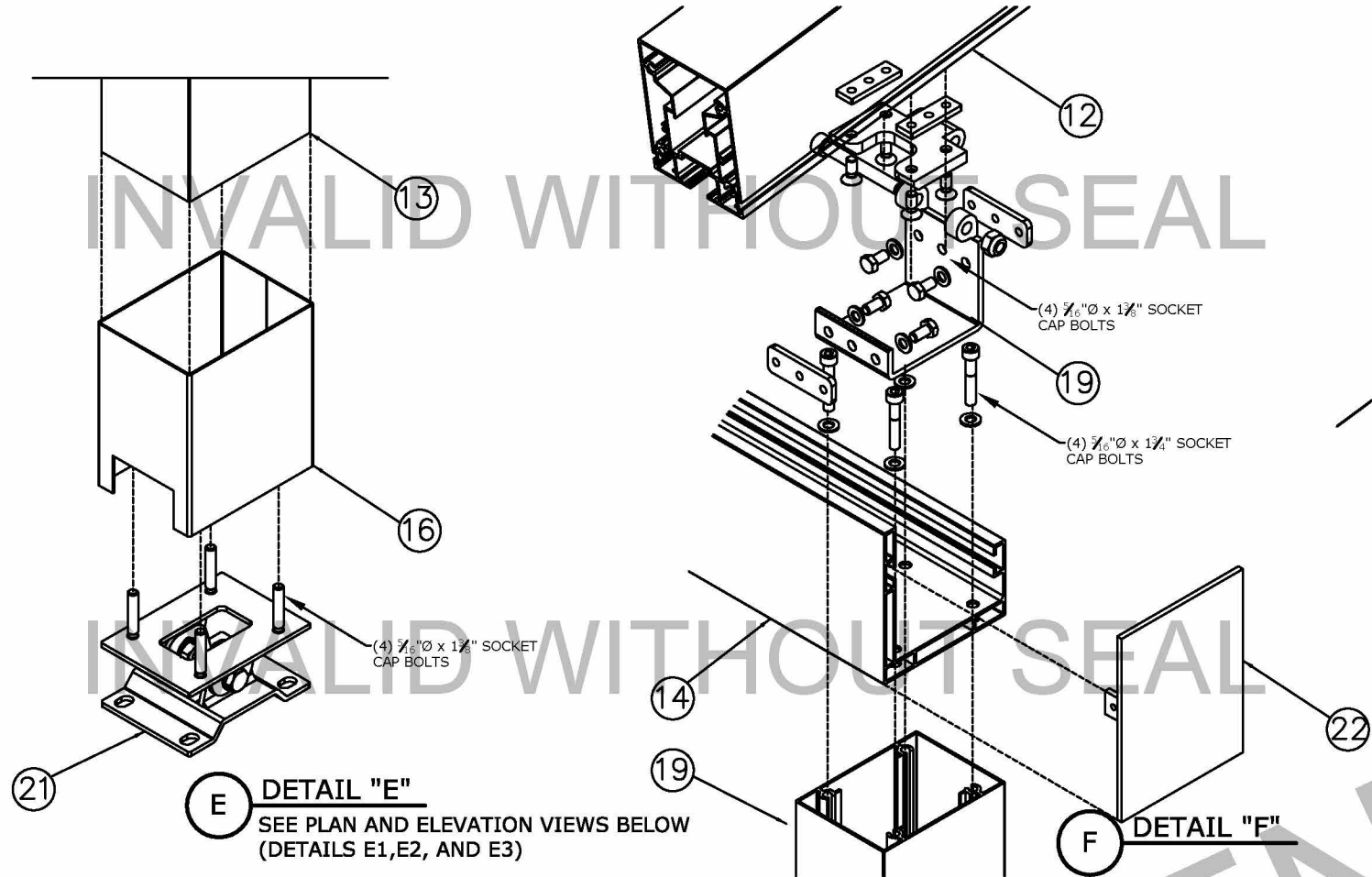

COPIES NOT VALID FOR PERMIT

COPIES NOT VALID FOR PERMIT

CERTIFYING ENGINEER AND CERT  
OF AUTH AS LISTED ON STAMP  
VALID FOR 1 PERMIT ONLY U.N.O.

**DIGITAL SEAL NOTICE:**  
IF THIS DOCUMENT IS DIGITALLY  
SIGNED, THIS SHEET IS PART OF A  
DIGITALLY SIGNED FILE. IT SHALL  
REMAIN IN DIGITAL FORMAT, SHALL  
BE VERIFIED BY ELECTRONIC MEANS,  
& PRINTED COPIES OF THIS  
DOCUMENT ARE NOT CONSIDERED  
SIGNED AND SEALED.

**PRINTED DOCUMENT NOTICE:**  
IF THIS DOCUMENT IS PRINTED &  
DOES NOT CONTAIN AN ENGINEER'S  
ORIGINAL SIGNATURE & SEAL, THIS  
DOCUMENT IS VOID & NOT VALID FOR  
USE. PHOTOCOPIES ARE NOT  
PERMITTED FOR USE.

**ENGINEERING  
EXPRESS®**

CORPORATE OFFICE:  
160 SW 12th AVE, SUITE 106  
DEERFIELD BEACH, FL 33442  
(954) 354-0660 | (866) 396-9999  
TEAM@ENGINEERINGEXPRESS.COM  
ENGINEERINGEXPRESS.COM

**KE USA INC**  
38 POND LN, STE B  
MIDDLEBURY, VT  
(802) 388-7309

**KE DURASOL**  
GENIUS PERGOLA SYSTEMS  
A2C MODEL MASTER PLAN

REMARKS	DRWN	CHKD	DATE
INIT ISSUE	MCC	JCF	4/27/16
2020 FEB	CCB	FLB	4/08/21

THIS DOCUMENT IS THE PROPERTY OF ENGINEERING EXPRESS  
AND SHALL NOT BE REPRODUCED IN WHOLE OR PART WITHOUT  
WRITTEN CONSENT OF ENGINEERING EXPRESS. ALTERATIONS,  
ADDITIONS, OR OTHER MARKINGS TO THIS DOCUMENT ARE NOT  
PERMITTED AND INVALIDATE OUR CERTIFICATION.

COPYRIGHT ENGINEERING EXPRESS®

20-35090

SCALE: NTS UNLESS NOTED

7



A2C CANOPY - ROLLER CONNECTION

FOR REFERENCE ONLY - NON-STRUCTURAL COMPONENTS ARE NOT PART OF CERTIFICATION

COPIES NOT VALID FOR PERMIT

COPIES NOT VALID FOR PERMIT

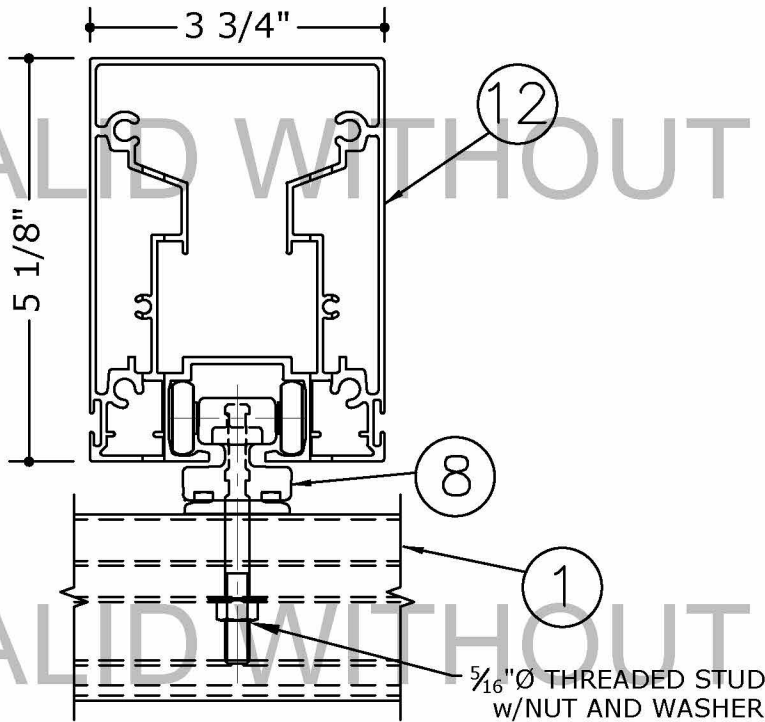

H1 ROLLER FRONT VIEW  
CONNECTION AT TERMINAL PROFILE

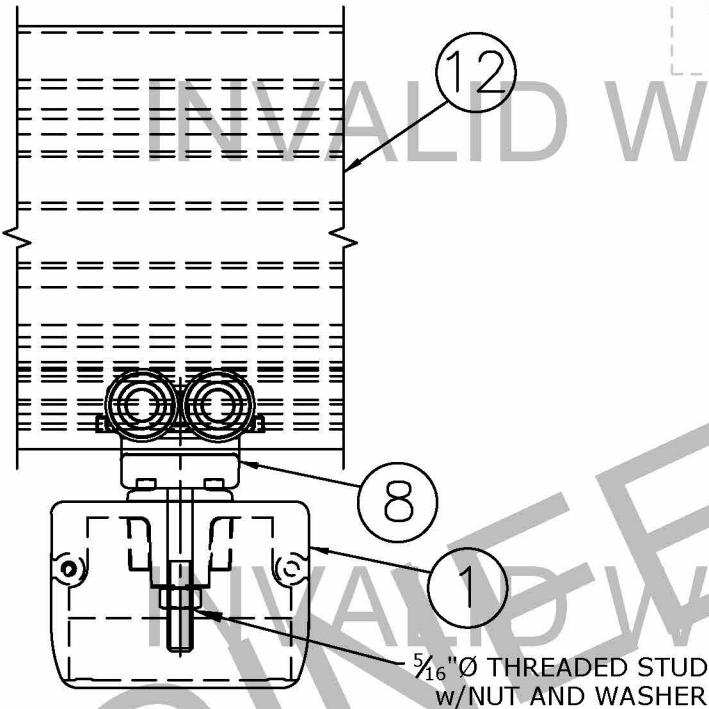

H2 ROLLER SIDE VIEW  
CONNECTION AT TERMINAL PROFILE

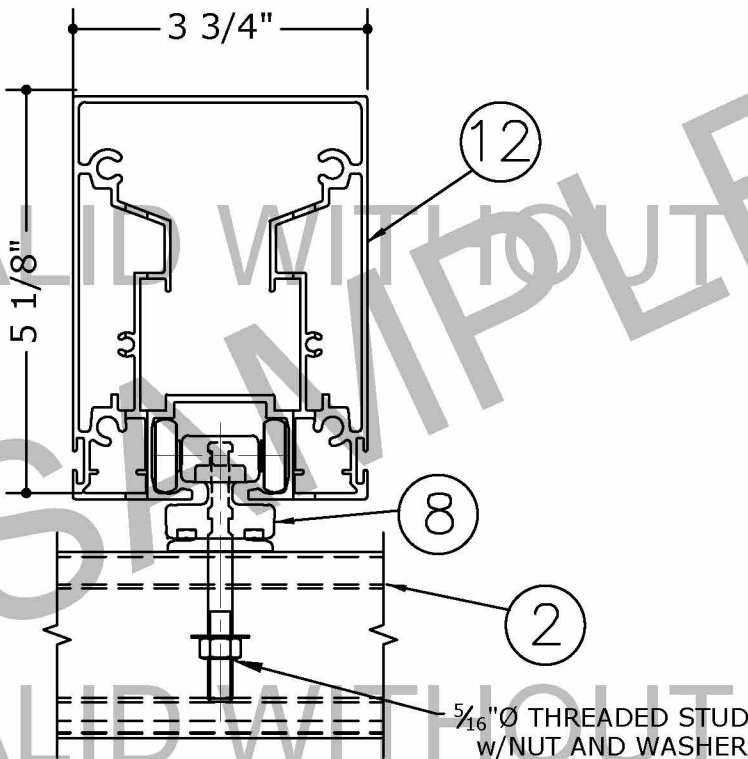

H3 ROLLER FRONT VIEW  
CONNECTION AT INTERMEDIATE PROFILE

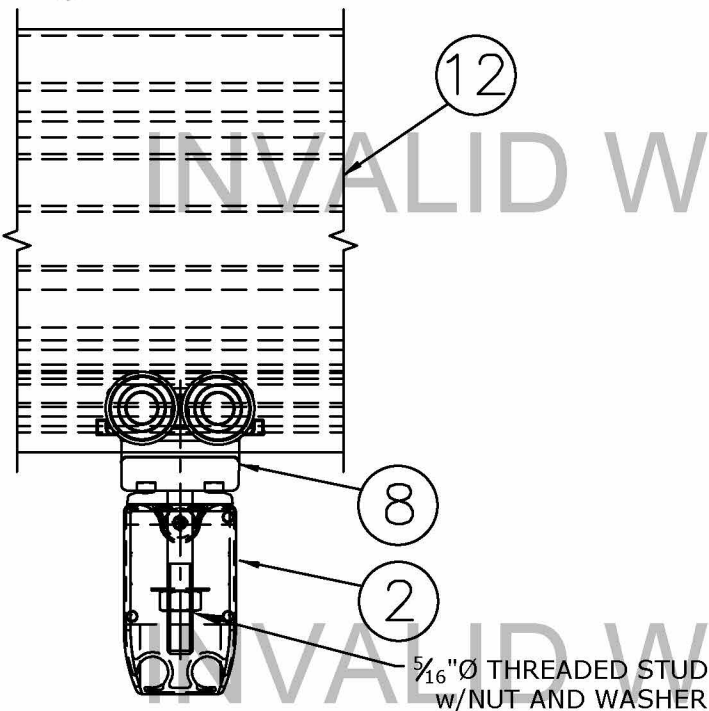

H4 ROLLER SIDE VIEW  
CONNECTION AT INTERMEDIATE PROFILE

CERTIFYING ENGINEER AND CERT  
OF AUTH AS LISTED ON STAMP  
VALID FOR 1 PERMIT ONLY U.N.O.

**DIGITAL SEAL NOTICE:**  
IF THIS DOCUMENT IS DIGITALLY  
SIGNED, THIS SHEET IS PART OF A  
DIGITALLY SIGNED FILE. IT SHALL  
REMAIN IN DIGITAL FORMAT, SHALL  
BE VERIFIED BY ELECTRONIC MEANS,  
& PRINTED COPIES OF THIS  
DOCUMENT ARE NOT CONSIDERED  
SIGNED AND SEALED.

**PRINTED DOCUMENT NOTICE:**  
IF THIS DOCUMENT IS PRINTED &  
DOES NOT CONTAIN AN ENGINEER'S  
ORIGINAL SIGNATURE & SEAL, THIS  
DOCUMENT IS VOID & NOT VALID FOR  
USE. PHOTOCOPIES ARE NOT  
PERMITTED FOR USE.



CORPORATE OFFICE:  
160 SW 12th AVE, SUITE 106  
DEERFIELD BEACH, FL 33442  
(954) 354-0660 | (866) 396-9999  
TEAM@ENGINEERINGEXPRESS.COM  
ENGINEERINGEXPRESS.COM

KE USA INC  
38 POND LN, STE B  
MIDDLEBURY, VT  
(802) 388-7309

KE DURASOL  
GENIUS PERGOLA SYSTEMS  
A2C MODEL MASTER PLAN

REMARKS	DRWN	CHKD	DATE
INIT ISSUE	MCC	JCF	4/27/16
2020 FEB	CCB	FLB	4/08/21
THIS DOCUMENT IS THE PROPERTY OF ENGINEERING EXPRESS AND SHALL NOT BE REPRODUCED IN WHOLE OR PART WITHOUT WRITTEN CONSENT OF ENGINEERING EXPRESS. ALTERATIONS, ADDITIONS, OR OTHER MARKINGS TO THIS DOCUMENT ARE NOT PERMITTED AND INVALIDATE OUR CERTIFICATION.			

COPYRIGHT ENGINEERING EXPRESS®

20-35090

SCALE: NTS UNLESS NOTED

8