



EASTERN METAL SUPPLY

2" x 24GA GALVANIZED STEEL STORM PANELS

COPIES NOT VALID FOR PERMIT

COPIES NOT VALID FOR PERMIT

03/05/2021

CERTIFYING ENGINEER AND CERT
OF AUTH AS LISTED ON STAMP
VALID FOR 1 PERMIT ONLY U.N.O.
DIGITAL SEAL NOTICE:
IF THIS DOCUMENT IS DIGITALLY
SIGNED, THIS SHEET IS PART OF A
DIGITALLY SIGNED FILE. IT SHALL
REMAIN IN DIGITAL FORMAT, SHALL
BE VERIFIED BY ELECTRONIC MEANS,
& PRINTED COPIES OF THIS
DOCUMENT ARE NOT CONSIDERED
SIGNED AND SEALED.
PRINTED DOCUMENT NOTICE:
IF THIS DOCUMENT IS PRINTED &
DOES NOT CONTAIN AN ENGINEER'S
ORIGINAL SIGNATURE & SEAL, THIS
DOCUMENT IS VOID & NOT VALID FOR
USE. PHOTOCOPIES ARE NOT
PERMITTED FOR USE.

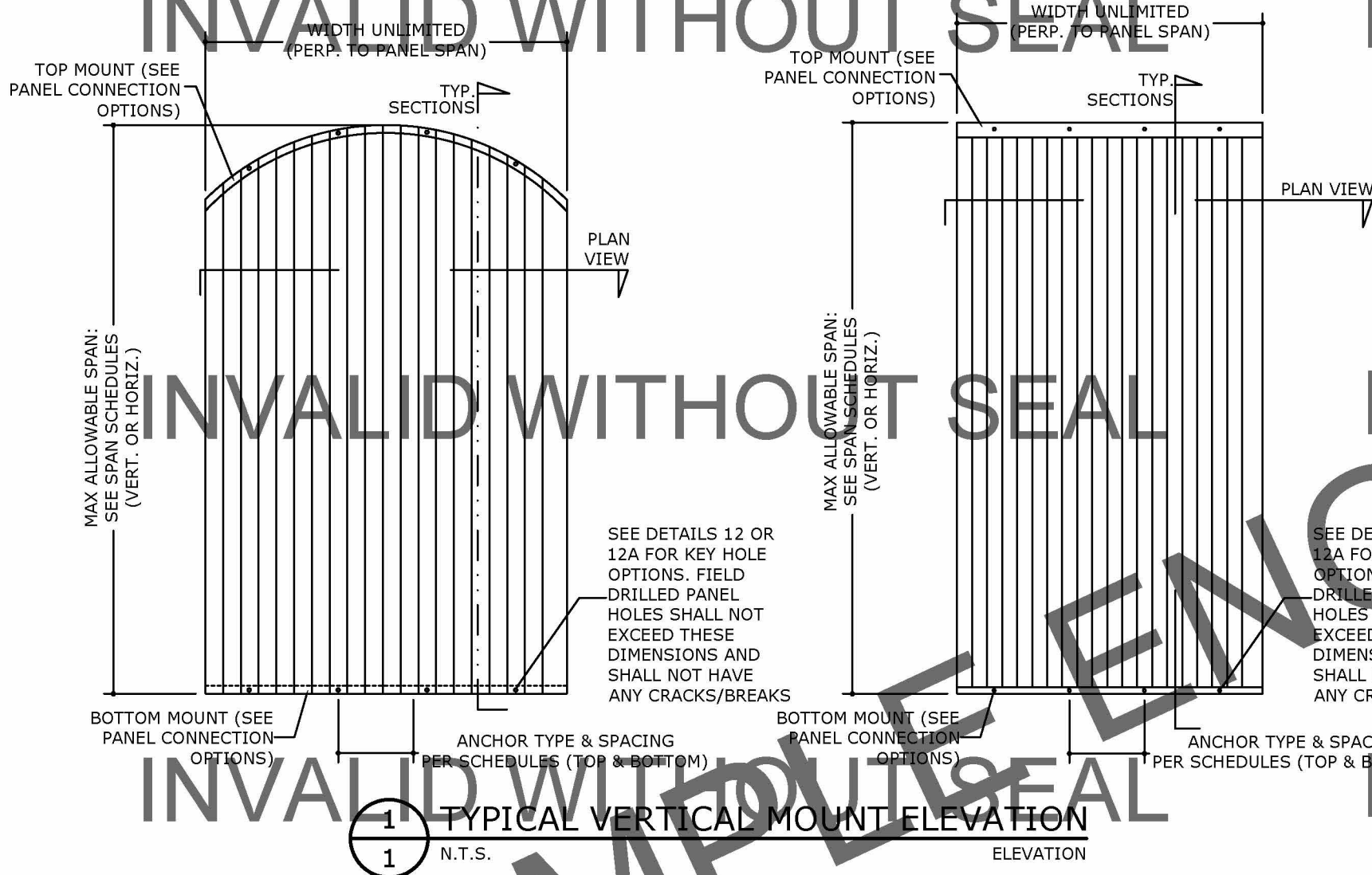

MAXIMUM ALLOWABLE DESIGN PRESSURES: AS NOTED IN DESIGN SCHEDULES

DESIGN NOTES:

POSITIVE & NEGATIVE (ASD) DESIGN PRESSURES FOR USE WITH THIS SYSTEM SHALL BE DETERMINED ON A SITE-SPECIFIC BASIS AND COMPARED TO LIMITING FACTORS AS STIPULATED HEREIN. THEY SHALL BE CALCULATED IN ACCORDANCE WITH THE GOVERNING CODE REQUIREMENTS & IN ACCORDANCE WITH ASCE 7-16 AND CHAPTER 16 OF THE INTERNATIONAL BUILDING CODE (2018). THEY SHALL BE LESS THAN OR EQUAL TO THE POSITIVE OR NEGATIVE DESIGN PRESSURE CAPACITY VALUES LISTED HEREIN FOR ANY ASSEMBLY AS SHOWN.

TOP & BOTTOM DETAILS SHOWN MAY BE INTERCHANGED AS FIELD CONDITIONS DICTATE. PANELS MAY BE MOUNTED VERTICALLY OR HORIZONTALLY AS APPLICABLE.

GENERAL NOTES:

- THIS SYSTEM HAS BEEN DESIGNED AND SHALL BE FABRICATED IN ACCORDANCE WITH THE REQUIREMENTS OF THE FLORIDA BUILDING CODE 7TH EDITION (2020). ALSO APPLICABLE FOR THE FBC 6TH EDITION (2017), IBC/IRC (2015 & 2018), AS WELL AS CURRENT VERSIONS OF THE MN, NC, NJ, NY, OH, SC, & VA BUILDING CODES AS APPLICABLE. CODE ENFORCED COMPLIES WITH STATE OF SEAL AND IF MULTIPLE VERSIONS ARE LISTED THEN MOST STRINGENT APPLIES. DESIGN IS TO FOLLOW ASTM E330, E1886 & 1996 TEST PROTOCOLS IN ALL CASES. DESIGN SHALL UTILIZE ASD DESIGN METHOD USING ASCE 7-16 OR ASCE 7-10 CODES FOR SITE SPECIFIC APPLICATIONS AS APPLICABLE.
- DESIGN CRITERIA BEYOND AS STATED HEREIN MAY REQUIRE ADDITIONAL SITE-SPECIFIC SEALED ENGINEERING.
- NO 33-1/3% INCREASE IN ALLOWABLE STRESS HAS BEEN USED IN THE DESIGN OF THIS SYSTEM.
- THE ARCHITECT/ENGINEER OF RECORD FOR THE PROJECT SUPERSTRUCTURE WITH WHICH THIS DESIGN IS USED SHALL BE RESPONSIBLE FOR THE INTEGRITY OF ALL SUPPORTING SURFACES TO THIS DESIGN WHICH SHALL BE COORDINATED BY THE PERMITTING CONTRACTOR.
- SEPARATE 'SITE-SPECIFIC' SIGNED AND SEALED ENGINEERING SHALL BE REQUIRED IN ORDER TO DEVIATE, INTERPOLATE, AND EXTRAPOLATE FROM LOADS, DEFLECTIONS, OR SPANS CONTAINED HEREIN. CONTACT THIS ENGINEER AND VISIT THE ACCOMPANYING DIGITAL INFORMATION REFERENCED HEREIN FOR ALTERNATE SPAN CALCULATIONS AS MAY BE REQUIRED.
- THE SYSTEM DETAILED HEREIN IS GENERIC AND DOES NOT PROVIDE INFORMATION FOR A SPECIFIC SITE. FOR SITE CONDITIONS DIFFERENT FROM THE CONDITIONS DETAILED HEREIN, A LICENSED ENGINEER OR REGISTERED ARCHITECT SHALL PREPARE SITE SPECIFIC DOCUMENTS FOR USE IN CONJUNCTION WITH THIS DOCUMENT.
- DESIGN PRESSURES NOTED HEREIN ARE BASED ON MAXIMUM TESTED PRESSURES DIVIDED BY A 1.5 SAFETY FACTOR.
- ALL FASTENERS TO BE 1/2"Ø OR GREATER SAE GRADE 5 UNLESS NOTED OTHERWISE. FASTENERS SHALL BE CADMIUM-PLATED OR OTHERWISE CORROSION-RESISTANT MATERIAL AND SHALL COMPLY WITH "SPECIFICATIONS FOR ALUMINUM STRUCTURES" SECTION J.3.7.2 BY THE ALUMINUM ASSOCIATION, INC., & ANY APPLICABLE FEDERAL, STATE, AND/OR LOCAL CODES.
- ALL STORM PANELS SHALL BE 24GA ASTM A653 GRADE 80, Fy=106KSI MIN, G-90 GALVANIZED STEEL AND CONFORM TO THE SPECIFICATIONS LISTED HEREIN.
- ALL ALUMINUM EXTRUSIONS SHALL BE 6063-T6 ALUMINUM ALLOY OR BETTER, UNLESS NOTED OTHERWISE.
- CONCRETE ANCHORS NOTED HEREIN SHALL BE EMBEDDED TO NON-CRACKED CONCRETE ONLY. INSTALL ALL CONCRETE ANCHORS PER MANUFACTURER'S RECOMMENDATIONS.
- THE CONTRACTOR IS RESPONSIBLE TO INSULATE OR PROTECT ALL MEMBERS FROM DISSIMILAR MATERIALS TO PREVENT ELECTROLYSIS.
- ENGINEER SEAL AFFIXED HERE TO VALIDATES STRUCTURAL DESIGN AS SHOWN ONLY. USE OF THIS SPECIFICATION BY CONTRACTOR, et. al. INDEMNIFIES & SAVES HARMLESS THIS ENGINEER FOR ALL COST & DAMAGES INCLUDING LEGAL FEES & APPELLATE FEES RESULTING FROM MATERIAL FABRICATION, SYSTEM ERECTION, & CONSTRUCTION PRACTICES BEYOND THAT WHICH IS CALLED FOR BY LOCAL, STATE, & FEDERAL CODES & FROM DEVIATIONS OF THIS PLAN.
- EXCEPT AS EXPRESSLY PROVIDED HEREIN, NO ADDITIONAL CERTIFICATIONS OR AFFIRMATIONS ARE INTENDED.
- ALTERATIONS, ADDITIONS, OR OTHER MARKINGS TO THIS DOCUMENT ARE NOT PERMITTED AND INVALIDATE THIS CERTIFICATION.
- PANELS SHALL BE PERMANENTLY LABELED WITH A MINIMUM OF (1) LABEL PER PANEL, CONTAINING THE FOLLOWING INFORMATION:

EASTERN METAL SUPPLY, INC.
WEST PALM BEACH, FL
ASTM E330, ASTM E1886 & ASTM E1996 (MISSILE LEVEL D)
TDI EVALUATED

SCHEDULES 1-2: MAX ALLOWABLE SPANS

2" x 24GA STEEL PANELS

SCHEDULE 1		
MAX ALLOWABLE SPAN SCHEDULE FOR USE w/ DIRECT MOUNT AND w/ EXTRUSIONS: 2, 4, 6, 7, 8, 10		
PANEL SPAN	ALLOWABLE DESIGN PRESSURE	
118"	+ 33 PSF	- 42 PSF
112"	+ 33 PSF	- 44 PSF
106"	+ 34 PSF	- 47 PSF
100"	+ 34 PSF	- 50 PSF
94"	+ 50 PSF	- 53 PSF
88"	+ 57 PSF	- 57 PSF
82"	+ 57 PSF	- 57 PSF
76"	+ 57 PSF	- 57 PSF
70"	+ 57 PSF	- 57 PSF
64"	+ 57 PSF	- 57 PSF
58"	+ 57 PSF	- 57 PSF
52"	+ 57 PSF	- 57 PSF
46"	+ 58 PSF	- 58 PSF
40"	+ 58 PSF	- 58 PSF
32"	+ 58 PSF	- 58 PSF

SCHEDULE 2		
MAX ALLOWABLE SPAN SCHEDULE FOR USE w/ EXTRUSIONS: 3 AND 5		
PANEL SPAN	ALLOWABLE DESIGN PRESSURE	
118"	+ 33 PSF	- 42 PSF
112"	+ 33 PSF	- 44 PSF
106"	+ 34 PSF	- 47 PSF
100"	+ 34 PSF	- 50 PSF
94"	+ 41 PSF	- 53 PSF
88"	+ 44 PSF	- 56 PSF
82"	+ 44 PSF	- 57 PSF
76"	+ 45 PSF	- 57 PSF
70"	+ 46 PSF	- 57 PSF
64"	+ 47 PSF	- 57 PSF
58"	+ 48 PSF	- 57 PSF
52"	+ 49 PSF	- 57 PSF
46"	+ 51 PSF	- 57 PSF
40"	+ 53 PSF	- 58 PSF
32"	+ 58 PSF	- 58 PSF

SPAN SCHEDULE NOTES:

- SELECT SPAN SCHEDULE BASED ON HEADER/SILL EXTRUSION TYPE OR DIRECT MOUNTING CONDITION. ENTER SCHEDULE WITH PANEL SPAN AND DETERMINE MAX ALLOWABLE POSITIVE/NEGATIVE DESIGN PRESSURES.
- LINEAR INTERPOLATION BETWEEN LOADS IS ACCEPTABLE, OTHERWISE USE NEXT HIGHER LOAD.

HEADER/SILL EXTRUSIONS:

- "H" HEADER
- 3" BUILD-OUT "U" HEADER
- "U" HEADER
- 3" BUILD-OUT "F" TRACK
- "F" TRACK
- 1" STUCCO TRACK
- STUD ANGLE
- STUDDED PLATE

ENGINEERING EXPRESS®
CORPORATE OFFICE:
160 SW 12th AVE, SUITE 106
DEERFIELD BEACH, FL 33442
(954) 354-0660 | (866) 396-9999
TEAM@ENGINEERINGEXPRESS.COM
ENGINEERINGEXPRESS.COM

EASTERN METAL SUPPLY
4268 WESTROADS DR
WEST PALM BEACH, FL
(800) 432-2204
2" X 24GA STEEL STORM PANEL
FBC 7TH ED (2020) & IBC (2018)
ASCE 7-16 & 7-10

REMARKS	DATE	DRWN	CHKD	DATE
INIT ISSUE	7/24/20	CSL	RWN	
THIS DOCUMENT IS THE PROPERTY OF ENGINEERING EXPRESS AND SHALL NOT BE REPRODUCED IN WHOLE OR PART WITHOUT WRITTEN CONSENT OF ENGINEERING EXPRESS. ALTERATIONS, ADDITIONS OR OTHER MARKINGS TO THIS DOCUMENT ARE NOT PERMITTED AND INVALIDATE OUR CERTIFICATION.				

COPYRIGHT ENGINEERING EXPRESS®

21-37455

SCALE: NTS UNLESS NOTED

1 OF 4

COPIES NOT VALID FOR PERMIT

**CERTIFYING ENGINEER AND CERT
OF AUTH AS LISTED ON STAMP**

DIGITAL SEAL NOTICE:
THIS DOCUMENT IS DIGITALLY SIGNED. THIS SHEET IS PART OF A DIGITALLY SIGNED FILE. IT SHALL REMAIN IN DIGITAL FORMAT, SHALL BE VERIFIED BY ELECTRONIC MEANS, AND PRINTED COPIES OF THIS DOCUMENT ARE NOT CONSIDERED SIGNED AND SEALED.

PRINTED DOCUMENT NOTICE:
THIS DOCUMENT IS PRINTED & DOES NOT CONTAIN AN ENGINEER'S ORIGINAL SIGNATURE & SEAL. THIS DOCUMENT IS VOID & NOT VALID FOR REUSE. PHOTOCOPIES ARE NOT PERMITTED FOR USE.

ENGINEERING
EXPRESS®

EXPRESS

CORPORATE OFFICE:
160 SW 12th AVE, SUITE 106
DEERFIELD BEACH, FL 33442
(954) 354-0660 | (866) 396-9999
TEAM@ENGINEERINGEXPRESS.COM
ENGINEERINGEXPRESS.COM

EASTERN METAL SUPPLY
4268 WESTROADS DR
WEST PALM BEACH, FL
(800) 432-2204

2" X 24GA STEEL STORM PANEL
FBC 7TH ED (2020) & IBC (2018)
ASCE 7-16 & 7-10

UNIT	ISSUE	CSL	RWN	DATE
				7/24/20

THIS DOCUMENT IS THE PROPERTY OF ENGINEERING EXPRESS AND SHALL NOT BE REPRODUCED IN WHOLE OR PART WITHOUT WRITTEN CONSENT OF ENGINEERING EXPRESS. ALTERATIONS, ADDITIONS, OR OTHER MARKINGS TO THIS DOCUMENT ARE NOT PERMITTED AND IN VAL DATE OUR CERTIFICATION.

COPYRIGHT ENGINEERING EXPRESS®

21-37455

SCALE: NTS UNLESS NOTED

OF 1

5)

3)

—

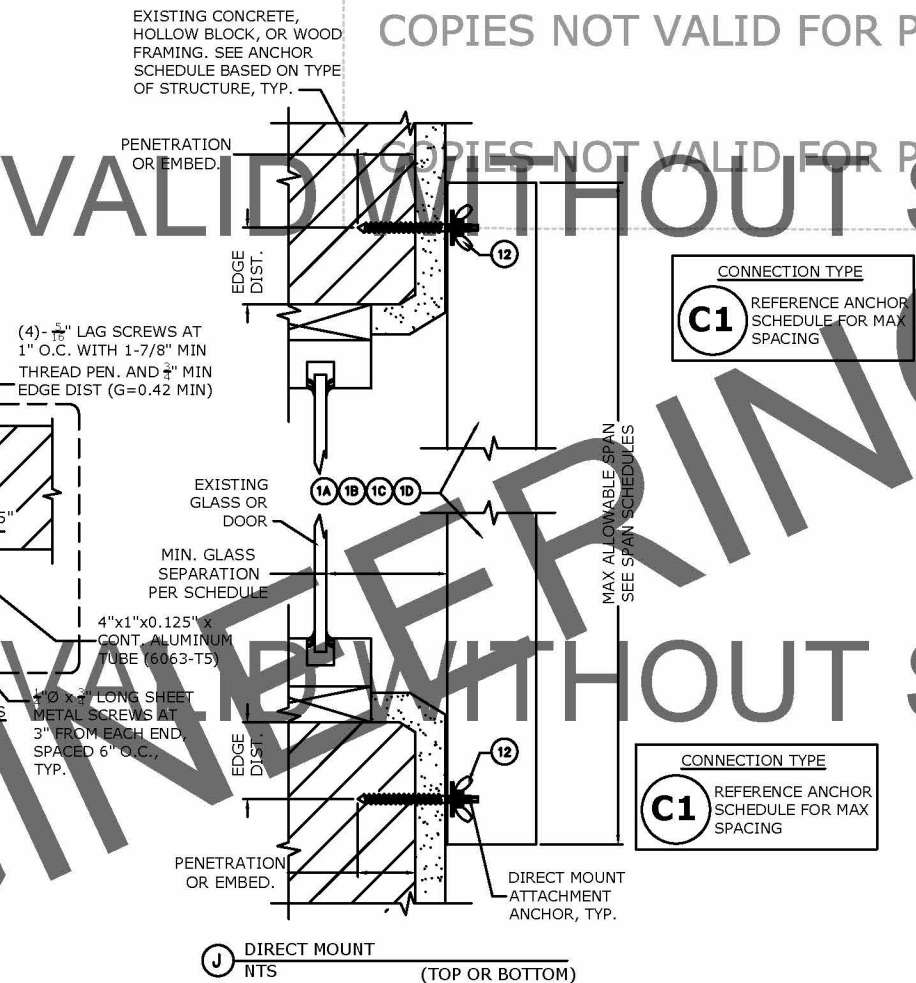

2" x 24GA STEEL PANELS

MINIMUM STORM PANEL SEPARATION FROM GLASS		
PANEL SPAN	INSTALLATIONS ≤ 30' ABOVE GRADE	INSTALLATIONS > 30' ABOVE GRADE
118"	4.50 "	1.75 "
112"	4.50 "	1.75 "
106"	4.50 "	1.50 "
100"	4.50 "	1.50 "
94"	4.50 "	1.50 "
88"	4.25 "	1.50 "
82"	4.25 "	1.50 "
76"	4.25 "	1.25 "
70"	4.25 "	1.25 "
64"	4.25 "	1.25 "
58"	4.25 "	1.25 "
52"	4.25 "	1.25 "
46"	4.25 "	1.25 "
40"	4.25 "	1.25 "
34"	4.00 "	1.25 "

1. THIS SCHEDULE SHALL APPLY FOR ALL INSTALLATIONS THAT ARE REQUIRED TO MAINTAIN A MINIMUM SEPARATION BETWEEN THE STORM PANEL AND ANY GLAZING, AS REQUIRED BY THE BUILDING DEPARTMENT OR AUTHORITY HAVING JURISDICTION.
2. ENTER SEPARATION SCHEDULE WITH PANEL SPAN AND DETERMINE THE REQUIRED SEPARATION FROM GLASS.
3. SCHEDULE IS REQUIRED FOR USE WITH POSITIVE LOADS ONLY. INTERPOLATION BETWEEN LOADS IS ACCEPTABLE, OTHERWISE USE NEXT HIGHER LOAD.

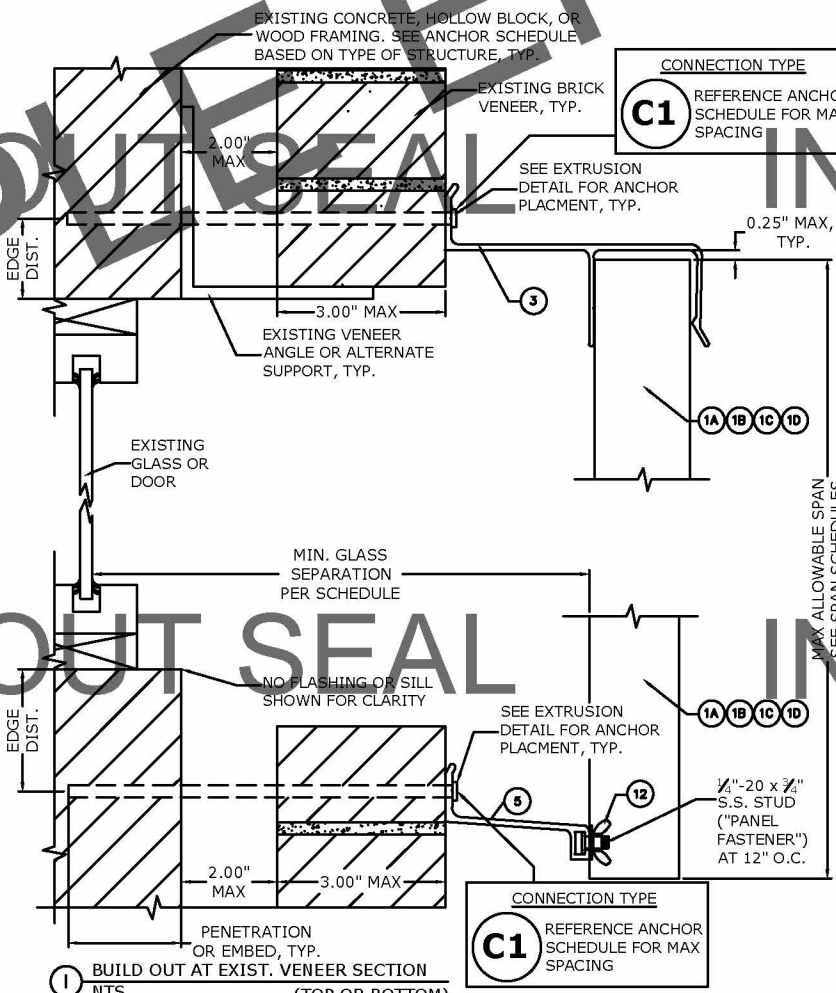

ANCHOR SPACING SCHEDULES:

2" x 24GA STEEL PANELS

HOST STRUCT.	ANCHOR	LOAD (psf)	ANCHOR SPACING BY SPAN AND CONNECTION TYPE								
			Spans Up To 2'-8"			Spans Up To 6'-6"			Spans Up To 9'-10"		
			CONN TYPE			CONN TYPE			CONN TYPE		
CONCRETE	1/4" ITW TAPCON WITH 1-3/4" EMBED AND 1-1/2" MIN EDGE DISTANCE (2000 psi MIN CONCRETE)	33	12.0"	12.0"	12.0"	12.0"	12.0"	12.0"	12.0"	12.0"	11.5"
		38	12.0"	12.0"	12.0"	12.0"	12.0"	12.0"	12.0"	12.0"	10.0"
		43	12.0"	12.0"	12.0"	12.0"	12.0"	12.0"	12.0"	12.0"	8.5"
		48	12.0"	12.0"	12.0"	12.0"	12.0"	12.0"	12.0"	12.0"	7.5"
		53	12.0"	12.0"	12.0"	12.0"	12.0"	10.5"	12.0"	11.0"	7.0"
		58	12.0"	12.0"	12.0"	12.0"	12.0"	9.5"	12.0"	10.5"	6.5"
	1/4" DEWALT ULTRACON WITH 1-3/4" EMBED AND 1" MIN EDGE DISTANCE (3050 psi MIN CONCRETE)	33	12.0"	12.0"	12.0"	12.0"	12.0"	12.0"	12.0"	11.0"	8.5"
		38	12.0"	12.0"	12.0"	12.0"	12.0"	11.0"	12.0"	9.5"	7.5"
		43	12.0"	12.0"	12.0"	12.0"	12.0"	10.0"	12.0"	8.5"	6.5"
		48	12.0"	12.0"	12.0"	12.0"	11.5"	9.0"	12.0"	7.5"	6.0"
		53	12.0"	12.0"	12.0"	12.0"	10.5"	8.0"	12.0"	7.0"	5.0"
		58	12.0"	12.0"	12.0"	12.0"	9.5"	7.5"	12.0"	6.5"	5.0"
	1/4" ELCO/DEWALT PANELMATE (FEMALE, MALE, or PLUS) W/ 2" EMBED AND 2-1/2" MIN EDGE DISTANCE (3350 psi MIN CONC)	33	12.0"	12.0"	12.0"	12.0"	12.0"	12.0"	12.0"	12.0"	9.5"
		38	12.0"	12.0"	12.0"	12.0"	12.0"	12.0"	10.5"	8.0"	
		43	12.0"	12.0"	12.0"	12.0"	12.0"	11.0"	12.0"	9.5"	7.0"
		48	12.0"	12.0"	12.0"	12.0"	12.0"	10.0"	12.0"	8.5"	6.5"
		53	12.0"	12.0"	12.0"	12.0"	11.5"	9.0"	12.0"	7.5"	6.0"
		58	12.0"	12.0"	12.0"	12.0"	10.5"	8.0"	12.0"	7.0"	5.5"
	1/4" ITW TAPCON STORM GUARD W/1-3/4" EMBED AND 1-1/4" MIN EDGE DISTANCE (3000 psi MIN CONCRETE)	33	12.0"	12.0"	12.0"	12.0"	12.0"	12.0"	12.0"	12.0"	12.0"
		38	12.0"	12.0"	12.0"	12.0"	12.0"	12.0"	12.0"	12.0"	12.0"
		43	12.0"	12.0"	12.0"	12.0"	12.0"	12.0"	12.0"	12.0"	11.0"
		48	12.0"	12.0"	12.0"	12.0"	12.0"	12.0"	12.0"	12.0"	10.0"
		53	12.0"	12.0"	12.0"	12.0"	12.0"	12.0"	12.0"	12.0"	9.0"
		58	12.0"	12.0"	12.0"	12.0"	12.0"	12.0"	12.0"	12.0"	8.5"
	1/4-20 ALL POINTS SOLID- SET WITH 7/8" EMBED AND 1-1/4" MIN EDGE DISTANCE (3000 psi MIN CONCRETE)	33	12.0"	12.0"	12.0"	12.0"	12.0"	11.5"	12.0"	11.5"	7.5"
		38	12.0"	12.0"	12.0"	12.0"	12.0"	10.0"	12.0"	10.0"	6.5"
		43	12.0"	12.0"	12.0"	12.0"	12.0"	9.0"	12.0"	8.5"	5.5"
		48	12.0"	12.0"	12.0"	12.0"	12.0"	8.0"	12.0"	8.0"	5.0"
		53	12.0"	12.0"	12.0"	12.0"	10.5"	7.0"	12.0"	7.0"	4.5"
		58	12.0"	12.0"	12.0"	12.0"	10.0"	6.5"	12.0"	6.5"	4.0"

HOST STRUCT.	ANCHOR	LOAD (psf)	ANCHOR SPACING BY SPAN AND CONNECTION TYPE								
			Spans Up To 2'-8"			Spans Up To 6'-6"			Spans Up To 9'-10"		
			CONN TYPE			CONN TYPE			CONN TYPE		
HOLLOW BLOCK or GROUP-FILLED BLOCK	1/4" ITW TAPCON WITH 1" EMBED AND 2" MIN EDGE DISTANCE (1900 psi MIN CMU)	33	12.0"	12.0"	12.0"	12.0"	12.0"	6.0"	8.5"	8.0"	4.0"
		38	12.0"	12.0"	12.0"	11.0"	10.5"	5.0"	7.5"	7.0"	
		43	12.0"	12.0"	11.5"	10.0"	9.5"	4.5"	6.5"	6.0"	
		48	12.0"	12.0"	10.5"	9.0"	8.5"	4.0"	6.0"	5.5"	
		53	12.0"	12.0"	9.5"	8.0"	7.5"		5.0"	5.0"	
		58	12.0"	12.0"	8.5"	7.5"	7.0"		5.0"	4.5"	
	1/4" DEWALT ULTRACON WITH 1-1/4" EMBED AND 1" MIN EDGE DISTANCE (1900 psi MIN CMU)	33	12.0"	12.0"	12.0"	12.0"	12.0"	7.0"	11.0"	8.5"	4.5"
		38	12.0"	12.0"	12.0"	12.0"	11.5"	6.0"	9.5"	7.5"	4.0"
		43	12.0"	12.0"	12.0"	12.0"	10.0"	5.5"	8.5"	6.5"	3.5"
		48	12.0"	12.0"	12.0"	11.5"	9.0"	5.0"	7.5"	6.0"	3.0"
		53	12.0"	12.0"	11.0"	10.5"	8.0"	4.5"	7.0"	5.5"	3.0"
		58	12.0"	12.0"	10.0"	9.5"	7.5"	4.0"	6.5"	5.0"	
	1/4" ELCO PANELMATE (FEMALE, MALE, or PLUS) W/ 1-1/4" EMBED AND 2" MIN EDGE DISTANCE (2000 psi MIN CMU)	33	12.0"	12.0"	12.0"	12.0"	12.0"	10.0"	12.0"	11.5"	6.5"
		38	12.0"	12.0"	12.0"	12.0"	12.0"	8.5"	12.0"	10.0"	5.5"
		43	12.0"	12.0"	12.0"	12.0"	12.0"	7.5"	12.0"	9.0"	5.0"
		48	12.0"	12.0"	12.0"	12.0"	12.0"	6.5"	11.0"	8.0"	4.5"
		53	12.0"	12.0"	12.0"	12.0"	11.0"	6.0"	10.0"	7.0"	4.0"
		58	12.0"	12.0"	12.0"	12.0"	10.0"	5.5"	9.0"	6.5"	
	1/4-20 ALL POINTS SOLID- SET WITH 7/8" EMBED AND 1-1/4" MIN EDGE DISTANCE (1800 psi MIN CMU)	33	12.0"	12.0"	12.0"	12.0"	11.0"	6.5"	12.0"	7.0"	4.0"
		38	12.0"	12.0"	12.0"	12.0"	9.5"	5.5"	10.5"	6.0"	
		43	12.0"	12.0"	12.0"	12.0"	8.0"	5.0"	9.0"	5.5"	
		48	12.0"	12.0"	11.0"	12.0"	7.5"	4.5"	8.0"	5.0"	
		53	12.0"	12.0"	10.0"	11.5"	6.5"	4.0"	7.5"	4.5"	
		58	12.0"	12.0"	9.0"	10.5"	6.0"		7.0"	4.0"	

ANCHOR NOTES:

- ANCHOR SCHEDULE APPLIES TO ALL PRODUCTS CERTIFIED HEREIN, BUT ONLY PROVIDES MAXIMUM ALLOWABLE ANCHOR SPACING. MAXIMUM ALLOWABLE SPANS AND PRESSURES INDICATED IN SPAN SCHEDULE SHALL APPLY.
- ENTER ANCHOR SCHEDULE BASED ON PANEL FASTENER SPACING, THE EXISTING STRUCTURE MATERIAL, & ANCHOR TYPE. SELECT DESIGN LOAD GREATER THAN OR EQUAL TO NEGATIVE DESIGN LOAD ON SHUTTER AND SELECT SPAN GREATER THAN OR EQUAL TO SHUTTER SPAN. SELECT CONNECTION TYPE BASED ON APPROPRIATE MOUNTING CONDITION (SEE MOUNTING DETAILS ON SHEET 3 FOR IDENTIFICATION OF CONNECTION TYPE).
- "PANEL FASTENERS" ARE STUDS USED IN CONJUNCTION WITH ALL MOUNTING EXTRUSIONS ("F"-TRACK, STUDDER ANGLE, ETC.). "PANEL FASTENERS" SHALL BE SPACED AT 12" O.C. ALL END PANEL HOLES SHALL HAVE PANEL FASTENERS, TYP.
- ANCHORS SHALL BE INSTALLED IN ACCORDANCE WITH MANUFACTURERS' RECOMMENDATIONS.
- HOLLOW BLOCK HOST STRUCTURE SHALL CONFORM TO ASTM C90 BLOCK.
- MINIMUM EMBEDMENT SHALL BE AS NOTED IN ANCHOR SCHEDULE.
- MINIMUM EMBEDMENT AND EDGE DISTANCE EXCLUDES STUCCO, FOAM, BRICK, AND OTHER WALL FINISHES. WALL FINISHES SHALL BE LIMITED TO 1/4" MAX OR SHALL BE VERIFIED BY OTHERS TO ADEQUATELY TRANSFER LOADS TO HOST STRUCTURE.
- CONCRETE ANCHORS NOTED HEREIN SHALL BE EMBEDDED TO UN-CRACKED CONCRETE ONLY.
- WHERE EXISTING STRUCTURE IS WOOD FRAMING, EXISTING CONDITIONS MAY VARY. FIELD VERIFY THAT FASTENERS ARE INTO ADEQUATE WOOD FRAMING MEMBERS, NOT PLYWOOD. FASTENING TO PLYWOOD IS ACCEPTABLE ONLY FOR SIDE CLOSURE PIECES.
- WHERE ANCHORS FASTEN TO NARROW FACE OF STUD FRAMING, FASTENER SHALL BE LOCATED IN CENTER OF NOMINAL 2" X 4" (MIN.) WOOD STUD (3/4" EDGE DISTANCE IS ACCEPTABLE FOR WOOD FRAMING). WOOD STUD SHALL BE G=0.42 OR GREATER DENSITY, U.N.O. LAG SCREWS SHALL HAVE PHILLIPS PAN HEAD OR HEX HEAD.
- REMOVABLE ANCHORS ARE: DEWALT PANELMATE, ALL-POINTS SOLID-SET.
- MACHINE SCREWS SHALL HAVE 1/2" MINIMUM ENGAGEMENT OF THREADS INTO THE BASE ANCHOR AND MAY HAVE EITHER A PAN HEAD, TRUSS HEAD, OR WAFER HEAD (SIDEWALK BOLT) U.N.O.
- DESIGNATES ANCHOR CONDITIONS WHICH ARE NOT ACCEPTABLE USES.
- DIRECT MOUNTING CONDITIONS.
- LINEAR INTERPOLATION IS NOT PERMITTED FOR USE WITH THE ANCHOR SCHEDULES LISTED ON THIS SHEET.
- PROVIDE KEYHOLE WASHER FOR 1/4-20 SIDEWALK BOLTS (OR TRUSS HEAD SCREWS).

COPIES NOT VALID FOR PERMIT

COPIES NOT VALID FOR PERMIT

PE SEAL
REQUIRED
03/05/2021
CERTIFYING ENGINEER AND CERT
OF AUTH AS LISTED ON STAMP
VALID FOR 1 PERMIT ONLY U.N.O.

DIGITAL SEAL NOTICE:
IF THIS DOCUMENT IS DIGITALLY
SIGNED, THIS SHEET IS PART OF A
DIGITALLY SIGNED FILE. IT SHALL
REMAIN IN DIGITAL FORMAT, SHALL
BE VERIFIED BY ELECTRONIC MEANS,
& PRINTED COPIES OF THIS
DOCUMENT ARE NOT CONSIDERED
SIGNED AND SEALED.
PRINTED DOCUMENT NOTICE:
IF THIS DOCUMENT IS PRINTED &
DOES NOT CONTAIN AN ENGINEER'S
ORIGINAL SIGNATURE & SEAL, THIS
DOCUMENT IS VOID & NOT VALID FOR
USE. PHOTOCOPIES ARE NOT
PERMITTED FOR USE.

ENGINEERING
EXPRESS®
CORPORATE OFFICE:
160 SW 12th AVE, SUITE 106
DEERFIELD BEACH, FL 33442
(954) 354-0660 | (866) 396-9999
TEAM@ENGINEERINGEXPRESS.COM
ENGINEERINGEXPRESS.COM

EASTERN METAL SUPPLY
4268 WESTROADS DR
WEST PALM BEACH, FL
(800) 432-2204
2" X 24GA STEEL STORM PANEL
FBC 7TH ED (2020) & IBC (2018)
ASCE 7-16 & 7-10

REMARKS	DRWN	CHKD	DATE
INIT ISSUE	CSL	RWN	7/24/20
	-	-	-
	-	-	-
	-	-	-
	-	-	-
	-	-	-

THIS DOCUMENT IS THE PROPERTY OF ENGINEERING EXPRESS, AND SHALL NOT BE REPRODUCED IN WHOLE OR PART WITHOUT WRITTEN CONSENT OF ENGINEERING EXPRESS. ALTERATIONS, ADDITIONS, OR OTHER MARKINGS TO THIS DOCUMENT ARE NOT PERMITTED AND INVALIDATE OUR CERTIFICATION.

COPYRIGHT ENGINEERING EXPRESS®

21-37455

SCALE: NTS UNLESS NOTED

4 OF 4