

1. THIS SYSTEM HAS BEEN DESIGNED AND SHALL BE FABRICATED IN ACCORDANCE WITH THE REQUIREMENTS OF THE FLORIDA BUILDING CODE SIXTH EDITION (2017).
2. DESIGN BASED ON ASCE 7-10 USING $V_{ult} = 115\text{MPH} / V_{asd} = 90\text{MPH}$ (3 SEC GUST, UP TO 6'-0" WITHIN OR OUTSIDE HVHZ), INCLUDING EXPOSURE 'D', RISK CATEGORY I, USING THE 'OPEN SIGN METHOD'. SEISMIC DESIGN DOES NOT GOVERN.
3. **FOR POOL APPLICATIONS**, PER FBC 454.2.17.1.8: POOL ACCESS GATES WHEN PROVIDED SHALL COMPLY WITH FBC 454.2 AND MUST BE AT LEAST 48" ABOVE GRADE & EQUIPPED WITH A SELF CLOSING, SELF LATCHING LOCKING DEVICE NOT LESS THAN 54" FROM BOT OF GATE. GATE MUST OPEN OUTWARD AWAY FROM POOL & MUST HAVE NO OPENING $>1/2"$ WITHIN 18" OF RELEASE MECHANISM.
4. **FOR NON-POOL APPLICATIONS REQUIRING EGRESS**: PER FLORIDA FIRE PREVENTION CODE 6TH EDITION, NFPA 1, 101, 2017 EDITION, GATES REQUIRING EGRESS SHALL HAVE NO LATCHES AND BE FREE SWINGING FOR QUICK EXITING. GATE SHALL HAVE SELF-CLOSING HINGES ONLY.
5. **THIS FENCE DESIGN TO BE USED AT LEVEL GROUND SURFACE ONLY, WITH USE LIMITED TO DECORATIVE BARRIER PURPOSES ONLY. THIS FENCE IS NOT INTENDED TO MEET CODES GOVERNING ELEVATED BALCONIES OR STRUCTURAL RAILINGS.**
6. ALL FASTENERS TO BE #12 X $3/4"$ OR GREATER SERIES 400 NON-MAGNETIC STAINLESS STEEL, OR CADMIUM PLATED OR OTHERWISE CORROSION RESISTANT MATERIAL.
7. ALUMINUM WELDING SHALL BE IN ACCORDANCE WITH 2017 FBC SECTION 2003.8.1.4 WITH WELD FILLER ALLOYS MEETING ANSI/AWS A5.10 STANDARDS; ALL ALUMINUM CONSTRUCTION SHALL BE IN CONFORMANCE WITH THE TOLERANCES, QUALITY AND METHODS OF CONSTRUCTION AS SET FORTH IN FBC SECTION 2003.2. MINIMUM WELD IS $1/8"$ THROAT FULL PERIMETER FILLET WELD UNLESS OTHERWISE NOTED.
8. ALL EXTRUDED MEMBERS SHALL BE ALUMINUM ALLOY TYPE 6063-T6 OR BETTER, U.N.O.
9. ALL CONCRETE SHALL BE UNCRACKED ONLY WITH A MINIMUM COMPRESSIVE STRENGTH OF 3000 PSI U.N.O. AND SHALL BE MINIMUM 1.5X THICKER THAN ANY MEMBER EMBEDMENT. ALL EPOXY AND GROUT SHALL MEET OR EXCEED COMPRESSIVE STRENGTH OF THE CONCRETE AND SHALL BE IRON-FREE, NON-SHRINK AND NON-REACTIVE. CONCRETE FOOTERS SHALL CONTAIN MIN 0.1% FIBERMESH ADMIXTURE PER CY.
10. SURROUNDING SOIL TO BE COMPACTED TO 95% OPTIMUM DENSITY, 2000 PSF MIN AND SHALL BE CLASSIFIED OR VERIFIED BY OTHERS PRIOR TO CONSTRUCTION PER FBC 1806.2 AND SHALL BE SANDY GRAVEL CLASS ONLY. NOTE: THE FENCE IS DESIGNED SUCH THAT IT MAY LIST IN SATURATED SOIL AT PEAK WINDS BUT REMAIN INTACT AS PERMITTED BY CODE.
11. THE CONTRACTOR IS RESPONSIBLE TO INSULATE ALL MEMBERS FROM DISSIMILAR MATERIALS TO PREVENT ELECTROLYSIS.
12. ELECTRICAL GROUND, WHEN REQUIRED, TO BE DESIGNED & INSTALLED BY OTHERS.
13. ENGINEER SEAL AFFIXED HERETO VALIDATES STRUCTURAL DESIGN AS SHOWN ONLY. USE OF THIS SPECIFICATION BY CONTRACTOR, et. al. INDEMNIFIES & SAVES HARMLESS THIS ENGINEER FOR ALL COST & DAMAGES INCLUDING LEGAL FEES & APPELLATE FEES RESULTING FROM MATERIAL FABRICATION, SYSTEM ERECTION, CONSTRUCTION PRACTICES BEYOND THAT WHICH IS CALLED FOR BY LOCAL, STATE, & FEDERAL CODES & FROM DEVIATIONS OF THIS PLAN.
14. THIS DOCUMENT IS GENERIC AND DOES NOT PERTAIN TO ANY SPECIFIC PROJECT SITE. ENGINEERING EXPRESS SHALL NOT BE HELD RESPONSIBLE OR LIABLE IN ANY WAY FOR ERRONEOUS OR INACCURATE DATA OR MEASUREMENTS. DIMENSIONS ARE SHOWN TO ILLUSTRATE DESIGN FORCES AND OTHER DESIGN CRITERIA. THEY MAY VARY SLIGHTLY, BUT MUST REMAIN WITHIN THE LIMITATIONS SPECIFIED HEREIN. WORK SHALL BE FIELD VERIFIED BY OTHERS. ENGINEERING EXPRESS SHALL BE NOTIFIED AND GIVEN AN OPPORTUNITY TO REEVALUATE OUR WORK UPON DISCOVERY OF ANY INACCURATE INFORMATION PRIOR TO MODIFICATION OF EXISTING FIELD CONDITIONS AND FABRICATION AND INSTALLATION OF MATERIALS. ALTERATIONS OR ADDITIONS TO THIS DOCUMENT ARE NOT PERMITTED AND INVALIDATE OUR CERTIFICATION.
15. EXCEPT AS EXPRESSLY PROVIDED HEREIN, NO ADDITIONAL CERTIFICATIONS OR AFFIRMATIONS ARE INTENDED.

COPYRIGHT ENGINEERING EXPRESS®

17-5512

SCALE: NTS UNLESS NOTED

1 OF 4



- BASE PLATE CONNECTION OPTION
(4) $\frac{5}{16}$ " X 3" ITW BUILDEX TAPCONS 4"
FROM ANY CONC FACE

— PANEL INSERTS MAY VARY, SEE EXTRUSION OPTIONS SHEET 4

CORNER ISOMETRICS

2
OF
4

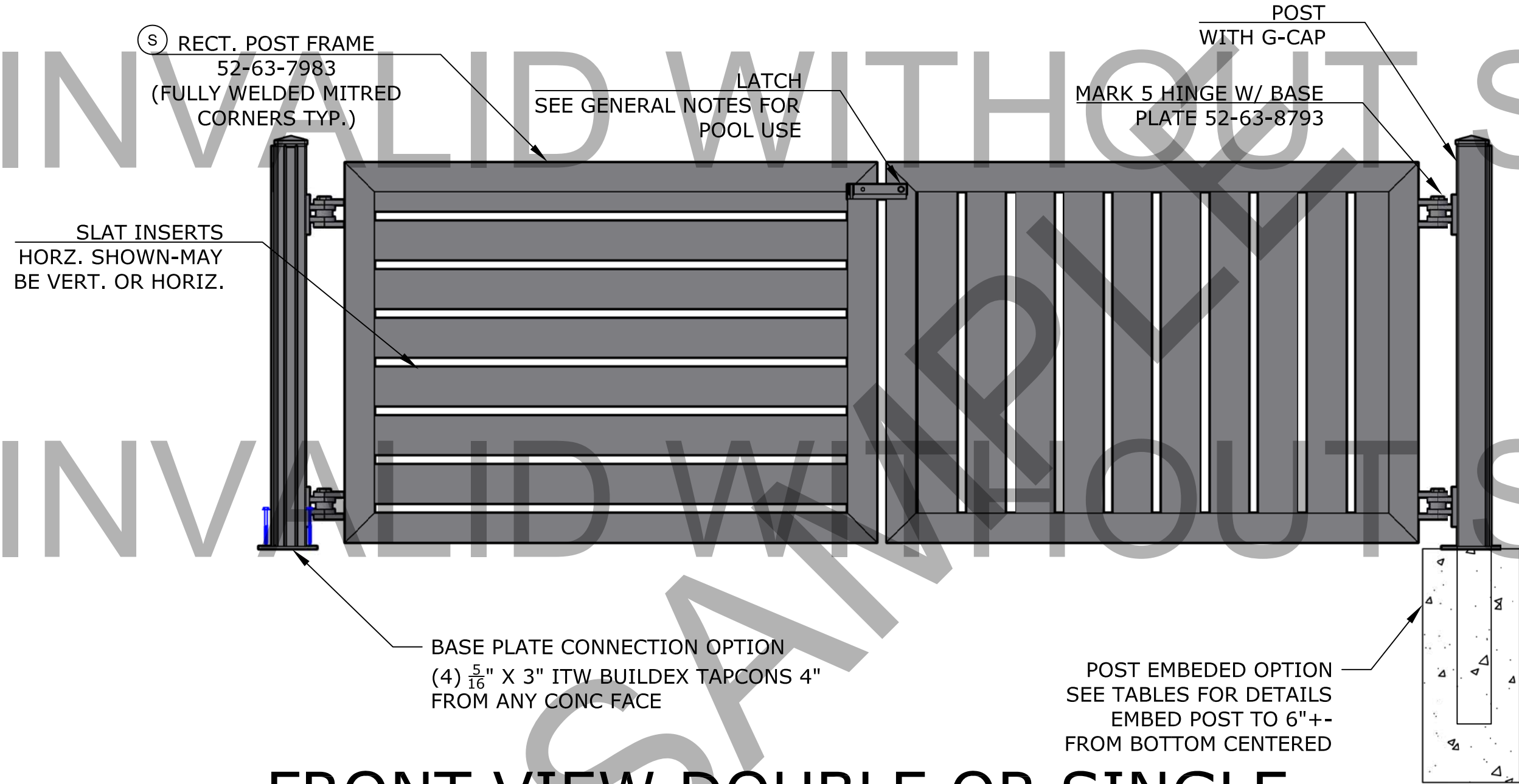
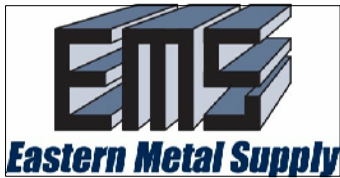

FRONT VIEW DOUBLE OR SINGLE
SWING GATE
(SINGLE GATE SIMILAR)

FRANK L. BENNARD, P.E.
PE# 0046549

07/19/2018

☐ IF CHECKED, CERTIFYING P.E. APPEARS BELOW
SEALING ENGINEER AND
PE# APPEARS IN SEAL
VALID ONLY WITH RAISED ENGINEER SEAL

VALID FOR 1 PERMIT ONLY U.N.O.

NOTICE: IF THIS SHEET DOES
NOT CONTAIN AN ORIGINAL
SIGNATURE & ENGINEER SEAL:
IF THERE IS A DIGITAL
SIGNATURE ON SHEET 1, THIS
SHEET IS PART OF A DIGITALLY
SIGNED FILE, SHALL REMAIN IN
DIGITAL FORMAT, & PRINTED
COPIES OF THIS DOCUMENT
ARE NOT CONSIDERED SIGNED
AND SEALED. IF THERE IS NO
DIGITAL SIGNATURE ON SHEET 1
OR THIS SHEET DOES NOT
CONTAIN AN ENGINEER'S
ORIGINAL SIGNATURE & SEAL,
THIS SHEET IS A COPY/DRAFT.

ENGINEERING
EXPRESS®

CORPORATE OFFICE:
160 SW 12th AVE, SUITE 106
DEERFIELD BEACH, FL 33442
P: (954) 354-0660 F: (954) 354-0443
E: HELLO@ENGINEERINGEXPRESS.COM
ENGINEERINGEXPRESS.COM
CERT OF AUTH #9885

EASTERN METAL SUPPLY
4268 WESTROADS DR
WEST PALM BEACH, FL 33407
PH: (800) 432-2204

3" UNIVERSAL POST PANEL
ENCLOSURE SYSTEM
MASTER PLAN SHEET

REMARKS	DRWN	CHKD	DATE
CREATED	FLB	FLB	2/6/18
	-	-	-
	-	-	-
	-	-	-
	-	-	-

THIS DOCUMENT IS THE PROPERTY OF ENGINEERING EXPRESS,
AND SHALL NOT BE REPRODUCED IN WHOLE OR PART WITHOUT
WRITTEN CONSENT OF ENGINEERING EXPRESS. ALTERATIONS,
ADDITIONS OR OTHER MARKINGS TO THIS DOCUMENT ARE NOT
PERMITTED AND INVALIDATE OUR CERTIFICATION.

COPYRIGHT ENGINEERING EXPRESS®

17-5512

SCALE: NTS UNLESS NOTED

3

OF 4

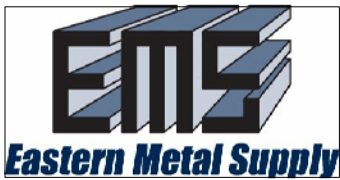
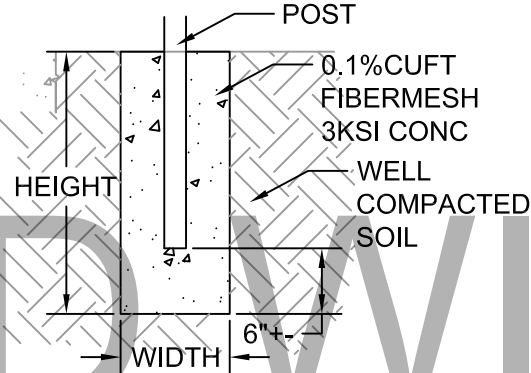

TABLE 1 - FOOTING SIZING TABLE

POST HEIGHT	POST WIDTH (SQUARE OR ROUND)				
	4'-0"	5'-0"	6'-0"	7'-0"	8'-0"
48"	10"X24"	10"X24"	12"X26"	12" X 26"	12" X 30"
60"	10"X24"	10"X24"	12"X30"	12" X 30"	14" X 30"
72"	10"X24"	12"X30"	12"X30"	14 X 30"	14" X 34"



POSTS

ALL PARTS 6063-T6 U.N.O.

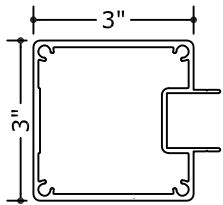

(A)
3" X 0.093"
STARTER POST
EMS-57-63-120

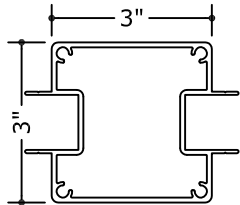

(C)
3" X 0.093"
INLINE POST
EMS-57-63-100

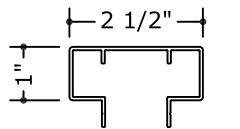

(D)
3" TOP CAP
EMS-57-63-110

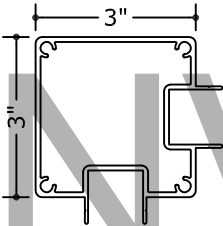

(B)
3" X 0.093"
CORNER POST
EMS 57-63-130

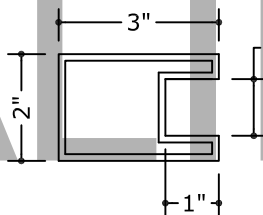

(S)
2 X 3 X 0.093"
RECTANGULAR
POST FRAME
EMS-52-63-7983

COMPONENTS

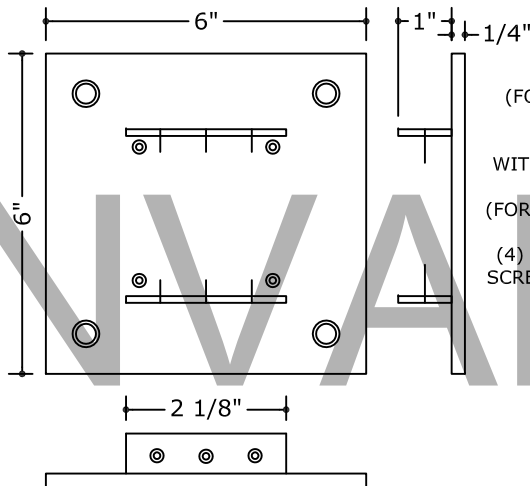

(E)
6" POST BASE PLATE
(FOR CORNERS-WITHOUT TABS)
EMS-10-61-36SF

WITH 1" X 1" X 1/8" WELDED TABS
EMS-11-63-225
(FOR ALL INLINE & STARTER POSTS)

(4) #14 SELF TAPPING FLAT HEAD
SCREWS BASE PLATE TO POST & (3)
EA SIDE TO WELDED TAB

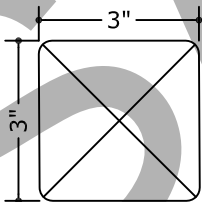

(G)
3" Flush Mount
Square Post Cap
21-00-763 (FL)

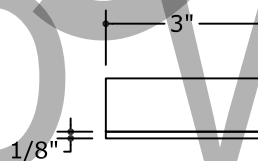

(R)
1"X1"X1/8" ANGLE
57-63-110 (FL)
6063-T6
MI-031642

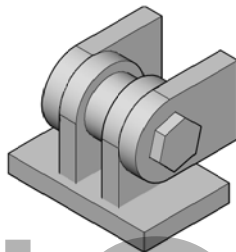

MARK 5 GATE HINGE
(HEAVY DUTY)
52-63-8763
WITH BASE PLATE
MARK 4 GATE HINGE
(HEAVY DUTY)
52-63-9150
WITHOUT BASE PLATE

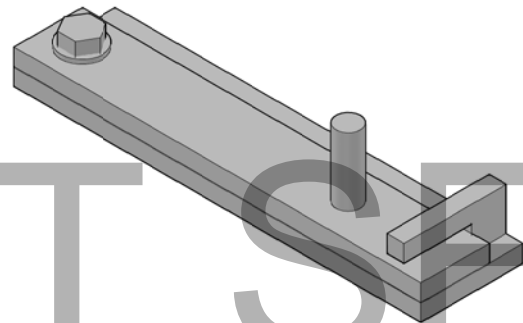

GATE LATCH

EXTRUSIONS

ALL PARTS 6063-T6 U.N.O.

PANEL INSERTS

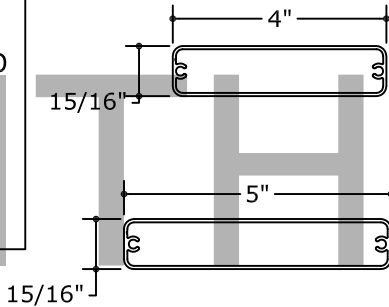

(H)
0.938 X 4 SLAT
57-63-110 (FL)
6063-T6

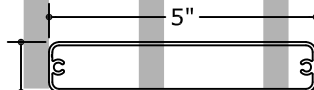

(I)
4" X 0.093" RADIUS TUBE
EMS-40-63-724

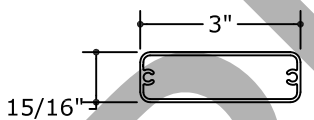

(J)
3" X 0.093"
RADIUS TUBE
EMS-40-63-722

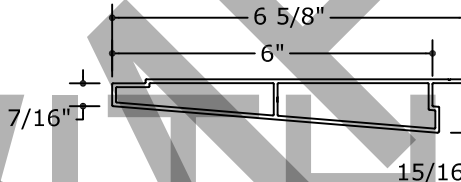

(N)
6" X 0.093"
HARDY PLANK
EMS-40-63-729

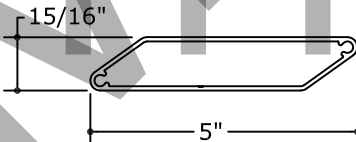

(L)
5" X 0.093"
SHADOW BOX PANEL
EMS-56-63-905

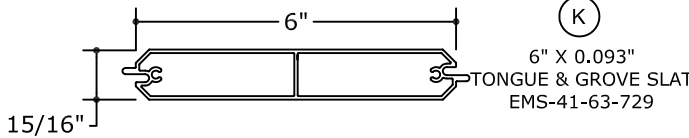

(K)
6" X 0.093"
TONGUE & GROOVE SLAT
EMS-41-63-729

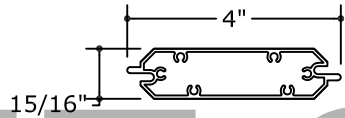

(O)
4" X 0.093"
TONGUE & GROOVE SLAT
EMS-52-63-7686

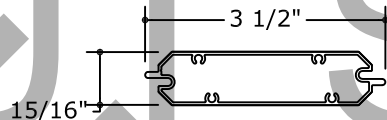

(T)
3.5" X 0.093"
TONGUE & GROOVE SLAT
EMS-4063-327

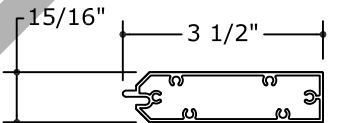

(U)
3.5" X 0.093"
TONGUE & GROOVE STARTER
EMS-

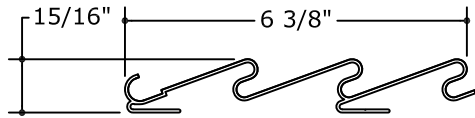

(P)
2" FIXED BAHAMA TRIPLE
BLADE
EMS-41-63-700

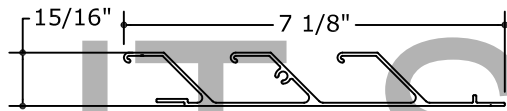

(Q)
7" VENTED WALL PANEL
EMS-65-63-100



(R)
5.5" SOLID
ENDECK PANEL

FRANK L. BENNARD, P.E.
PE# 0046549

07/19/2018

IF CHECKED, CERTIFYING P.E. APPEARS BELOW
SEALING ENGINEER AND
PE# APPEARS IN SEAL
VALID ONLY WITH RAISED ENGINEER SEAL
VALID FOR 1 PERMIT ONLY U.N.O.

NOTICE: IF THIS SHEET DOES
NOT CONTAIN AN ORIGINAL
SIGNATURE & ENGINEER SEAL:

IF THERE IS A DIGITAL
SIGNATURE ON SHEET 1, THIS
SHEET IS PART OF A DIGITALLY
SIGNED FILE, SHALL REMAIN IN
DIGITAL FORMAT, & PRINTED
COPIES OF THIS DOCUMENT
ARE NOT CONSIDERED SIGNED
AND SEALED. IF THERE IS NO
DIGITAL SIGNATURE ON SHEET 1
OR THIS SHEET DOES NOT
CONTAIN AN ENGINEER'S
ORIGINAL SIGNATURE & SEAL,
THIS SHEET IS A COPY/DRAFT.



CORPORATE OFFICE:
160 SW 12th AVE, SUITE 106
DEERFIELD BEACH, FL 33442
P: (954) 354-0660 F: (954) 354-0443
E: HELLO@ENGINEERINGEXPRESS.COM
ENGINEERINGEXPRESS.COM
CERT OF AUTH #9885

EASTERN METAL SUPPLY

4268 WESTROADS DR

WEST PALM BEACH, FL 33407

PH: (800) 432-2204

3" UNIVERSAL POST PANEL

ENCLOSURE SYSTEM

MASTER PLAN SHEET

REMARKS	DATE	DRWN	CHKD
CREATED	2/6/18	FLB	FLB

COPYRIGHT ENGINEERING EXPRESS®

17-5512
SCALE: NTS UNLESS NOTED

4 OF 4