

STEP 1: DETERMINE WIND VELOCITY PER LOCATION, RISK, AND EXPOSURE

ASCE 7-10 & 7-16 ULT WIND VELOCITY TO ASD DESIGN PRESSURE AT GRADE CONVERSION CHART - HVHZ OR NON HVHZ									
EXAMPLE COUNTY	RISK	EXPOSURE		RISK	EXPOSURE		RISK	EXPOSURE	
	I	C	D	II	C	D	III, IV	C	D
FORT MYERS	145 MPH	29.4 PSF	35.6 PSF	160 MPH	35.8 PSF	43.4 PSF	175 MPH	42.8 PSF	51.9 PSF
PALM BEACH	150 MPH	31.5 PSF	38.1 PSF	170 MPH	40.4 PSF	49.0 PSF	180 MPH	45.3 PSF	54.9 PSF
BROWARD	156 MPH	34.0 PSF	41.2 PSF	170 MPH	40.4 PSF	49.0 PSF	180 MPH	45.3 PSF	54.9 PSF
MIAMI-DADE	165 MPH	38.1 PSF	46.1 PSF	175 MPH	42.8 PSF	51.9 PSF	186 MPH	48.4 PSF	58.6 PSF
MONROE	175 MPH	42.8 PSF	51.9 PSF	180 MPH	45.3 PSF	54.9 PSF	200 MPH	55.9 PSF	67.8 PSF
Kz (Exp C/D) (Table 26.10-1) =		0.85	1.03	Kd (Table 26.6-1) =		0.9	G (Section 26.11) =		0.85
Kzt (Section 26.8.2) =		1.0		Ke (Section 26.9) =		1	Cf (Table 29.4-1) =		1.4

NOTE: TABLE ABOVE INCLUDES A QUICK REFERENCE OF COMMON FLORIDA CONDITIONS (AT ULTIMATE DESIGN WIND VELOCITIES) FOR SITE-SPECIFIC CONDITIONS, CONSULT LOCAL BUILDING MUNICIPALITY. MAXIMUM DESIGN WIND PRESSURES AT GRADE PER SPECIFIED EXPOSURE REMAIN CONSTANT FOR ANY MAX WIND VELOCITY. FOR SITE-SPECIFIC WIND VELOCITY AND PRESSURE CONVERSIONS, SEE QR LINK PROVIDED BELOW.

STEP 2: DETERMINE ALLOWABLE WIND PRESSURE PER CONCRETE PAD & UNIT

TABLE 2: ALLOWABLE LATERAL ASD PRESSURE FOR PAD / GENERATOR COMBINATION									
PAD & BASE		PAD + BASE WEIGHT, LB	GENERATOR UNIT				DESIGN ALLOWANCES		
PAD + BASE HEIGHT, IN	BASE REQ'D WIDTH, IN		MAX L IN	MAX W IN	MAX H IN	MIN WT, LB	ALLOWABLE ASD PRESSURE	EXP C	EXP D
12 in	46 in	3250 lbs	29	63	34	750	70.0 PSF	200 MPH	200 MPH
			31	63	39	750	70.0 PSF	200 MPH	200 MPH
			37	73	37	1000	70.0 PSF	200 MPH	200 MPH
			34	77	45	1200	60.8 PSF	200 MPH	186 MPH
			35	77	47	1200	57.0 PSF	200 MPH	180 MPH
			36	80	50	1500	53.9 PSF	195 MPH	175 MPH
18 in	46 in	3697 lbs	29	63	34	750	70.0 PSF	200 MPH	200 MPH
			31	63	39	750	62.7 PSF	200 MPH	190 MPH
			37	73	37	1000	64.2 PSF	200 MPH	190 MPH
			34	77	45	1200	50.8 PSF	190 MPH	170 MPH
			35	77	47	1200	48.0 PSF	180 MPH	165 MPH
			36	80	50	1500	45.7 PSF	180 MPH	160 MPH
24 in	50 in	4328 lbs	29	63	34	750	67.6 PSF	200 MPH	195 MPH
			31	63	39	750	59.1 PSF	200 MPH	186 MPH
			37	73	37	1000	60.2 PSF	200 MPH	186 MPH
			34	77	45	1200	49.0 PSF	186 MPH	165 MPH
			35	77	47	1200	46.6 PSF	180 MPH	165 MPH
			36	80	50	1500	44.5 PSF	175 MPH	160 MPH
30 in	54 in	4959 lbs	29	63	34	750	63.5 PSF	200 MPH	190 MPH
			31	63	39	750	56.3 PSF	200 MPH	180 MPH
			37	73	37	1000	57.3 PSF	200 MPH	180 MPH
			34	77	45	1200	47.5 PSF	180 MPH	165 MPH
			35	77	47	1200	45.4 PSF	180 MPH	160 MPH
			36	80	50	1500	43.6 PSF	175 MPH	160 MPH
36 in	58 in	5590 lbs	29	63	34	750	60.3 PSF	200 MPH	186 MPH
			31	63	39	750	54.2 PSF	195 MPH	175 MPH
			37	73	37	1000	54.9 PSF	195 MPH	180 MPH
			34	77	45	1200	46.4 PSF	180 MPH	165 MPH
			35	77	47	1200	44.5 PSF	175 MPH	160 MPH
			36	80	50	1500	42.9 PSF	175 MPH	156 MPH
42 in	62 in	6221 lbs	29	63	34	750	57.8 PSF	200 MPH	180 MPH
			31	63	39	750	52.4 PSF	190 MPH	175 MPH
			37	73	37	1000	53.1 PSF	190 MPH	175 MPH
			34	77	45	1200	45.5 PSF	180 MPH	160 MPH
			35	77	47	1200	43.8 PSF	175 MPH	160 MPH
			36	80	50	1500	42.3 PSF	170 MPH	156 MPH
48 in	66 in	6851 lbs	29	63	34	750	55.7 PSF	195 MPH	180 MPH
			31	63	39	750	51.0 PSF	190 MPH	170 MPH
			37	73	37	1000	51.5 PSF	190 MPH	170 MPH
			34	77	45	1200	44.7 PSF	175 MPH	160 MPH
			35	77	47	1200	43.2 PSF	175 MPH	156 MPH
			36	80	50	1500	41.8 PSF	170 MPH	156 MPH

TABLE 2 NOTES:
1- PAD + BASE WEIGHT CALCULATED BASED ON 150 PCF MIN CONCRETE & 1.25 PCF EPS FOAM CORE.
2- CONCRETE MIN COMPRESSIVE STRENGTH TO BE f'c=6,000 PSI AT 28 DAYS.
3- CONCRETE PAD + BASE HEIGHT ARE MAXIMUMS FOR RATINGS PROVIDED. (EX: RATINGS FOR 18 IN TALL PAD ARE ALSO APPLICABLE FOR 13 IN TO 17 IN PADS).
4- GENERATOR UNIT SIZE TO BE EQUAL OR SMALLER IN ALL DIMENSIONS FOR EACH TABLE ENTRY (EX: FOR 34" X 77" X 45", 1200 LB - ANY UNIT EQUAL OR SMALLER IN ALL DIMENSIONS IS EQUIVALENTLY RATED, BUT THIS RATING WOULD NOT EXTEND TO A 50" TALL UNIT OR 1000 LB UNIT)
5- GENERATOR UNIT WEIGHT TO BE EQUAL OR GREATER THAN SHOWN FOR EACH RATING. (EX: 750 LB UNIT RATING APPLICABLE FOR UNITS 750 LBS AND HEAVIER).
6- GENERATOR'S MANUFACTURER SPECS TO BE PROVIDED WITH THIS MASTER PLAN SHEET FOR SUBMISSION & CERTIFICATION.
7- FOR UNITS OR CONDITIONS REQUIRING GREATER ALLOWABLE PRESSURE, ADDITIONAL ENGINEERING MAY BE REQUIRED.

DOUBLE PAD ISOMETRIC VIEW

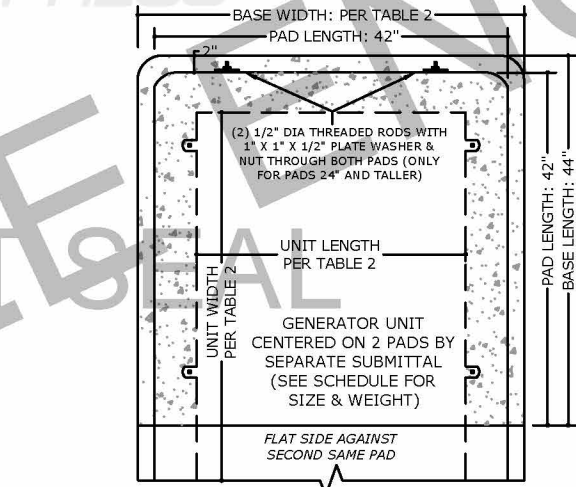

SINGLE 42X42 PAD DIMENSION PLAN VIEW (2 REQUIRED FOR DOUBLE PAD)

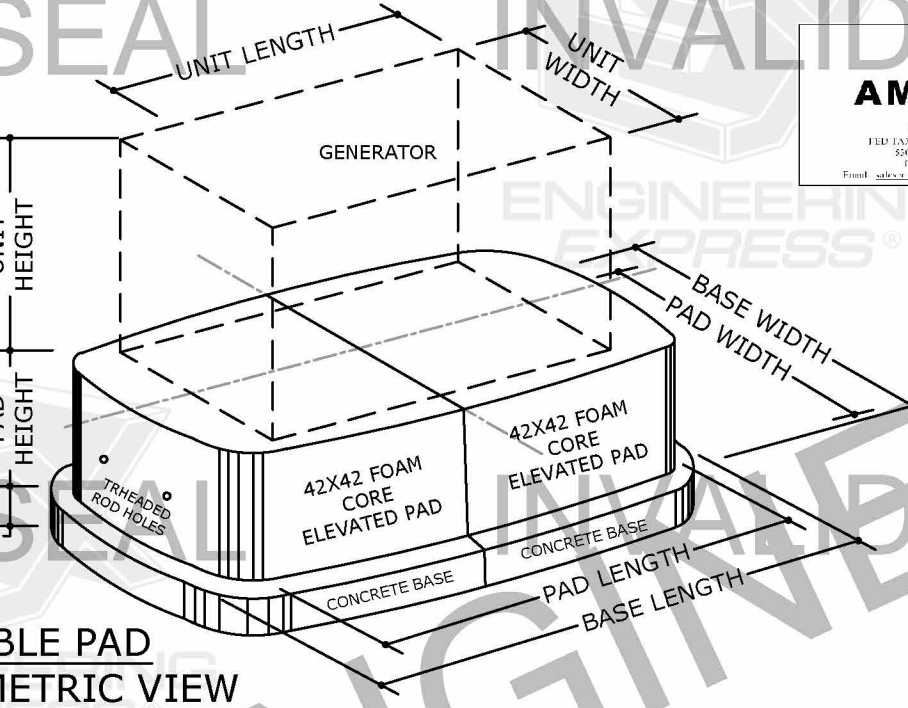
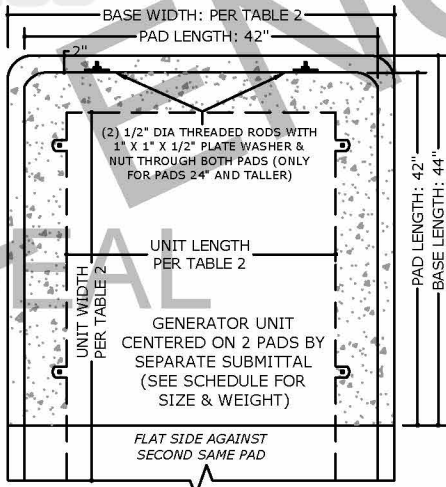

FOR ALL PADS 24" AND TALLER (PER TABLE 2), INCLUDE (2) 1/2" DIA THREADED RODS WITH 1" X 1" X 1/2" PLATE WASHER & DOUBLE NUTON EACH SIDE (LONGWAYS, THROUGH BOTH PADS)

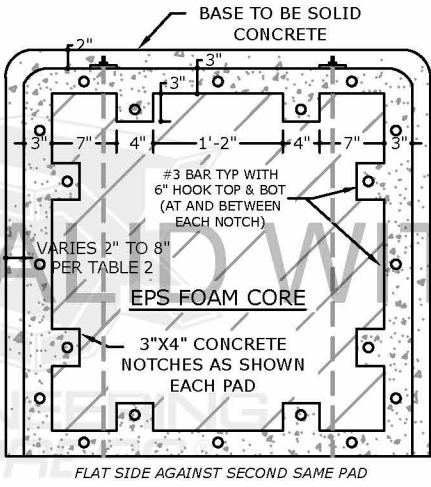

SINGLE 42X42 PAD SECTION & REINFORCEMENT PLAN VIEW (2 REQUIRED FOR DOUBLE PAD)

ALLOWABLE DESIGN PRESSURE
REQUIRED WIND LOAD DESIGN PRESSURES CALCULATED FOR USE WITH THIS SYSTEM SHALL BE DETERMINED UNDER SEPARATE CERTIFICATION ON A JOB-SPECIFIC BASIS IN ACCORDANCE WITH THE GOVERNING CODE. SITE-SPECIFIC LOAD REQUIREMENTS AS DETERMINED IN ACCORDANCE WITH THE APPLICABLE BUILDING CODE SHALL BE LESS THAN OR EQUAL TO THE POSITIVE OR NEGATIVE DESIGN PRESSURE "ASD" CAPACITY VALUES LISTED HEREIN FOR ANY ASSEMBLY AS SHOWN.

COPIES NOT VALID FOR PERMIT

COPIES NOT VALID FOR PERMIT

DESIGN NOTES

- THIS SYSTEM HAS BEEN DESIGNED AND SHALL BE FABRICATED IN ACCORDANCE WITH THE REQUIREMENTS OF THE FLORIDA BUILDING CODE SIXTH & SEVENTH EDITION (2017 & 2020).
- POSITIVE AND NEGATIVE DESIGN PRESSURES CALCULATED FOR USE WITH THIS SYSTEM SHALL BE DETERMINED BY OTHERS ON A JOB-SPECIFIC BASIS IN ACCORDANCE WITH THE GOVERNING CODE.
- MAXIMUM DIMENSIONS AND WEIGHT OF GENERATORS UNIT SHALL CONFORM TO SPECIFICATIONS STATED HEREIN.
- THE AREA UNDER CONCRETE SLAB ON GROUND SHALL HAVE ALL VEGETATION, STUMPS, ROOTS, AND FOREIGN MATERIALS REMOVED PRIOR TO INSTALLATION ON COMPACTED SOIL AS VERIFIED BY OTHERS. THESE CONCRETE PADS HAVE BEEN DESIGNED FOR A MINIMUM BEARING CAPACITY OF 2,000 PSF AND MINIMUM SUBGRADE MODULUS = 100 PCI. SHOULD OTHER CONDITIONS OR MATERIALS BE ENCOUNTERED, THE ENGINEER OF RECORD SHALL BE NOTIFIED PRIOR TO PROCEEDING WITH THE WORK.
- SLIDING IS ASSUMED RESISTED BY 2" EMBEDMENT OF PAD IN GROUND ALONG WITH RESISTANCE FROM CONNECTED CABLEING. NOMIAL SLIDING IS NOT ASSUMED A FAILURE CASE IN THIS DESIGN

GENERAL NOTES

- ELECTRICAL GROUND, WHEN REQUIRED, TO BE DESIGNED & INSTALLED BY OTHERS. ALL MECHANICAL SPECIFICATIONS (CLEAR SPACE, TONNAGE, ETC.) SHALL BE AS PER MANUFACTURER RECOMMENDATIONS AND ARE THE EXPRESS RESPONSIBILITY OF THE CONTRACTOR.
- ENGINEER SEAL AFFIXED HERETO VALIDATES STRUCTURAL DESIGN AS SHOWN ONLY. USE OF THIS SPECIFICATION BY CONTRACTOR, et. al. INDEMNIFIES & SAVES HARMLESS THIS ENGINEER FOR ALL COST & DAMAGES INCLUDING LEGAL FEES & APPELLATE FEES RESULTING FROM MATERIAL FABRICATION, SYSTEM ERECTION, CONSTRUCTION PRACTICES BEYOND THAT WHICH IS CALLED FOR BY LOCAL, STATE, & FEDERAL CODES & FROM DEVIATIONS OF THIS PLAN.15.
- NO FLOOD OR WATERPROOFING RATINGS OR CERTIFICATIONS ARE INTENDED
- HOLLOW PADS FOR USE WHERE APPLICABLE BY CODE. USE OF PADS MAY BE SUBJECT TO BUILDING DEPT APPROVAL
- WATER-TIGHTNESS OF EXISTING FINISHES SHALL BE THE FULL RESPONSIBILITY OF THE INSTALLING CONTRACTOR. CONTRACTOR SHALL ENSURE THAT ANY REMOVED OR ALTERED WATERPROOFING MEMBRANE IS RESTORED AFTER FABRICATION AND INSTALLATION OF STRUCTURE PROPOSED HEREIN. THIS ENGINEER SHALL NOT BE RESPONSIBLE FOR ANY WATERPROOFING OR LEAKAGE ISSUES WHICH MAY OCCUR AS WATER-TIGHTNESS SHALL BE THE FULL RESPONSIBILITY OF THE INSTALLING CONTRACTOR.
- THE ROLE OF THIS ENGINEER FOR THIS PROJECT IS THAT OF SPECIALTY ENGINEER AND NOT THE ENGINEER OF RECORD. CONSEQUENTLY, THE ARCHITECT/ENGINEER OF RECORD SHALL BE RESPONSIBLE FOR THE INTEGRITY OF ALL SUPPORTING SURFACES TO THIS DESIGN WHICH SHALL BE COORDINATED BY THE PERMITTING CONTRACTOR.
- THIS DOCUMENT IS GENERIC AND DOES NOT PERTAIN TO ANY SPECIFIC PROJECT SITE. INFORMATION CONTAINED HEREIN IS BASED ON CONTRACTOR-SUPPLIED DATA AND MEASUREMENTS. ENGINEERING EXPRESS SHALL NOT BE HELD RESPONSIBLE OR LIABLE IN ANY WAY FOR ERRONEOUS OR INACCURATE DATA OR MEASUREMENTS. DIMENSIONS ARE SHOWN TO ILLUSTRATE DESIGN FORCES AND OTHER DESIGN CRITERIA. THEY MAY VARY SLIGHTLY, BUT MUST REMAIN WITHIN THE LIMITATIONS SPECIFIED HEREIN. WORK SHALL BE FIELD VERIFIED BY OTHERS PRIOR TO CONSTRUCTION. ENGINEERING EXPRESS SHALL BE NOTIFIED AND GIVEN AN OPPORTUNITY TO REEVALUATE OUR WORK UPON DISCOVERY OF ANY INACCURATE INFORMATION PRIOR TO MODIFICATION OF EXISTING FIELD CONDITIONS AND FABRICATION AND INSTALLATION OF MATERIALS. ALTERATIONS OR ADDITIONS TO THIS DOCUMENT ARE NOT PERMITTED AND INVALIDATE OUR CERTIFICATION.
- EXCEPT AS EXPRESSLY PROVIDED HEREIN, NO ADDITIONAL CERTIFICATIONS OR AFFIRMATIONS ARE INTENDED.

VISIT [ECALC.IO/39268](https://ecalcalc.io/39268)

FOR ENGINEER CERTIFIED ORIGINALS & MORE INFORMATION ABOUT THIS DOCUMENT OR SCAN THIS QR CODE
VISIT [ENGINEERINGEXPRESS.COM/AMERICAST](https://engineeringexpress.com/AMERICAST) FOR ADDITIONAL PLANS, REPORTS & RESOURCES



AMERICAST GENERATOR
FOAM CORE, 12" TO 48"
ELEVATED CONCRETE DOUBLE PAD
(ON-GRADE APPLICATIONS ONLY)



FRANK BENNARDO, P.E.
PE# 0046549 CA#9885

FL

04/09/2021

VALID FOR 1 PERMIT ONLY UNO

DIGITAL SEAL NOTICE:
IF THIS DOCUMENT IS DIGITALLY SIGNED, THIS SHEET IS PART OF A DIGITALLY SIGNED FILE. IT SHALL REMAIN IN DIGITAL FORMAT, SHALL BE VERIFIED BY ELECTRONIC MEANS, & PRINTED COPIES OF THIS DOCUMENT ARE NOT CONSIDERED SIGNED AND SEALED.
PRINTED DOCUMENT NOTICE:
IF THIS DOCUMENT IS PRINTED & DOES NOT CONTAIN AN ENGINEER'S ORIGINAL SIGNATURE & SEAL, THIS DOCUMENT IS VOID & NOT VALID FOR USE. PHOTOCOPIES ARE NOT PERMITTED FOR USE.

ENGINEERING EXPRESS®
CORPORATE OFFICE:
160 SW 12th AVE, SUITE 106
DEERFIELD BEACH, FL 33442
(954) 354-0660 | (866) 396-9999
TEAM@ENGINEERINGEXPRESS.COM
ENGINEERINGEXPRESS.COM

AMERICAST
(772) 971-1958
5303 PALMETTO AVE
FORT PIERCE, FL
MASTER PLAN SHEET
ELEVATED FOAM CORE CONCRETE PADS
FBC 6TH & 7TH EDITION (2017 & 2020)

REMARKS	DATE	DRWN	CHKD	FLB	COB
INIT ISSUE	4/09/21				

THIS DOCUMENT IS THE PROPERTY OF ENGINEERING EXPRESS, AND SHALL NOT BE REPRODUCED IN WHOLE OR PART WITHOUT WRITTEN CONSENT OF ENGINEERING EXPRESS. ALTERATIONS, ADDITIONS OR OTHER MARKINGS TO THIS DOCUMENT ARE NOT PERMITTED AND INVALIDATE OUR CERTIFICATION.

COPYRIGHT ENGINEERING EXPRESS®

21-39268
SCALE: NTS UNLESS NOTED

1 OF 2

AMERICAST GENERATOR
FOAM CORE, 12" TO 48"
ELEVATED CONCRETE DOUBLE PAD
(ON-GRADE APPLICATIONS ONLY)

COPIES NOT VALID FOR PERMIT
COPIES NOT VALID FOR PERMIT

FRANK BENNARDO, P.E.
PE# 0046549 CA#9885

FL
04/09/2021

VALID FOR 1 PERMIT ONLY UNO

DIGITAL SEAL NOTICE:
IF THIS DOCUMENT IS DIGITALLY SIGNED, THIS SHEET IS PART OF A DIGITALLY SIGNED FILE. IT SHALL REMAIN IN DIGITAL FORMAT, SHALL BE VERIFIED BY ELECTRONIC MEANS, & PRINTED COPIES OF THIS DOCUMENT ARE NOT CONSIDERED SIGNED AND SEALED.
PRINTED DOCUMENT NOTICE:
IF THIS DOCUMENT IS PRINTED & DOES NOT CONTAIN AN ENGINEER'S ORIGINAL SIGNATURE & SEAL, THIS DOCUMENT IS VOID & NOT VALID FOR USE. PHOTOCOPIES ARE NOT PERMITTED FOR USE.

ENGINEERING EXPRESS
CORPORATE OFFICE:
160 SW 12th AVE, SUITE 106
DEERFIELD BEACH, FL 33442
(954) 354-0660 | (866) 396-9999
TEAM@ENGINEERINGEXPRESS.COM
ENGINEERINGEXPRESS.COM

AMERICAST
(772) 971-1958
5303 PALMETTO AVE
FORT PIERCE, FL
MASTER PLAN SHEET
ELEVATED FOAM CORE CONCRETE PADS
FBC 6TH & 7TH EDITION (2017 & 2020)

REMARKS	DATE	DRWN	CHKD
INIT ISSUE	4/09/21	CCB	FLB

THIS DOCUMENT IS THE PROPERTY OF ENGINEERING EXPRESS, AND SHALL NOT BE REPRODUCED IN WHOLE OR PART WITHOUT WRITTEN CONSENT OF ENGINEERING EXPRESS. ALTERATIONS, ADDITIONS OR OTHER MARKINGS TO THIS DOCUMENT ARE NOT PERMITTED AND INVALIDATE OUR CERTIFICATION.

COPYRIGHT ENGINEERING EXPRESS®

21-39268
SCALE: NTS UNLESS NOTED
2

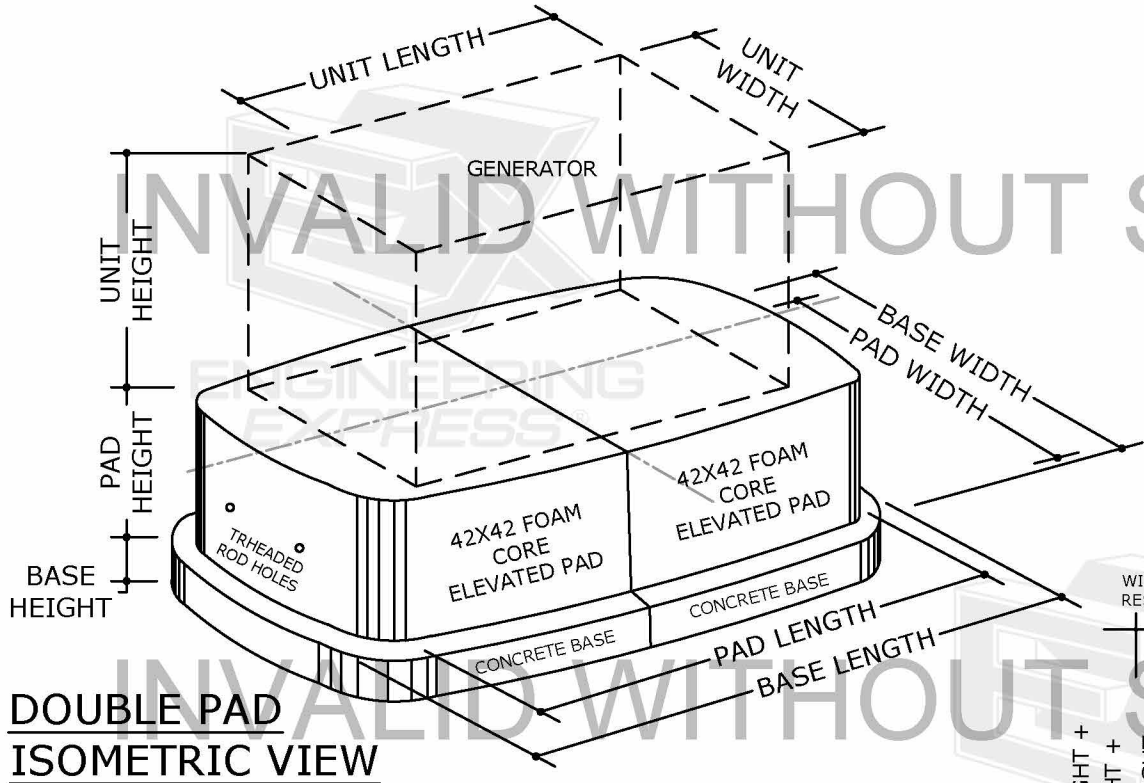

DOUBLE PAD
ISOMETRIC VIEW

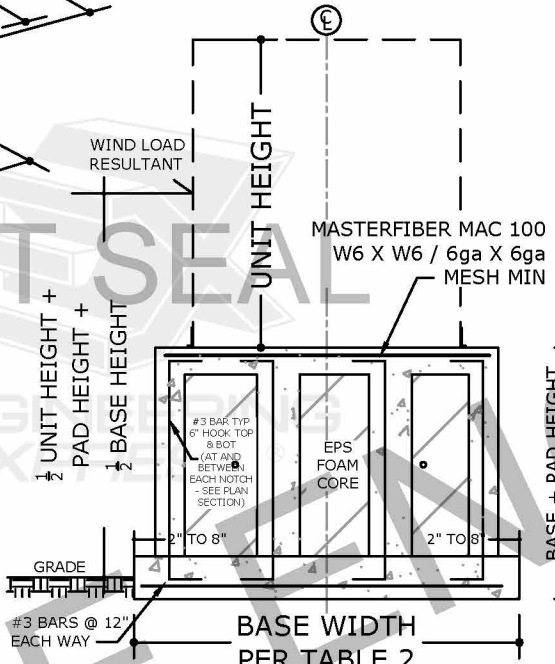

DOUBLE PAD FRONT VIEW

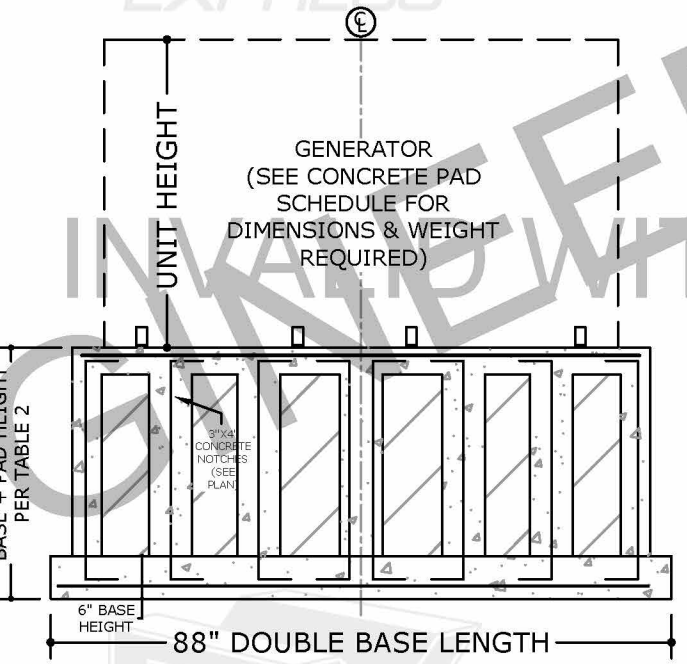

DOUBLE PAD SIDE VIEW

GENERATOR MOUNTING CONFIGURATION:

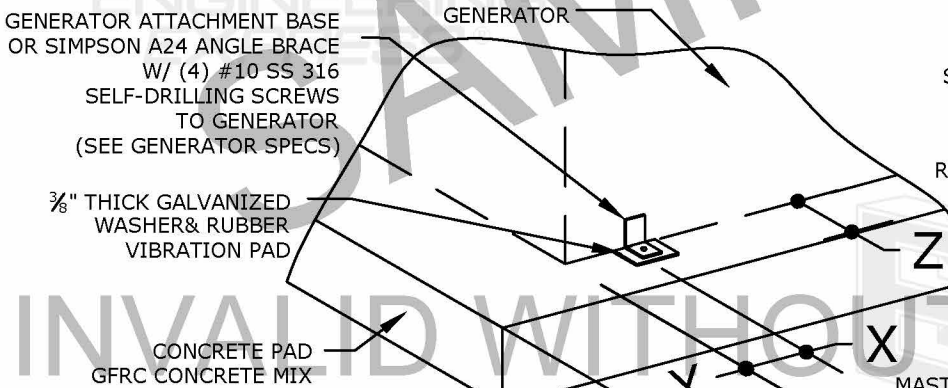

- NOTES:
1. Y DISTANCE DEPEND ON GENERATOR BASE LENGTH, NO LESS THAN 2".
 2. X DISTANCE 3" FROM UNIT EDGE TO CLIP.
 3. Z DISTANCE DEPEND ON GENERATOR BASE WIDTH, NO LESS THAN ANCHOR REQUIREMENTS

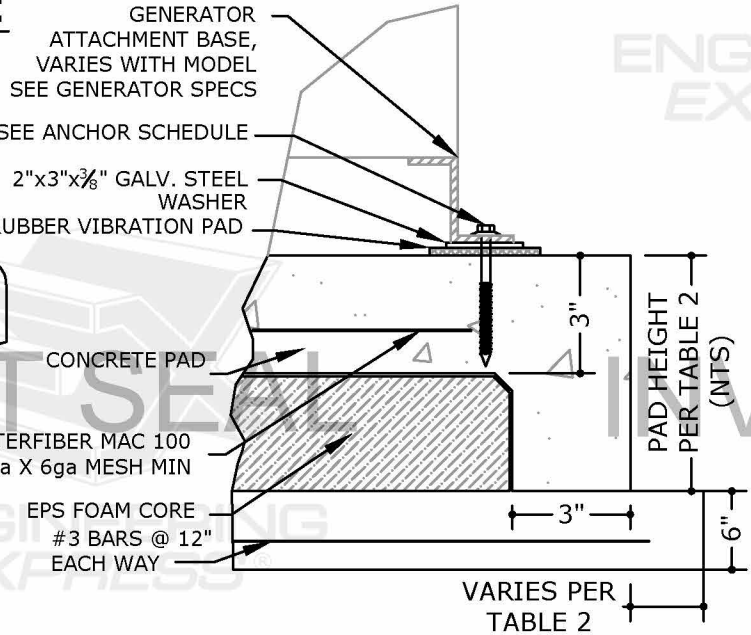

ANCHOR TO PAD SCHEDULE:

SUBSTRATE	DESCRIPTION
REINFORCED CONCRETE: (6000 PSI MIN.)	(4)-3/8"Ø TITEN HD OR EQUIVALENT, 2-3/4" FULL EMBED TO CONCRETE, 3" MIN. EDGE DISTANCE, 6" MIN. SPACING TO ANY ADJACENT ANCHOR. (2 ANCHORS PER SIDE PER PAD)

- NOTES:
1. ANCHOR QUANTITY PER LONG SIDE EMBEDMENT AND EDGE DISTANCE EXCLUDES FINISHES, IF APPLICABLE.
 2. ENSURE MINIMUM EDGE DISTANCE AS NOTED IN ANCHOR SCHEDULE.
 3. ENSURE MINIMUM SPACING TO ANY ADJACENT ANCHORS.
 4. FOLLOW MANUFACTURER'S INSTALLATION INSTRUCTIONS TO INSTALL ANCHORS.

DESIGN NOTES

1. THIS SYSTEM HAS BEEN DESIGNED AND SHALL BE FABRICATED IN ACCORDANCE WITH THE REQUIREMENTS OF THE FLORIDA BUILDING CODE SIXTH & SEVENTH EDITION (2017 & 2020).
2. POSITIVE AND NEGATIVE DESIGN PRESSURES CALCULATED FOR USE WITH THIS SYSTEM SHALL BE DETERMINED BY OTHERS ON A JOB-SPECIFIC BASIS IN ACCORDANCE WITH THE GOVERNING CODE.
3. MAXIMUM DIMENSIONS AND WEIGHT OF GENERATORS UNIT SHALL CONFORM TO SPECIFICATIONS STATED HEREIN.
4. THE AREA UNDER CONCRETE SLAB ON GROUND SHALL HAVE ALL VEGETATION, STUMPS, ROOTS, AND FOREIGN MATERIALS REMOVED PRIOR TO INSTALLATION ON COMPACTED SOIL AS VERIFIED BY OTHERS. THESE CONCRETE PADS HAVE BEEN DESIGNED FOR A MINIMUM BEARING CAPACITY OF 2,000 PSF AND MINIMUM SUBGRADE MODULUS = 100 PCI. SHOULD OTHER CONDITIONS OR MATERIALS BE ENCOUNTERED, THE ENGINEER OF RECORD SHALL BE NOTIFIED PRIOR TO PROCEEDING WITH THE WORK.
5. SLIDING IS ASSUMED RESISTED BY 2" EMBEDMENT OF PAD IN GROUND ALONG WITH RESISTANCE FROM CONNECTED CABLING. NOMIAL SLIDING IS NOT ASSUMED A FAILURE CASE IN THIS DESIGN

GENERAL NOTES

6. ELECTRICAL GROUND, WHEN REQUIRED, TO BE DESIGNED & INSTALLED BY OTHERS. ALL MECHANICAL SPECIFICATIONS (CLEAR SPACE, TONNAGE, ETC.) SHALL BE AS PER MANUFACTURER RECOMMENDATIONS AND ARE THE EXPRESS RESPONSIBILITY OF THE CONTRACTOR.
7. ENGINEER SEAL AFFIXED HERETO VALIDATES STRUCTURAL DESIGN AS SHOWN ONLY. USE OF THIS SPECIFICATION BY CONTRACTOR, et. al. INDEMNIFIES & SAVES HARMLESS THIS ENGINEER FOR ALL COST & DAMAGES INCLUDING LEGAL FEES & APPELLATE FEES RESULTING FROM MATERIAL FABRICATION, SYSTEM ERECTION, CONSTRUCTION PRACTICES BEYOND THAT WHICH IS CALLED FOR BY LOCAL, STATE, & FEDERAL CODES & FROM DEVIATIONS OF THIS PLAN.15.
8. NO FLOOD OR WATERPROOFING RATINGS OR CERTIFICATIONS ARE INTENDED
9. HOLLOW PADS FOR USE WHERE APPLICABLE BY CODE. USE OF PADS MAY BE SUBJECT TO BUILDING DEPT APPROVAL
10. WATER-TIGHTNESS OF EXISTING FINISHES SHALL BE THE FULL RESPONSIBILITY OF THE INSTALLING CONTRACTOR. CONTRACTOR SHALL ENSURE THAT ANY REMOVED OR ALTERED WATERPROOFING MEMBRANE IS RESTORED AFTER FABRICATION AND INSTALLATION OF STRUCTURE PROPOSED HEREIN. THIS ENGINEER SHALL NOT BE RESPONSIBLE FOR ANY WATERPROOFING OR LEAKAGE ISSUES WHICH MAY OCCUR AS WATER-TIGHTNESS SHALL BE THE FULL RESPONSIBILITY OF THE INSTALLING CONTRACTOR.
11. THE ROLE OF THIS ENGINEER FOR THIS PROJECT IS THAT OF SPECIALTY ENGINEER AND NOT THE ENGINEER OF RECORD. CONSEQUENTLY, THE ARCHITECT/ENGINEER OF RECORD SHALL BE RESPONSIBLE FOR THE INTEGRITY OF ALL SUPPORTING SURFACES TO THIS DESIGN WHICH SHALL BE COORDINATED BY THE PERMITTING CONTRACTOR.
12. THIS DOCUMENT IS GENERIC AND DOES NOT PERTAIN TO ANY SPECIFIC PROJECT SITE. INFORMATION CONTAINED HEREIN IS BASED ON CONTRACTOR-SUPPLIED DATA AND MEASUREMENTS. ENGINEERING EXPRESS SHALL NOT BE HELD RESPONSIBLE OR LIABLE IN ANY WAY FOR ERRONEOUS OR INACCURATE DATA OR MEASUREMENTS. DIMENSIONS ARE SHOWN TO ILLUSTRATE DESIGN FORCES AND OTHER DESIGN CRITERIA. THEY MAY VARY SLIGHTLY, BUT MUST REMAIN WITHIN THE LIMITATIONS SPECIFIED HEREIN. WORK SHALL BE FIELD VERIFIED BY OTHERS PRIOR TO CONSTRUCTION. ENGINEERING EXPRESS SHALL BE NOTIFIED AND GIVEN AN OPPORTUNITY TO REEVALUATE OUR WORK UPON DISCOVERY OF ANY INACCURATE INFORMATION PRIOR TO MODIFICATION OF EXISTING FIELD CONDITIONS AND FABRICATION AND INSTALLATION OF MATERIALS. ALTERATIONS OR ADDITIONS TO THIS DOCUMENT ARE NOT PERMITTED AND INVALIDATE OUR CERTIFICATION.
13. EXCEPT AS EXPRESSLY PROVIDED HEREIN, NO ADDITIONAL CERTIFICATIONS OR AFFIRMATIONS ARE INTENDED.

VISIT [ECALC.IO/39268](https://ecalcalc.io/39268)

FOR ENGINEER CERTIFIED ORIGINALS
& MORE INFORMATION ABOUT THIS DOCUMENT
OR SCAN THIS QR CODE
VISIT [ENGINEERINGEXPRESS.COM/AMERICAST](https://engineeringexpress.com/americast)
FOR ADDITIONAL PLANS, REPORTS & RESOURCES

