

SCREEN WALL INFILL MASTER PLAN

NON-LOAD BEARING - GROUND FLOOR USE ONLY

ISOMETRIC VIEW

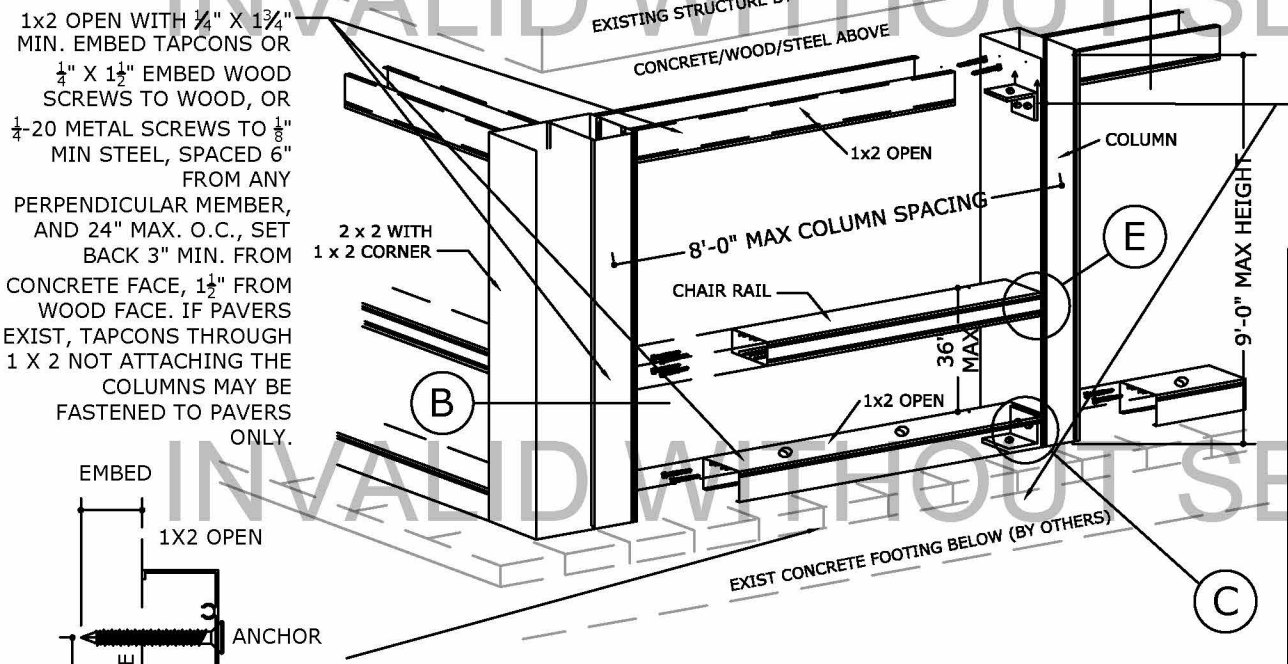

ANGLE: 2x2x2x1/8" MIN. EACH SIDE EACH COLUMN, TOP & BOTTOM

TO COLUMN: (3) #14 SMS, (3) 1/4" POP RIVETS, OR (2) 1/4" THRU BOLTS

TO CONCRETE FOOTING: 9'-0" MAX COLUMN HEIGHT: (1) 1/4" x 1 3/4" MIN. EMBED TAPCON EA ANGLE LEG WN USING SAME ANCHORAGE

> ENSURE ANCHOR PASSES THROUGH PAVERS AND MAINTAINS ALL MINIMUM FOOTER EMBEDMENTS.

> ANCHOR TO BE INSTALLED FLUSH TO HEAD/SILL

EXTRUSIONS:

VERIFY FIELD EXTRUSION DIMENSIONS WITH DESIGN DIMENSIONS PRIOR TO USE. ALTERNATE ENGINEERING WILL BE REQUIRED FOR DIMENSIONS LESS THAN THOSE AS SPECIFIED HEREIN. ALL EXTRUSIONS TO BE 6063-T6 ALUMINUM OR BETTER.

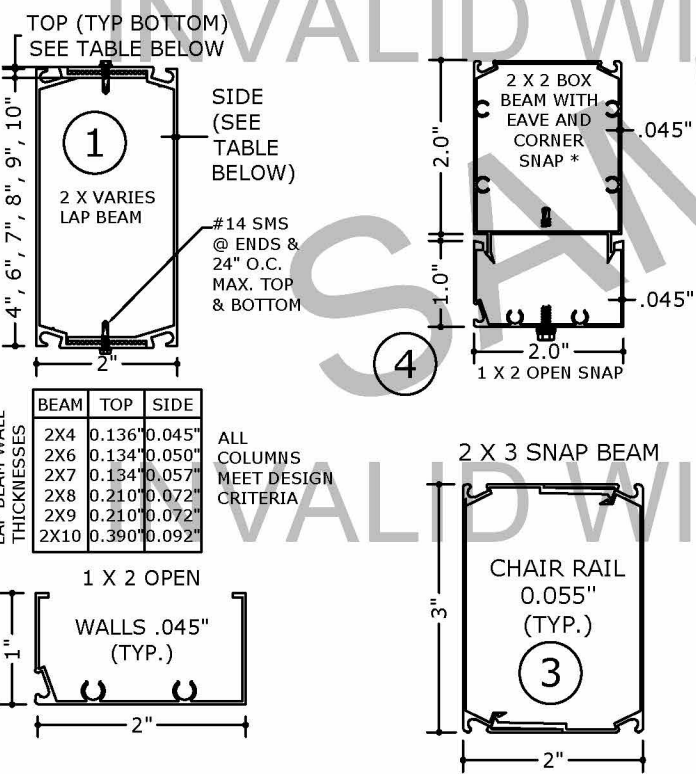

B CORNER HOST ATTACHMENT

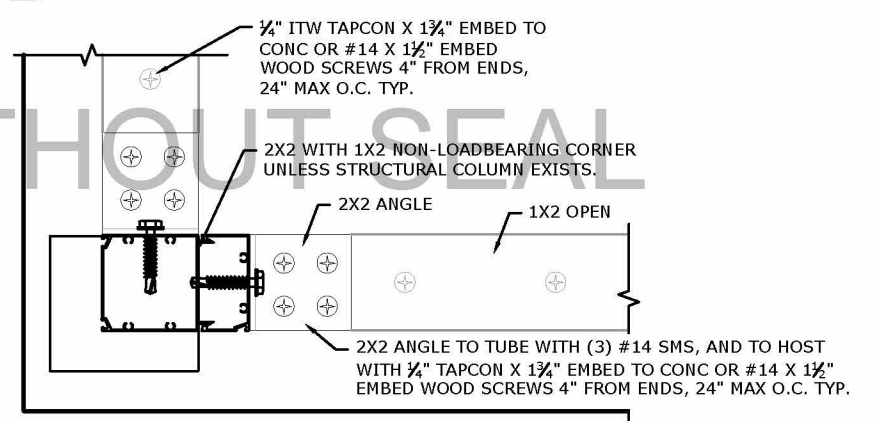

VALID AS A GENERIC SEALED MASTER PLAN FOR SCREEN WALL INFILL INSTALLATION AT (1) LOCATION. SITE SPECIFIC/ADDITIONAL ENGINEERING REQUIRED THEREAFTER.

A ROOF/SCREEN LAYOUT

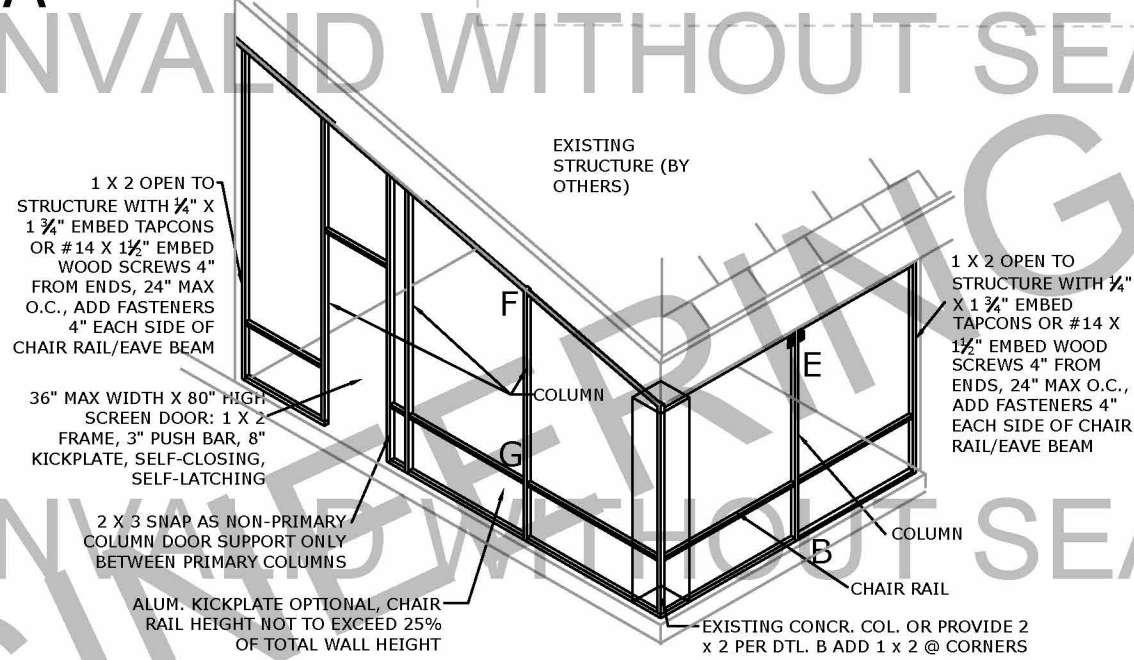

DESIGN NOTES:

MAXIMUM DESIGN PRESSURE (GROUND SURFACE ONLY): **±29 PSF ASD LATERAL LOAD COMBINATION**

*LATERAL LOAD COMBINATION TO CONSIDER ALL CODE-REQUIRED LOADING CONDITIONS INCLUDING BUT NOT LIMITED TO WIND & SEISMIC LOADS

- DESIGN CONDITIONS ARE NOT TO EXCEED THE FOLLOWING DESIGN CRITERIA: MAX WIND SPEED V_{ULT}: 170 MPH (V_{ASD} = 132 MPH); EXTREME EXPOSURE CATEGORY: EXP C; DEFLECTION LIMIT: L/60. VALUE OBTAINED BY 0.6* ULTIMATE PRESSURE * 0.86 GROUND HEIGHT ADJUSTMENT FACTORS BASED ON FBC 7TH ED (2020) TABLE 2002.4 FOR MESH SCREENS NO MORE DENSE THAN 20 X 20 X 0.13". FOR THE CONDITIONS NOTED ABOVE. FOR SCREENS WHICH VARY IN POROSITY, CONSULT AN ENGINEER FOR SITE SPECIFIC VALUES.
- THIS MASTER PLAN IS VALID FOR SITE CONDITIONS WITHIN THE ABOVE LIMITATIONS (DESIGN ASSUMPTIONS INCLUDE LOADING CONDITIONS AS LISTED, BUT ENGINEERING REMAINS VALID FOR ALTERNATE LOAD COMBINATIONS THAT REMAIN WITHIN NOTED LIMITS)
- SITE SPECIFIC PRESSURES MAY CONSIDER THOSE INCLUDED IN WIND SPEED TO PRESSURE CONVERSION TABLES, OR CALCULATED SEPARATELY PER CODES AND STANDARDS STATED HEREIN. DESIGN CRITERIA OR SPANS BEYOND WHAT IS STATED HEREIN MAY REQUIRE ADDITIONAL SITE SPECIFIC SEALED ENGINEERING

GENERAL NOTES:

- THIS SYSTEM HAS BEEN DESIGNED AND SHALL BE FABRICATED IN ACCORDANCE WITH THE REQUIREMENTS OF THE FLORIDA BUILDING CODE 7TH EDITION (2020). ALSO APPLICABLE FOR THE FBC 6TH EDITION (2017), IBC/IRC (2015 & 2018), AS WELL AS CURRENT VERSIONS OF THE MN, NC, NJ, NY, OH, SC, & VA BUILDING CODES AS APPLICABLE. CODE ENFORCED COMPLIES WITH STATE OF SEAL AND IF MULTIPLE VERSIONS ARE LISTED THEN MOST STRINGENT APPLIES. DESIGN SHALL UTILIZE ASD DESIGN METHOD USING ASCE 7-16 OR ASCE 7-10 CODES FOR SITE SPECIFIC APPLICATIONS AS APPLICABLE.
- ANY EXISTING STRUCTURE MUST BE CAPABLE OF SUPPORTING THE LOADED COMPOSITE ROOF-SCREEN WALL STRUCTURE AS DETERMINED BY OTHERS OR BY SPECIAL ENGINEERING BY UNDERSIGNED ENGINEER ATTACHED HERETO. NO WARRANTY IS CONTAINED HEREIN.
- MATERIALS:**
 - ALL EXTRUSIONS SHALL BE ALUMINUM ALLOY TYPE 6063-T6 U.N.O.
 - ALL FASTENERS TO BE 2024-T4 OR 7075-T73 ALLOY, NON-MAGNETIC STAINLESS STEEL, SAE GRADE 5 STEEL MIN, OR CADMIUM PLATED OR OTHER CORROSION RESISTANT MATERIAL AND SHALL COMPLY WITH THE 2015 ALUMINUM DESIGN MANUAL, THE ALUMINUM ASSOCIATION, INC., & APPLICABLE FEDERAL, STATE, AND LOCAL CODES.
 - FASTENERS SHALL HAVE A HEAD AND/OR BE PROVIDED WITH 1/2" DIAMETER WASHER MINIMUM UNLESS NOTED OTHERWISE.
 - ALL CONNECTIONS SHALL BE BOLTED OR FASTENED WITH SHEET METAL SCREWS AS SHOWN AND IN ACCORDANCE WITH PROPER FASTENING METHODS AND CODES. ANY FASTENER STRIPPED OR NOT ADEQUATELY HOLDING SHALL BE REPLACED.
 - THE CONTRACTOR IS RESPONSIBLE TO INSULATE ALUMINUM MEMBERS FROM DISSIMILAR METALS TO PREVENT ELECTROLYSIS.
 - ALL TAPCONS MUST BE ITW CARBON STEEL TAPCONS OR EQUIVALENT W/ 1 1/4" EMBED, 3" MIN. EDGE DISTANCE, FASTENED TO MINIMUM 3192PSI CONCRETE, U.N.O.
- OTHER NOTES:**
 - SITE SPECIFIC ENGINEERING REQUIRED FOR ANY DETAIL WHICH DEVIATES FROM THIS PLAN OR BEYOND THESE LIMITATIONS.
 - ENGINEER SEAL AFFIXED HERETO VALIDATES STRUCTURAL DESIGN AS SHOWN ONLY. USE OF THIS SPECIFICATION BY CONTRACTOR, et al, INDEMNIFIES AND SAVES HARMLESS THIS ENGINEER FOR ALL COSTS AND DAMAGES INCLUDING LEGAL FEES AND APPELLATE FEES RESULTING FROM MATERIAL FABRICATION, SYSTEM ERECTION, AND CONSTRUCTION PRACTICES BEYOND THAT WHICH IS CALLED FOR BY LOCAL, STATE, AND FEDERAL CODES AND FROM DEVIATIONS OF THIS PLAN.
 - THIS DOCUMENT SHALL NOT BE USED OR REPRODUCED WITHOUT THE ORIGINAL SIGNATURE & RAISED SEAL OF A CERTIFIED ENGINEER FROM ENGINEERING EXPRESS. ALTERATIONS, ADDITIONS, OR OTHER MARKINGS TO THIS DOCUMENT ARE NOT PERMITTED AND INVALIDATE OUR CERTIFICATION.
 - EXCEPT AS EXPRESSLY PROVIDED IN THIS SPECIFICATION, NO ADDITIONAL CERTIFICATIONS OR AFFIRMATIONS ARE INTENDED.

VISIT [ECALC.IO/35472](https://ecalc.io/35472)

FOR ENGINEER CERTIFIED ORIGINALS & MORE INFORMATION ABOUT THIS DOCUMENT OR SCAN THIS QR CODE

VISIT [ENGINEERINGEXPRESS.COM/STORE](https://engineeringexpress.com/store) FOR ADDITIONAL PLANS, REPORTS & RESOURCES



COPIES NOT VALID FOR PERMIT

COPIES NOT VALID FOR PERMIT

DIGITAL SEAL NOTICE: IF THIS DOCUMENT IS DIGITALLY SIGNED, THIS SHEET IS PART OF A DIGITALLY SIGNED FILE. IT SHALL REMAIN IN DIGITAL FORMAT, SHALL BE VERIFIED BY ELECTRONIC MEANS, & PRINTED COPIES OF THIS DOCUMENT ARE NOT CONSIDERED SIGNED AND SEALED.

PRINTED DOCUMENT NOTICE: IF THIS DOCUMENT IS PRINTED & DOES NOT CONTAIN AN ENGINEER'S ORIGINAL SIGNATURE & SEAL, THIS DOCUMENT IS VOID & NOT VALID FOR USE. PHOTOCOPIES ARE NOT PERMITTED FOR USE.

ENGINEERING EXPRESS

CORPORATE OFFICE:
160 SW 12th AVE, SUITE 106
DEERFIELD BEACH, FL 33442
(954) 354-0660 | (866) 396-9999
TEAM@ENGINEERINGEXPRESS.COM
ENGINEERINGEXPRESS.COM

SCREEN WALL INFILL
PARTS, SPANS, & STRUCTURAL DETAILS

MASTER PLAN

FLORIDA BUILDING CODE 7TH ED (2020)
INTERNATIONAL BUILDING CODE (2018)
WIND LOADING PER ASCE 7-16

REMARKS	DATE	DRWN	CHKD
INIT ISSUE	7/17/18	JAC	TSB
2020 FBC	6/01/21	OCB	FLB

THIS DOCUMENT IS THE PROPERTY OF ENGINEERING EXPRESS, AND SHALL NOT BE REPRODUCED IN WHOLE OR PART WITHOUT WRITTEN CONSENT OF ENGINEERING EXPRESS. ALTERATIONS, ADDITIONS, OR OTHER MARKINGS TO THIS DOCUMENT ARE NOT PERMITTED AND INVALIDATE OUR CERTIFICATION.

COPYRIGHT ENGINEERING EXPRESS®

20-35472

SCALE: NTS UNLESS NOTED

1

C:\Users\frankb\Engineering\Express\Production - Documents\Projects\20-35472 Screen Wall Infill\WorkDrawings & CAD\20-35472c - Screen Wall Infill MPS.dwg
frankb
07/06/2021 - 5:13pm

C ENCLOSURE TO HOST ANCHORING DETAIL

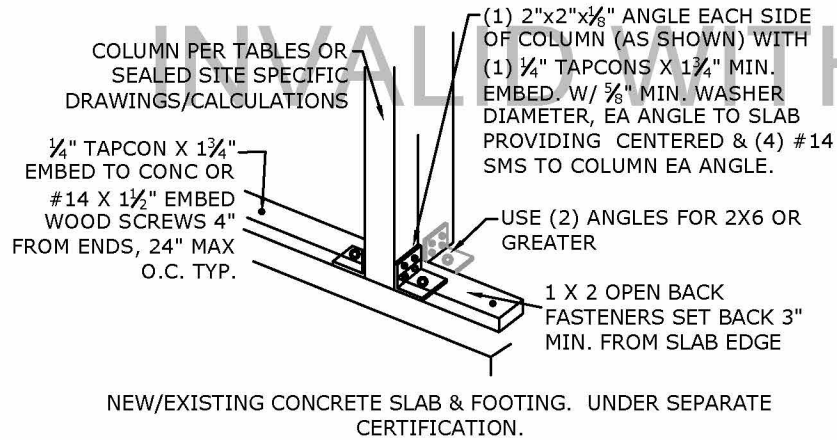

D 1x2 TO HOST STRUCTURE

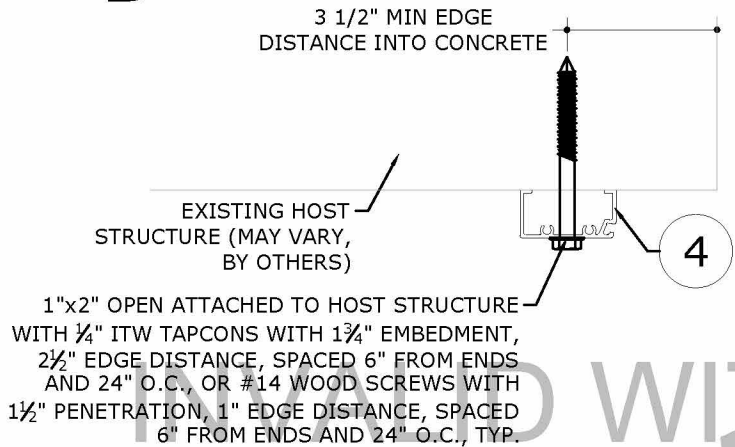

E TYP. BEAM TO CHAIR RAIL

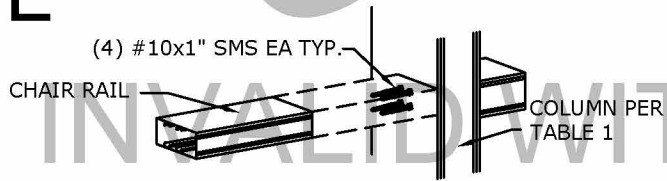

TABLE 1: 29 PSF SCREEN WALL LOAD (OR LESS)
SCREEN WALL COLUMN HEIGHT TABLE

COLUMN	AVG COLUMN SPACING						
	5'-0"	5'-6"	6'-0"	6'-6"	7'-0"	7'-6"	8'-0"
2"x4" LAP COLUMN	7'-2"	6'-10"	6'-6"	6'-4"	6'-4"	6'-4"	6'-4"
2"x5" LAP COLUMN	8'-6"	8'-1"	7'-9"	7'-5"	7'-2"	7'-1"	7'-1"
2"x6" LAP COLUMN	10'-0"	9'-5"	9'-1"	8'-8"	8'-4"	8'-1"	7'-10"
2"x7" LAP COLUMN	10'-0"	9'-10"	9'-5"	9'-1"	8'-9"	8'-5"	8'-2"
2"x8" LAP COLUMN	10'-0"	10'-0"	10'-0"	10'-0"	10'-0"	10'-0"	10'-0"
2"x9" LAP COLUMN	10'-0"	10'-0"	10'-0"	10'-0"	10'-0"	10'-0"	10'-0"
2"x10" LAP COLUMN	10'-0"	10'-0"	10'-0"	10'-0"	10'-0"	10'-0"	10'-0"

- 1) ALLOWABLE STRESS DESIGN USED IN ALL TABLES.
- 2) DEFLECTION LIMIT = L/60.
- 3) 29 PSF SCREEN WALL LOAD MAX PER REFERENCED CODES HEREIN.
- 4) COLUMN SPACING IS HALF THE DISTANCE TO THE LEFT ADDED TO HALF THE DISTANCE TO THE RIGHT OF THE BEAM.
- 5) COLUMNS TO BE Laterally SUPPORTED EVERY 8' MAX.

TABLE 2:
CHAIRRAIL SPAN TABLE:

CHAIRRAIL MEMBER	2' BELOW 6' ABOVE	2' BELOW 8' ABOVE	3' BELOW 5' ABOVE	3' BELOW 7' ABOVE
2 X 2 X .055"	6'-9"	6'-7"	6'-5"	6'-4"
2 X 3 X .055"	8'-0"	8'-0"	8'-0"	7'-8"

- 1) TABLE 2 SOLVES FOR THE MAX SPAN OF THE CHAIRRAIL ACCORDING TO THE MAX SPACING ABOVE AND BELOW THE CHAIRRAIL.
- 2) COLUMNS TO BE Laterally SUPPORTED EVERY 8' MAX.

F DOOR & JAMB DETAIL

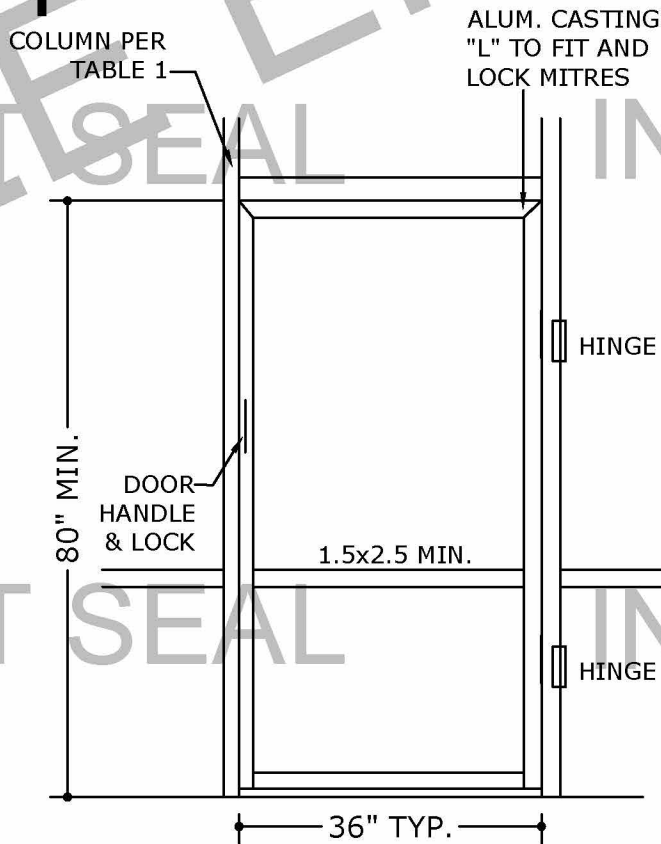

DOOR DETAIL

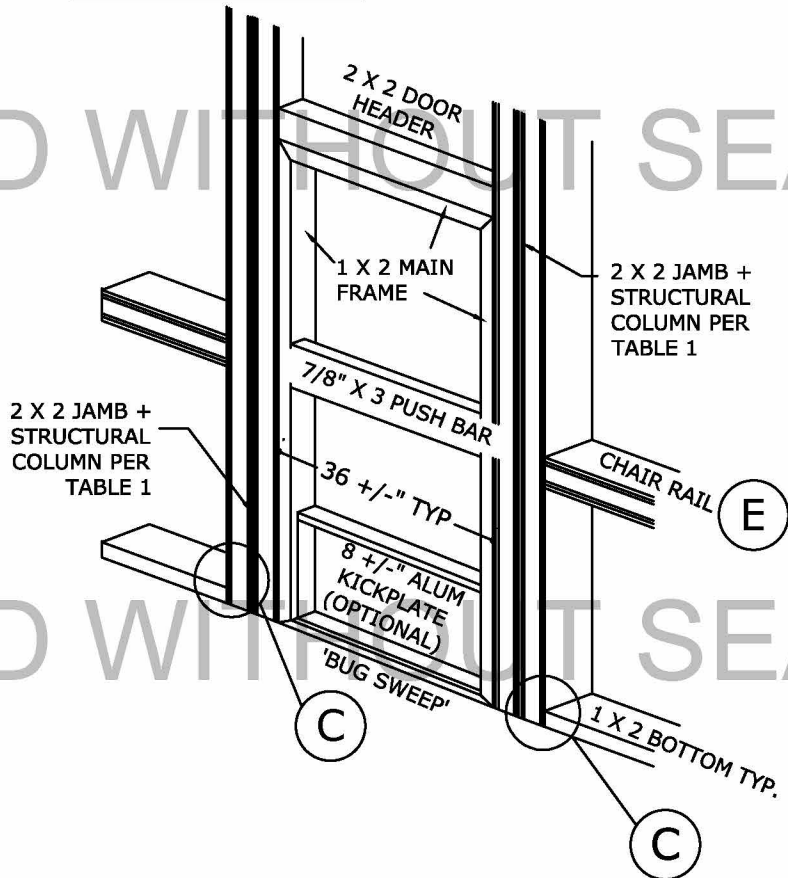

COPIES NOT VALID FOR PERMIT

COPIES NOT VALID FOR PERMIT

PE SEAL
REQUIRED
07/06/2021
CERTIFYING ENGINEER AND CERT
OF AUTH AS LISTED ON STAMP

DIGITAL SEAL NOTICE:
IF THIS DOCUMENT IS DIGITALLY
SIGNED, THIS SHEET IS PART OF A
DIGITALLY SIGNED FILE. IT SHALL
REMAIN IN DIGITAL FORMAT, SHALL
BE VERIFIED BY ELECTRONIC MEANS,
& PRINTED COPIES OF THIS
DOCUMENT ARE NOT CONSIDERED
SIGNED AND SEALED.
PRINTED DOCUMENT NOTICE:
IF THIS DOCUMENT IS PRINTED &
DOES NOT CONTAIN AN ENGINEER'S
ORIGINAL SIGNATURE & SEAL, THIS
DOCUMENT IS VOID & NOT VALID FOR
USE. PHOTOCOPIES ARE NOT
PERMITTED FOR USE.

**ENGINEERING
EXPRESS®**
CORPORATE OFFICE:
160 SW 12th AVE, SUITE 106
DEERFIELD BEACH, FL 33442
(954) 354-0660 | (866) 396-9999
TEAM@ENGINEERINGEXPRESS.COM
ENGINEERINGEXPRESS.COM

SCREEN WALL INFILL
PARTS, SPANS, & STRUCTURAL DETAILS
MASTER PLAN
FLORIDA BUILDING CODE 7TH ED (2020)
INTERNATIONAL BUILDING CODE (2018)
WIND LOADING PER ASCE 7-16

REMARKS
DATE
7/7/18
7/7/18
6/01/21
JAC TSB
CCB FLB
2020 FBC
THIS DOCUMENT IS THE PROPERTY OF ENGINEERING EXPRESS
AND SHALL NOT BE REPRODUCED IN WHOLE OR PART WITHOUT
WRITTEN CONSENT OF ENGINEERING EXPRESS. ALTERATIONS,
ADDITIONS OR OTHER MARKINGS TO THIS DOCUMENT ARE NOT
PERMITTED AND INVALIDATE OUR CERTIFICATION.

COPYRIGHT ENGINEERING EXPRESS®
20-35472
SCALE: NTS UNLESS NOTED

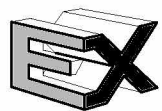

ENGINEERING
EXPRESS®

WIND SPEED TO PRESSURE LOADING COMBINATION

CONVERSION TABLES FOR SCREENED SUNROOMS & CANOPIES

ASD DESIGN LOAD COMBINATION PRESSURES CONSIDER $D_L = 2$ PSF, $L_R = 20$ PSF, $S = 20$ PSF, AND WIND LOAD, W AS CALCULATED FOR THE SELECTED STRUCTURE USING ASCE 7-16 VULT WIND SPEED & ASD PRESSURE METHOD & CALCULATED AT MEAN SEA LEVEL.

TABLE 4-WALL PRESSURES:

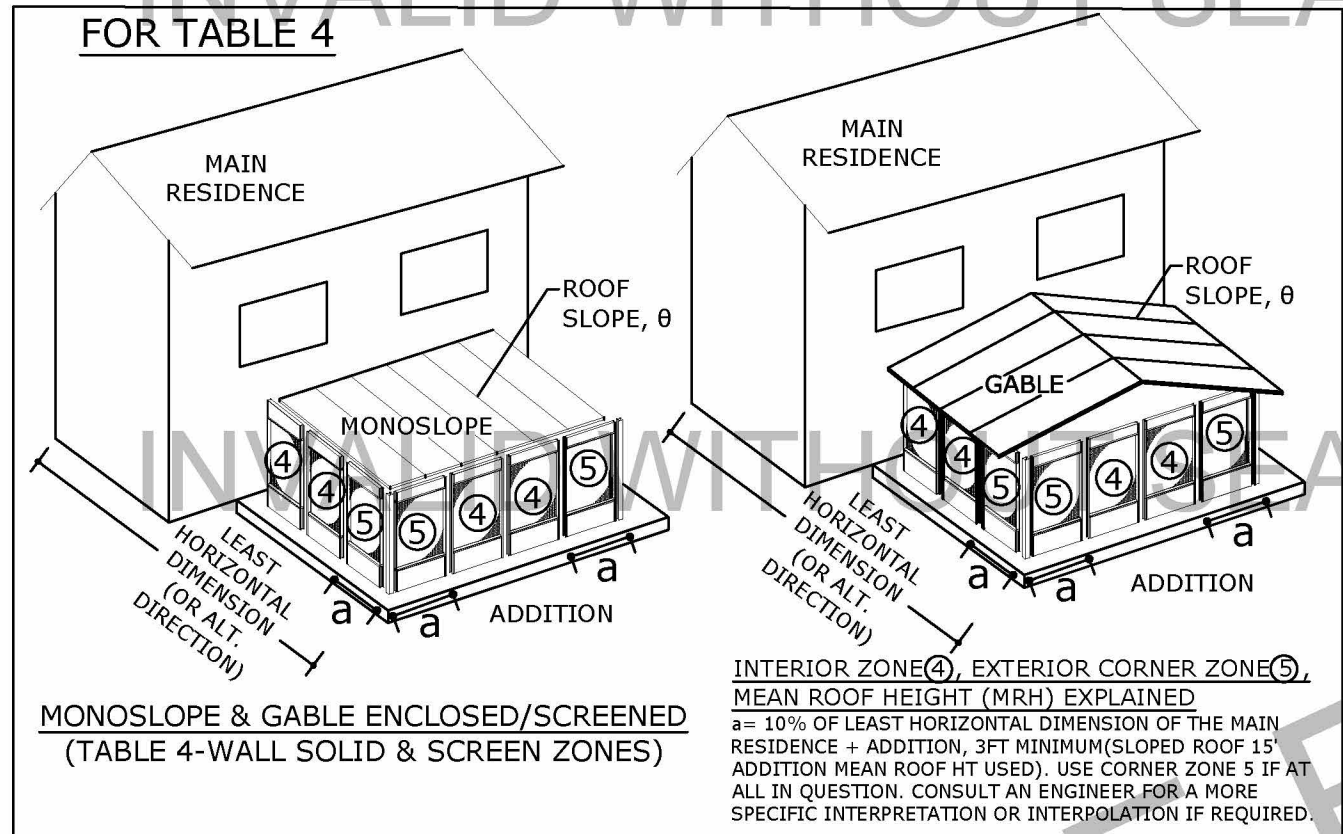

DESIGN LOAD COMBINATION CONDITIONS

PRESSURES PROVIDED IN THE TABLES HEREIN ARE ALLOWABLE STRESS DESIGN FACTORED LOAD COMBINATIONS PER ASCE 7-16 CHAPTER 2.4 & CORRESPONDING WIND PRESSURE DESIGN CHAPTERS. THE WIND PRESSURES UTILIZED IN THESE CALCULATIONS ASSUME A CANOPY OF HEIGHT = 12FT AND A ROOF AREA OF 100 SQFT. WALL PRESSURES ARE VALID FOR BOTH COMPONENTS AND WALL PANELS OF AREA 20 SQFT & LARGER. FOR SMALLER OPENINGS OR BETTER ANSWERS, SEE THE COMPONENTS & CLADDING CALCULATOR AT THE QR PROVIDED.

ASD LOAD COMBINATIONS HEREIN ASSUME A CONSTANT DEAD LOAD OF 2 PSF, ROOF LIVE LOAD, $L_R = 20$ PSF, SNOW LOAD, $S = 20$ PSF, AND WIND LOAD, W AS CALCULATED FOR THE SELECTED STRUCTURE & SITE SPECIFIC CONDITONS. PRESSURES LISTED ARE VALID FOR CONDITIONS EQUAL TO OR LESS THAN THE LOAD COMBINATION CONSIDERED.

FOR LOADING CONDITIONS EXCEEDING THE CONSTANTS STATED ABOVE (SUCH AS A ROOF OR SNOW LOADING EXCEEDING 20 PSF, OR THE CONSIDERATION OF SEISMIC LOADING), USE THE ONLINE LOAD COMBINATION TOOLS FOUND AT THE QR CODE PROVIDED.

INSTRUCTIONS FOR TABLE USE:

1. IDENTIFY THE LOCAL VULT WIND VELOCITY BASED ON 3 SECOND GUST FACTOR FROM BUILDING DEPT OR PUBLISHED DATA.
2. CONFIRM THAT THE SITE-SPECIFIC & LOCAL MUNICIPALITY DESIGN CONDITIONS ARE WITHIN THE LIMITATIONS OF THIS MASTER PLAN AS STATED ABOVE. CONFIRM THAT THESE CONDITIONS ALSO COMPLY WITH LOCAL CODE REQUIREMENTS
3. IDENTIFY THE TYPE OF SCREENED STRUCTURE TO BE USED SUCH AS MONOSLOPE OR GABLED
4. FOR SOLID/ENCLOSED, IDENTIFY THE ZONE OF THE WALLS AS INTERIOR (ZONE 4) OR EXTERIOR (BUILDING CORNER, ZONE 5) PER TABLE 4. ANY QUESTIONABLE AREA IS TO BE CONSIDERED THE MORE CRITICAL (CORNER) ZONE 5.
5. READ OFF POSITIVE (DOWNWARD) AND NEGATIVE (UPLIFT) PRESSURES AS ASD DESIGN PRESSURES FOR DIRECT USE WITH APPLICABLE PRESSURE-DESIGNED SYSTEMS

▨ : DESIGN CONDITION EXCEEDS CONSIDERATIONS OF THIS MASTER PLAN.

SOLID/SCREEN WALL LATERAL DESIGN PRESSURES					
ULT WIND SPEED (MPH)	ASCE EXPOSURE CATEGORY	ZONE 4, (PSF) SOLID/SCREEN		ZONE 5, (PSF) SOLID/SCREEN	
		(+)	(-)	(+)	(-)
120 MPH	B	13/ 6	-14/ -6	13/ 6	-17/ -8
	C	18/ 9	-20/ -9	18/ 9	-24/ -11
130 MPH	B	15/ 7	-16/ -8	15/ 7	-20/ -9
	C	22/ 10	-24/ -11	22/ 10	-29/ -13
140 MPH	B	17/ 8	-19/ -9	17/ 8	-23/ -11
	C	25/ 12	-27/ -12	25/ 12	-33/ -15
150 MPH	B	20/ 9	-21/ -10	20/ 9	-26/ -12
	C	29/ 14	-31/ -14	29/ 14	-38/ -17
160 MPH	B	23/ 11	-24/ -11	23/ 11	-29/ -14
	C	33/ 15	-36/ -17	33/ 15	-42/ -20
170 MPH	B	25/ 12	-27/ -12	25/ 12	-33/ -15
	C	37/ 17	-40/ -18	37/ 17	-48/ -22

NOTE: LATERAL PRESSURES PROVIDED ABOVE ARE CONSERVATIVE AND ARE APPLICABLE FOR WORST-CASE CONDITIONS. THESE VALUES ASSUME SCREENS WITH DENSITIES GREATER THAN $20 \times 20 \times 0.013$, UP TO SOLID WALLS. FOR REDUCED PRESSURES (WHICH CONSIDER POROUS SCREENS), REFER FBC 7TH ED (2020) TABLE 2002.4 - DESIGN PRESURES FOR SCREENED ENCLOSURES - AND MULTIPLY GIVEN LRFD PRESSURES BY 0.6 TO FIND APPLICABLE DESIGN PRESSURES. IN ALL CASES, DESIGN PRESSURES ARE TO BE DETERMINED ON A SITE-SPECIFIC BASIS FOR USE WITH THIS MASTER PLAN.

ABBREVIATIONS:

θ = SLOPE, DEGREES
(+) = POSITIVE (DOWNW-IN) PRESSURE
(-) = NEGATIVE (UP-OUT) PRESSURE
 H_c = CANOPY HEIGHT
 H_e = EAVE HEIGHT
PSF = POUNDS PER SQUARE FOOT (ASD)
MPH = MILES PER HOUR (VULT)

VISIT [ECALC.IO/WIND](https://ecalc.io/wind)

TO ORDER ENGINEER-CERTIFIED ORIGINALS FOR PERMIT

USE OUR ONLINE CALCULATORS WITH BETTER ANSWERS

HELPFUL EXPLANATIONS & MORE WIND RESOURCES



OR SCAN THIS CODE

DESIGN NOTES

1. DESIGN PRESSURES UTILIZED IN THIS DOCUMENT HAVE BEEN CALCULATED PER ASCE 7-16 METHODOLOGY IN ACCORDANCE WITH THE REQUIREMENTS OF THE FLORIDA BUILDING CODE 7TH EDITION (2020). THESE CALCULATIONS ARE ALSO APPLICABLE FOR THE IBC/IRC (2015 & 2018), AS WELL AS CURRENT VERSIONS OF THE MN, NC, NJ, NY, OH, SC, & VA BUILDING CODES THAT UTILIZE ASCE 7-16 USING DESIGN METHODOLOGY WITH THE CRITERIA AS OUTLINED HEREIN. CODE ENFORCED COMPLIES WITH STATE OF SEAL AND IF MULTIPLE VERSIONS ARE LISTED THEN MOST STRINGENT APPLIES.
2. CALCULATIONS HEREIN ARE LIMITED TO MONOSLOPE OR GABLED ADDITIONS AS SHOWN.
3. TALBES USE VULT 3 SECOND GUST VELOCITIES.
4. TABLES ARE CALCULATED IN CONFORMANCE WITH (ASD) "ALLOWABLE STRESS DESIGN METHODOLOGY" PER IBC (2018) / FBC (2020) SECTION 1605 & ASCE 7-16 SECTION 2.4.1, WITH WIND PRESSURES PER ASCE CHAPTER 30 PART 1, 5 OR 30.11, AND LOADING CONDITIONS USING THE CODES& CRITERIA AS OUTLINED HEREIN.
5. 'WORST CASE' CRITICAL CONDITIONS SHALL BE ASSUMED FOR SAFE PRESSURE RATINGS.
6. TOPOGRAPHIC FACTOR $K_{zt}=1.0$ FOR FLAT TERRAIN USE ONLY. NO HILLS SHALL BE NEARBY AREA.
7. VERIFY USE OF K_d (DIRECTIONALITY FACTOR) WITH LOCAL BUILDING DEPARTMENT, $K_d=0.85$ USED HEREIN. PRESSURES SHALL BE ADJUSTED AS REQUIRED BY USE OF ALTERNATE K_d VALUES.

GENERAL NOTES

8. THIS DOCUMENT IS A MASTER PLAN SHEET, NOT A SITE-SPECIFIC DOCUMENT & DOES NOT PERTAIN TO ANY SPECIFIC RESIDENCE.
9. THIS DOCUMENT IS ONLY VALID WITH AN ORIGINAL SIGNATURE & RAISED SEAL OR DIGITALLY SEALED.
10. THIS DOCUMENT ILLUSTRATES ALLOWABLE DESIGN WIND PRESSURES (ASD) AS LISTED. APPLICATION OF THESE TABLES AND CORRESPONDING WIND VELOCITY (SPEED), EXPOSURE, & OTHER COEFFICIENTS LISTED HEREIN SHALL BE DICTATED AND VERIFIED BY THE GOVERNING BUILDING DEPARTMENT AND PERMIT HOLDER.
11. NO WARRANTY FOR APPLICABILITY OF THE USE OF THESE TABLES IS OFFERED HEREIN.
12. THIS SPECIFICATION DOES NOT OFFER ANY PRODUCT APPROVED CERTIFICATION. REFER TO ANY SEPARATELY SUBMITTED TEST CRITERIA AND OTHER APPROVALS FOR DESIGN & INSTALLATION INFORMATION AND APPLICABILITY OF THESE TABLE VALUES WHICH IS TO BE VERIFIED BY OTHERS IN ACCORDANCE WITH GOVERNING CODES.
13. CONTRACTOR SHALL INVESTIGATE AND CONFORM TO ALL LOCAL BUILDING CODE AMENDMENTS WHICH MAY APPLY.
14. IT IS RECOMMENDED THAT A LICENSED ENGINEER OR REGISTERED ARCHITECT PREPARE SITE SPECIFIC DOCUMENTS FOR USE IN CONJUNCTION WITH THIS DOCUMENT. SEPARATE 'SITE-SPECIFIC' SEALED ENGINEERING IS REQUIRED IN ORDER TO DEVIATE FROM LOADS OR CONFIGURATIONS CONTAINED HEREIN. CONTACT THIS ENGINEER OR A LICENSED PROFESSIONAL FOR ALTERNATE CONFIGURATION CALCULATIONS AS MAY BE REQUIRED.
15. THE CONTRACTOR SHALL CAREFULLY CONSIDER POSSIBLE IMPOSING LOADS ON ROOF, INCLUDING BUT NOT LIMITED TO ANY CONCENTRATED LOADS WHICH MAY JUSTIFY GREATER DESIGN CRITERIA. ADDITIONAL ROOF LOAD CRITERIA SHALL BE PROPERLY ANALYZED BY A PROFESSIONAL ENGINEER. RESULTS ARE WIND ONLY.
16. EXCEPT AS EXPRESSLY PROVIDED HEREIN, NO ADDITIONAL CERTIFICATIONS OR AFFIRMATIONS ARE INTENDED.
17. ALTERATIONS, ADDITIONS OR OTHER MARKINGS TO THIS DOCUMENT ARE NOT PERMITTED AND INVALIDATE OUR CERTIFICATION.

CALCULATION NOTES:

1. INTERPOLATION OF THESE RESULTS ARE NOT PERMITTED WITHOUT SIGNED AND SEALED RESULTS.
2. PRESSURES HEREIN ARE VALID FOR CONDITIONS EQUAL OR LESS THAN THE DESIGN CONDITIONS LISTED. FOR CONDITIONS EXCEEDING THOSE LISTED, VISIT [ECALC.IO/WIND](https://ecalc.io/wind) TO CALCULATE A SITE SPECIFIC PRESSURE
3. TABLES USE ASCE ZONE 2 PRESSURES FOR A ROOF AREA=100FT², AND CANOPY HEIGHT $H_c = 12$ FT, C&C METHOD, FLAT TERRAIN. FOR MORE EXACT ANSWERS USE THE MATCHING ONLINE CALCULATOR AT [ECALC.IO/WIND](https://ecalc.io/wind).

COPIES NOT VALID FOR PERMIT

COPIES NOT VALID FOR PERMIT

DIGITAL SEAL NOTICE:
IF THIS DOCUMENT IS DIGITALLY SIGNED, THIS SHEET IS PART OF A DIGITALLY SIGNED FILE. IT SHALL REMAIN IN DIGITAL FORMAT, SHALL BE VERIFIED BY ELECTRONIC MEANS, & PRINTED COPIES OF THIS DOCUMENT ARE NOT CONSIDERED SIGNED AND SEALED.
PRINTED DOCUMENT NOTICE:
IF THIS DOCUMENT IS PRINTED & DOES NOT CONTAIN AN ENGINEER'S ORIGINAL SIGNATURE & SEAL, THIS DOCUMENT IS VOID & NOT VALID FOR USE. PHOTOCOPIES ARE NOT PERMITTED FOR USE.

ENGINEERING EXPRESS®
CORPORATE OFFICE:
160 SW 12th AVE, SUITE 106
DEERFIELD BEACH, FL 33442
(954) 354-0660 | (866) 396-9999
TEAM@ENGINEERINGEXPRESS.COM
ENGINEERINGEXPRESS.COM

SCREEN WALL INFILL
PARTS, SPANS, & STRUCTURAL DETAILS
MASTER PLAN
FLORIDA BUILDING CODE 7TH ED (2020)
INTERNATIONAL BUILDING CODE (2018)
WIND LOADING PER ASCE 7-16

DRWN	CHKD	DATE
JAC	TSB	7/7/18
COB	FLB	6/01/21

REMARKS
INITIALS
2020 FBC

THIS DOCUMENT IS THE PROPERTY OF ENGINEERING EXPRESS AND SHALL NOT BE REPRODUCED IN WHOLE OR PART WITHOUT WRITTEN CONSENT OF ENGINEERING EXPRESS. ALTERATIONS, ADDITIONS OR OTHER MARKINGS TO THIS DOCUMENT ARE NOT PERMITTED AND INVALIDATE OUR CERTIFICATION.

COPYRIGHT ENGINEERING EXPRESS®

20-35472

SCALE: NTS UNLESS NOTED

3